

## Battery Isolator Installation – 1989 Models Mariner/Mercury/Sea Ray V6 Outboards with 40 Amp Charging System

A battery isolator will allow the charging system to charge both the starting battery and an auxiliary battery at the same time while preventing accessories, connected to the auxiliary battery, from drawing power from the cranking battery.

1. Install the isolator as prescribed by the manufacturer.
2. Locate the 3 stud terminal block on the top rear of the engine. The center stud of this terminal block has 4 RED leads on it. Remove the short, heavy RED lead which exits the voltage regulator/rectifier and extend this lead to connect to the POSITIVE (+) terminal of the battery isolator.

**IMPORTANT:** The lead used to extend the short, heavy RED lead from the voltage regulator/rectifier to the battery isolator should be at least #10 AWG wire. It may be PVC insulation. An additional sleeve protecting this wire at tie straps and where it exits the cowl is mandatory.

3. Connect output terminals of isolator to the batteries with at least #10 AWG wire in accordance to instructions with isolator.

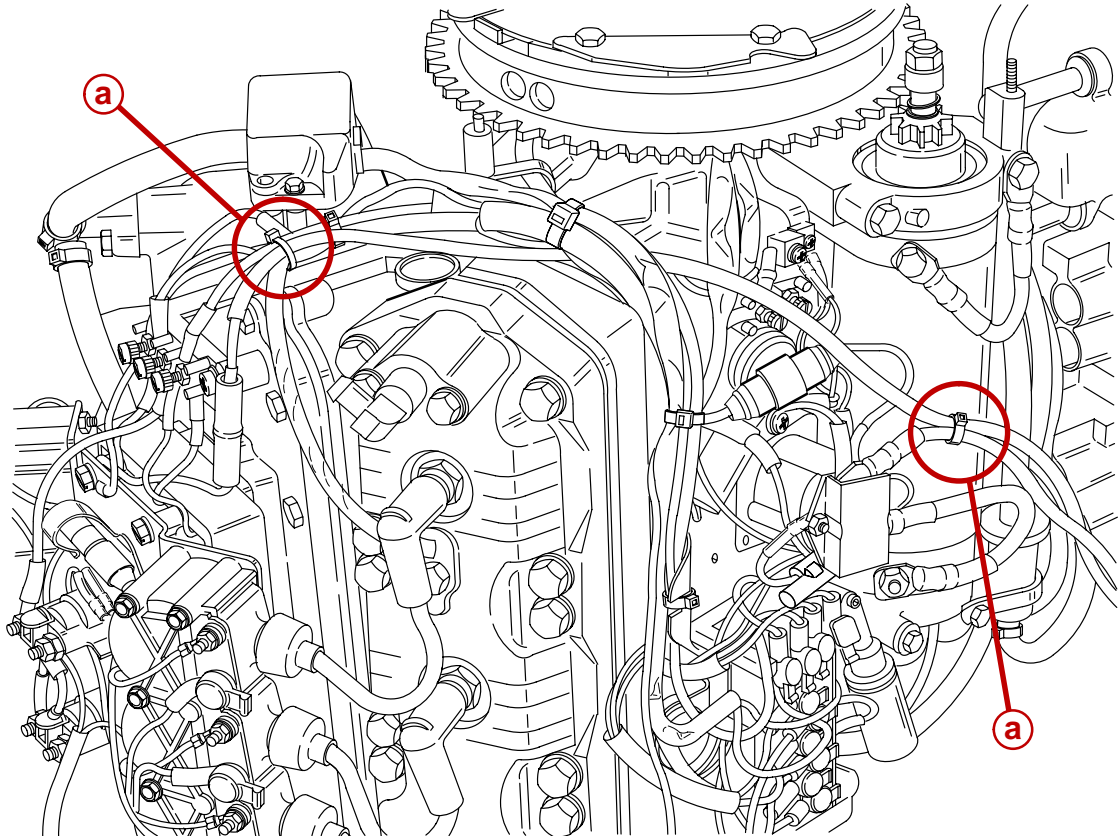

**a** - Tie Strap  
**Figure 1. Wire Routing**

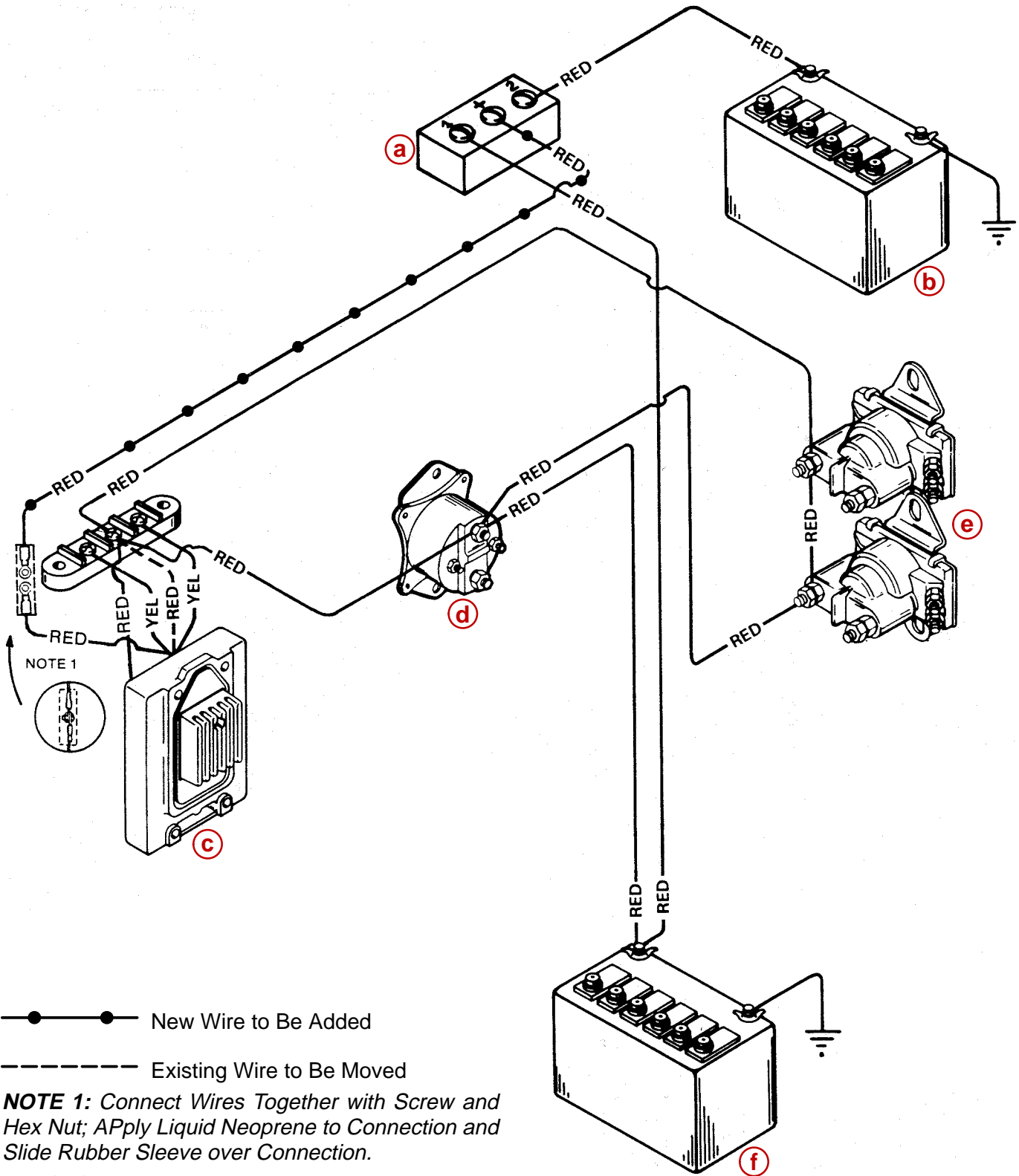

**Battery Isolator with 40 Ampere V-6 Charging System**