



service bulletin

No. 94-10

Power Trim Shaft Not Engaging Sender - 75 thru 125

Mariner and Mercury

Single Ram Power Trim

1992 thru 1994

75 thru 115

US

S/N 0D082000 thru 0G087988

Belgium

S/N 09682500 thru 09841083

1994

125

US

S/N 0D283222 thru 0G087988

Belgium

S/N 09793577 thru 09841083

The power trim upper slotted pivot shaft may not totally engage the power trim gauge sender. The trim gauge may operate for a period of time and then quit.

CORRECTION:

If the pivot shaft does not engage the sender, install the new slotted pivot shaft p/n 99625--1.

or

In an emergency, shim the power trim rod eye over toward the starboard side using the washers listed.

New Slotted Pivot Shaft:

The new pivot shaft p/n 99625--1 is installed on late 1994 75 thru 125 models beginning after the serial numbers listed and supersedes the previous pivot shaft p/n 99625. The new shaft is slightly longer and does not have the chamfer at the outer end of the slot.

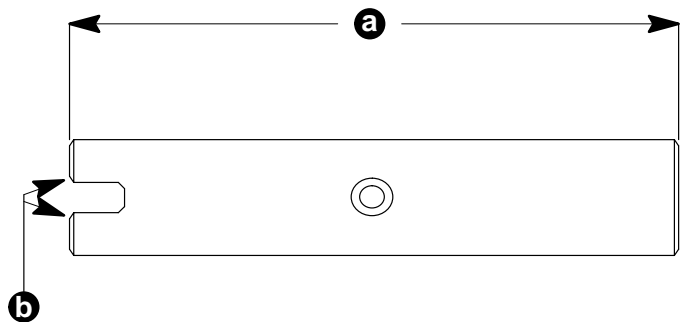

28098

a - Slightly Longer.

b - Chamfer Removed.

Figure 1. 99625--1 Pivot Shaft.

Shim Power Trim Rod Eye:

Remove the cross pin and the upper pivot shaft. Install 0.125 inch (3 mm) washer(s) listed between the port side of the power trim rod eye and the swivel bracket. Reinstall the upper pivot shaft and the cross pin.

Qty. 1 12-846378
.690 X 1.00 X .120 inch
Stainless Steel Washer
(Shipped from Hi-Performance)

or

Qty. 4 12-48526
.630 X 1.00 X .031 inch
Nylon Washer

or

Qty. 4 12-815952
.640 X 1.00 X .031 inch
Stainless Steel Washer

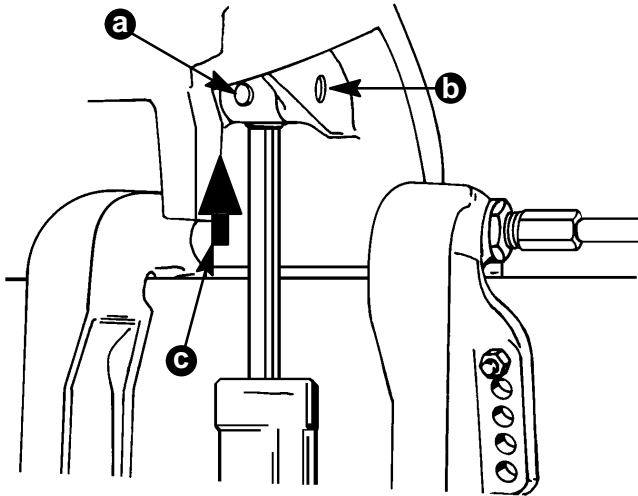

51505

- a - Cross Pin.
- b - Upper Pivot Shaft.
- c - Install Washer(s).

Figure 2. Shim Washer Location.

WARRANTY:

Complete a warranty claim listing:

Outboard serial number.

Quantity and part number of part(s) used.

One half (0.5) hour labor.

Warranty Labor Rate Code - NJC.

Failure Code 112 - 00.