

## Adapter Plate Improvements - 3.0 Litre V6

### Models Affected

#### MARINER AND MERCURY

1994 thru 1996, 3.0 Litre V6  
S/N 0D280813 thru 0G437999

There have been two changes to the exhaust adapter plate. These product improvements are to address the two conditions listed below. A poorly maintained cooling system will aggravate these conditions. Before continuing with any changes to the adapter plate make sure the cooling system is clean and in good operating condition.

### Condition 1

Idle exhaust boot melting, and/or cracking of the exhaust adapter plate. First indication of this condition is a louder exhaust noise at idle speed.

### INSPECTION

If condition 1 is suspected, inspect the idle exhaust boot for a charred or burned appearance. If burned, remove exhaust boot from the adapter plate and inspect for a crack in the adapter plate.

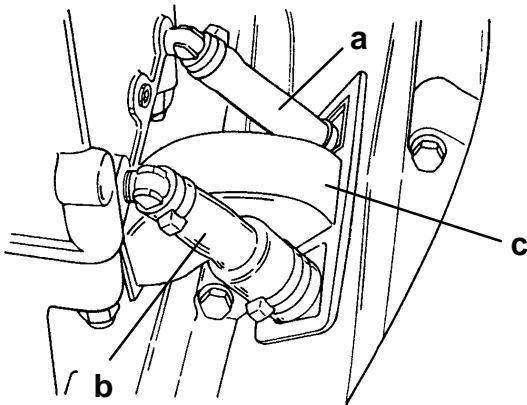

- a - Tell-Tale Hose
- b - Flush Hose
- c - Idle Exhaust Boot

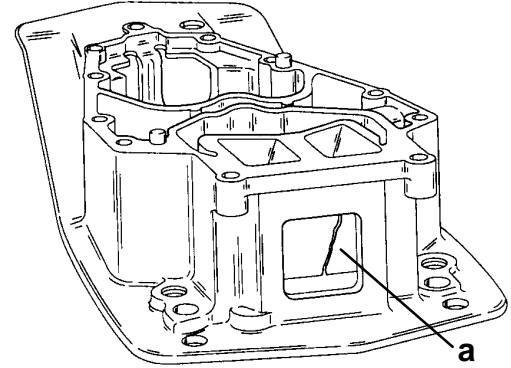

a - Crack In Exhaust Adapter Plate

### CORRECTION

If the idle exhaust boot is burned, an Exhaust Adapter Plate Cooling Kit (850435A1) should be installed. If the exhaust plate is cracked, it should be replaced with a new Adapter Plate (818450A2) and an Exhaust Adapter Plate Cooling Kit (850435A1). The cooling kit will take water from the tell tale discharge hose and direct it into the rear chamber of the adapter plate, lowering the temperature of the plate and exhaust boot.

**NOTE:** Idle exhaust boot can be glued into adapter plate using 3M product #3M08155 (obtain locally).

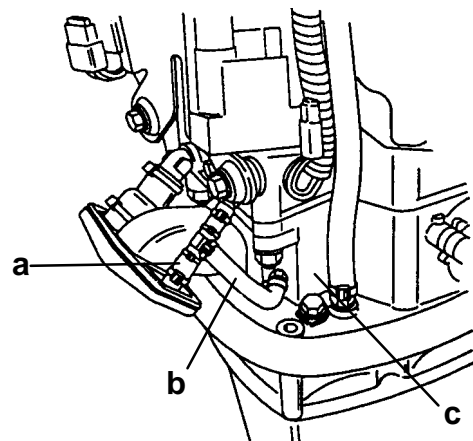

- a - Tell-Tale Hose
- b - Cooling Kit Hose
- c - Exhaust Adapter Plate

## Condition 2

Plugged water discharge holes in adapter plate. This condition should be suspected when the customer reports repeated failures of the propeller hub within a short period of time, or if the bearing carrier seals look charred or burned.

### INSPECTION

The exhaust gases that exit the engine are cooled by water that enters the exhaust system at the adapter plate. If condition 2 is suspected it is likely that the water discharge holes are blocked with debris. To inspect discharge holes first remove the lower unit. Then using a light, look up the exhaust tube. If the two discharge holes are blocked they must be cleared. In most cases it is not necessary to remove the powerhead to clear the discharge holes.

### CORRECTION

Exhaust system water discharge holes in most cases can be cleared by using a # 39 (2.5mm) drill bit on the end of a 2 ft. long 3/8" dia. iron rod. A hole can be drilled into the end of the rod using a #39 drill bit. Then install the #39 drill bit into the hole drilled in the rod. Drill bit can be retained into rod by brazing or with a set screw. Using the rod/drill bit assembly go up through the exhaust tube and clear out debris from discharge holes. Then flush out the cooling system as outlined in the Operation and Maintenance Manual. Regular flushing of the cooling system will help keep the discharge holes clear.

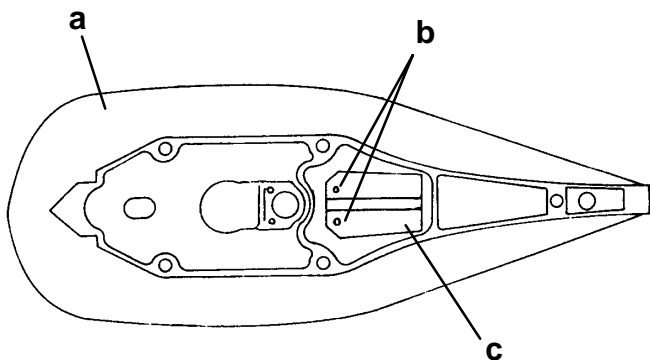

- a - Bottom View Driveshaft Housing
- b - Water Discharge Holes
- c - Exhaust Tube

If regular flushing of cooling system fails to keep holes clear, it is recommended to install a new Adapter Plate (818450A2), that has strainer screens installed above the discharge holes to prevent blockage.

**NOTE:** Strainer screens can not be added to existing adapter plate due to a casting change.

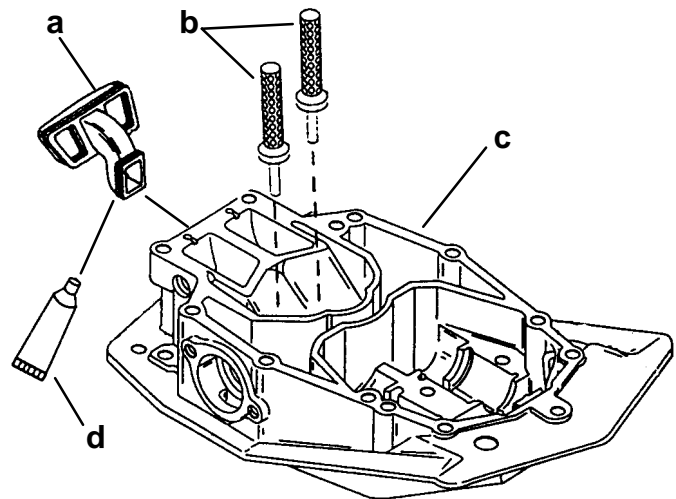

- a - Idle Exhaust Boot
- b - Strainer Screens (Water Discharge)
- c - Exhaust Adapter Plate
- d - Glue (3M #3M08155, obtain locally)

## Warranty

The above two conditions will be covered by a special warranty for two (2) years from the date of sale to the original owner to assure customer satisfaction.

### EXHAUST BOOT BURNING ONLY

Complete warranty claim listing.

- Exhaust Adapter Plate Cooling Kit (850435A1)
- Idle Exhaust Boot (821255)
- One (1.0) hour labor
- Flat rate code NJC, Failure code 501-00

### ADAPTER PLATE REPLACEMENT

Complete warranty claim listing.

- Exhaust Adapter Plate Cooling Kit (850435A1)
- Adapter plate (818450A2)
- Two and one half (2.5) hours labor
- Flat rate code OP55 & OD21, Failure code 509-00

### CLEANING ADAPTER PLATE DRAIN HOLES

Complete warranty claim listing.

- One and one half (1.5) hours labor
- Flat rate code NJC, Failure code 509-00

### US and CANADA

Complete/process claim via Midas or return warranty claim form. Tag and hold parts (adapter plate replacement only) for 60 days after credit is received.

### INTERNATIONAL

Follow instructions issued by Marine Power International office or by your distributor.