

Manual Venting Fuel Tank Conversion - Plastic 6.6 Gallon Tank

Models Affected

PLASTIC 6.6 GALLON (25 L) FUEL TANK P/N 1265-826174A1

In response to our customers requests, Mercury Marine will revert back to a manual venting fuel tank and eliminate the auto-venting system. As a running change, a manual venting fuel tank will be used in place of a auto-venting fuel tank. This applies to fuel tanks that are shipped with outboards, as well as tanks supplied from Mercury Marine Precision Parts. Additionally, a manual venting fuel tank conversion kit (p/n 850763A1) will supersede both the non-venting fuel tank cap and the auto-venting fuel pick-up assembly.

Parts Interchangeability

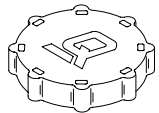
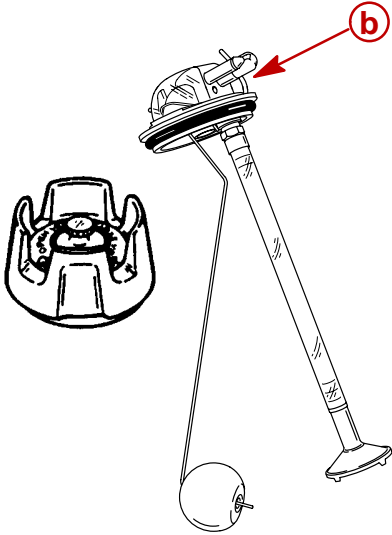
Previous Part	Supersedes to	New Part
1265-826174A1 6.6 Gallon Fuel Tank (Auto-Venting)	➔	1265-850750A1 6.6 Gallon Fuel Tank (Manual Venting)
36-826175A1 Non-Venting Fuel Cap (Ratcheting)	} ➔	850763A1 Kit Manual Venting Fuel Cap (Non-Ratcheting) & Non-Venting Fuel Pick-Up b - Hole Only, No Check Valve
826176A1 Auto-Venting Fuel Pick-Up a - Auto-Vent Check Valve		
		

Parts Required

Part No.	Description	Qty.
850763A1	Cap & Pick-Up Kit (Manual Vent)	1

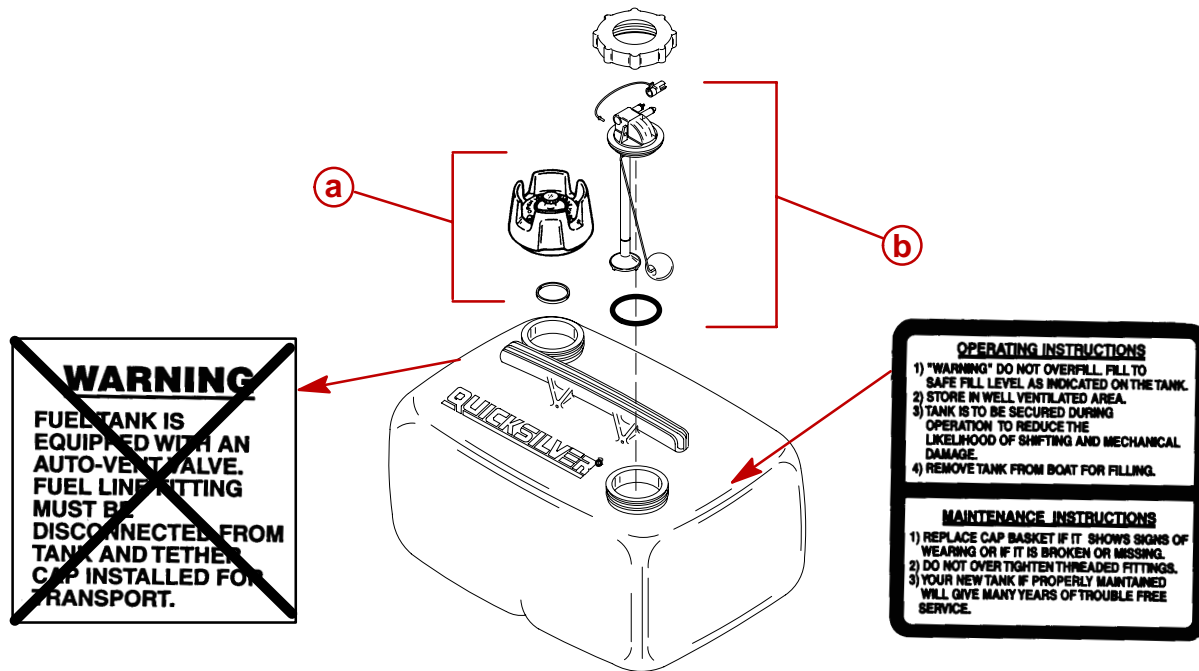

a - Manual Venting Fuel Cap (Non-Ratcheting)
 b - Fuel Pick-Up (Non-Venting)

Conversion Procedure

1. Replace fuel cap/fuel pick-up as a set using components from Cap & Pick-Up Kit (P/N 850763A1).
2. Remove WARNING decal referring to Auto-Vent system. The OPERATING INSTRUCTIONS/MAINTENANCE INSTRUCTIONS decal MUST remain in place and be followed.

Fuel Tank Usage (Manual Venting)

IMPORTANT: Refer to the Outboard Operation & Maintenance Manual for fuel tank operation, transportation and fuel related warning information.

1. Close fuel tank air vent on cap when transporting tank. This will prevent the escape of fuel or vapor from tank.
2. Install tether cap over the fuel line connector stem. This will protect the connector stem from being accidentally pushed in, thus, allowing fuel or vapor to escape.
3. DO NOT fill fuel tank past the "SAFE FILL LEVEL" line shown on the end of the tank.
4. When placing fuel tank in boat, the vent should be positioned toward the bow to avoid fuel spillage from the vent during acceleration or boat planing.

Warranty

The manual venting fuel tank with non-ratcheting cap is offered as a product feature change. Converting from a auto-venting system to a manual venting system is not covered by warranty.