

## Ground - Ignition Plate

### Models Affected

Force 75, 90 & 120 HP - 1996 thru 1998  
Serial Number - 0E138600 thru 0E329500

Sport Jet 95XR/120XR - 1996 thru 1998  
Serial Number - 0E141089 thru 0E329500

A poor ground connection from the ignition components plate to the engine block can cause a voltage regulator and/or multiple CDM failures.

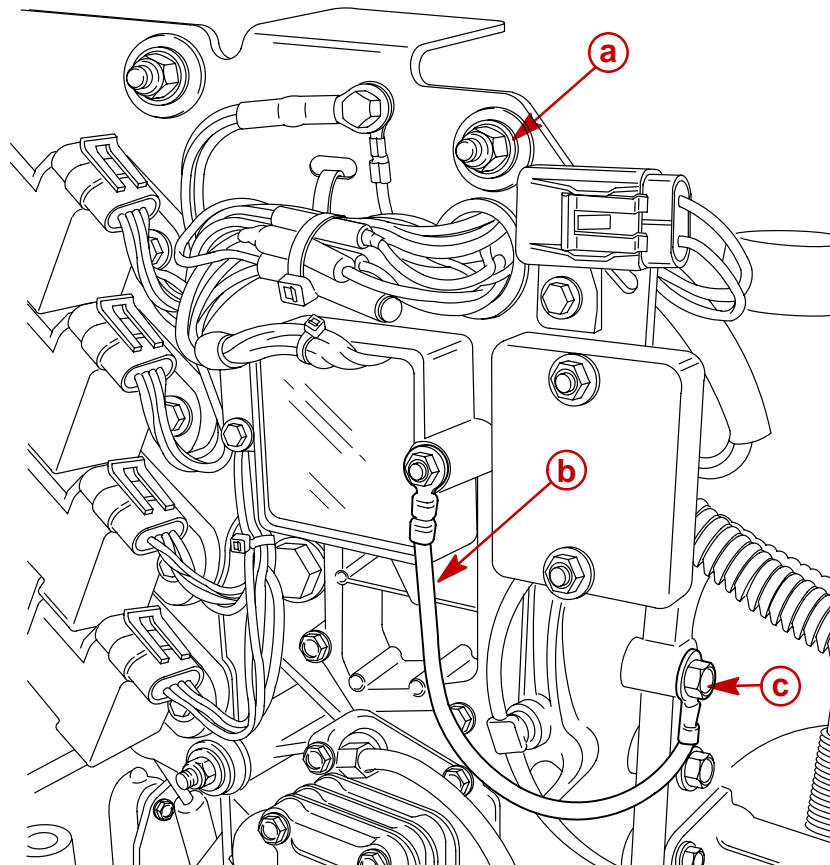

- a** - Old Ground Connection
- b** - New Ground Wire
- c** - New Ground Connection

57211

## Dealer Inventory

The outboards in dealer inventory within the serial number range should be checked and reworked, if necessary, prior to delivery to customer.

## Correction

To ensure a good ground connection, a new ground wire and routing has been developed. This was incorporated as a running change during the 1998 model year and can be applied to the engines within the serial number range listed above. The figure below indicates the proper routing of the ground wire.

## Parts Required

The part number of the ground wire is: 84-856583A1

**IMPORTANT: Remove the original ground wire (voltage regulator to ignition component plate stud) before attaching the new ground wire. This ensures proper thread engagement of the screw.**

This is not a rework campaign. The installation of the new ground wire is recommended to be installed when an engine within the serial number range is being serviced. The warranty coverage for this installation applies to engines still within the warranty period. Any engines that are out of the warranty period will not be covered.

## Warranty

Complete a warranty claim listing:

- Outboard serial number(s)
- Qty 1 p/n 84-856583A1 Wire
- One half (0.5) hour labor
- Warranty Flat Rate Code: NJC
- Failure Code: 330-17