

**MERCURY**

**MARINER**

**MERCURY**  
Sport Jet

**FORCE**  
Outboards

# service information

ADVISORY

BULLETIN

No. 99-10

## Tilt Release – Big Foot 50 (4S) & 60 (2S)

### Models Affected

MERCURY/MARINER  
1998/1999

50 (4 Stroke) Big Foot  
Serial Number  
USA 0G590000 thru 0G821732

60 (2 Stroke) Big Foot  
Serial Number  
USA 0G590000 thru 0G831375  
Belgium 09973100 thru 0P040441

Some customers with big foot models have become concerned when they can easily push their unit down by hand from the full tilt position. This is usually experienced on dry land while cleaning or servicing. The design of the power trim allows this to occur mostly due to the geometry of the tilt system, internal valving, and the additional weight of the big foot gear-case. Complete power trim units have been replaced in an attempt to “fix” the problem, without success. The power trim is operating as designed.

Outboards after the serial numbers listed have the new stronger power trim tilt release spring p/n 24-804849 to prevent the “easy tilt down” from occurring as a product improvement. Customers may have the new inexpensive tilt release spring installed, at their own expense, if they desire. Labor to install the new spring is approximately one hour.

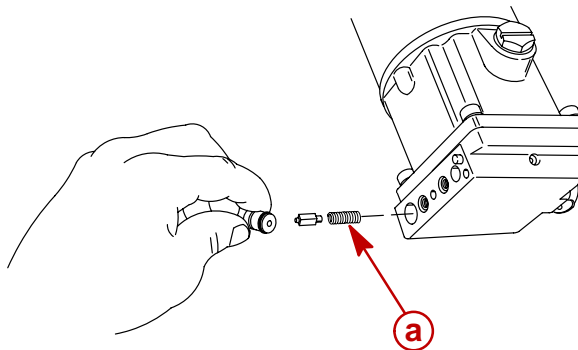

**Power Trim with Cylinder Removed**

**a** - Tilt Release Spring

## **TILT RELEASE**

---

The tilt relief spring color is also changed from the previous plain steel (dark) color to the new silver (galvanized) color. The new spring is also contained in the Trim Limit Valve Kits 809873A2 with date on or after 27 Aug 98.

As this “easy tilt down from the full tilt position” exists, the power trim is required to hold it’s position when the outboard is operated in the water below 1800 rpm for shallow water operation. If it does not, further troubleshooting investigation of the power trim unit is required.

## **CORRECTION**

Replace the existing dark colored tilt release spring in the power trim manifold with a new silver spring p/n 24-804849.

## **WARRANTY**

The tilt release spring is offered as a product improvement on 1999 models. Warranty will not cover the up-grade of previous models.