



Service Bulletin

Bulletin No. 2010-06
OEM No. 2010-05

Circulate to: Sales Manager Accounting Service Manager Technician Parts Manager

Mercury Flo-Torq Reflex Hub System

Models Affected

Models Covered	Serial Number Or Year
40-60 HP FourStroke (standard gearcase)	
30 HP FourStroke	0G760300-1B226999 1C109093 and above
30-60 HP 2-Stroke (standard gearcase)	1977 and newer
25 HP FourStroke BigFoot	
55 HP Marathon/Sea Pro	

Situation

Mercury Marine is pleased to announce the Flo-Torq Reflex propeller hub systems for 40-60 HP standard gearcase engines. The Flo-Torq Reflex hub system is designed to eliminate clutch rattle and reduce vibration, especially in FourStroke applications.

To accept the Reflex hub system, the hub of the propeller was redesigned. Propellers with the Flo-Torq I rubber hub installed will become no longer available (NLA), and will be superseded to a propeller that includes the Reflex hub system. Rubber hubs will continue to be available as a service part. Propellers that currently have a rubber hub installed cannot accept the Reflex hub system.

THE INFORMATION IN THIS DOCUMENT IS CONFIDENTIAL AND PROTECTED BY COPYRIGHT AND IS THE PROPERTY OF MERCURY MARINE.

This document is provided for the sole and exclusive use of the original recipient as prescribed by Mercury Marine and may not be distributed or copied, digitally or otherwise, without the prior written consent of Mercury Marine.

Parts Contained in Kit

NOTE: When installing a propeller with the Reflex hub system, be sure to use the installation hardware provided with the propeller and assemble per the included instructions. Use of the incorrect or older style mounting hardware will result in the propeller not being centered on the propeller shaft.

Due to the changes in propeller hub systems, propeller hardware will no longer be included with 40–60 HP FourStroke outboards. Dealers consuming inventory of rubber hub propellers will need propeller nut kit #11-31990Q02 to complete the installation of a rubber hub propeller.

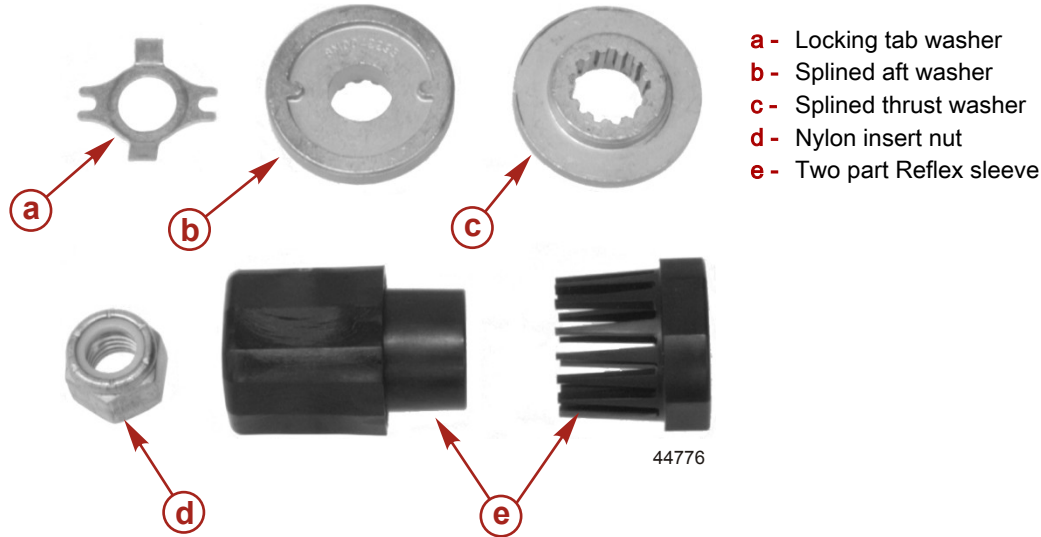

Mercury Flo-Torq Reflex Supersession Chart

Aluminum	Mercury Rubber Hub Part Number	Mercury Reflex Part Number
12.5 x 8P Cup	48-42738A13	48-42738CP1
12.5 x 8P	48-42738A11	48-42738A45
12.25 x 9P	48-87818A11	48-87818A45
11.25 x 10P	48-73132A40	48-73132A45
11.625 x 10.5P	48-827312A11	48-827312A45
12 x 10.5P	48-42740A11	48-42740A45
10.875 x 11P	48-85632A40	48-85632A45
10.75 x 12P	48-816702A40	48-816702A45
10.625 x 12P	48-73134A40	48-73134A45
10.375 x 13P	48-73136A40	48-73136A45
10.5 x 13P	48-816704A40	48-816704A45
10.375 x 14P	48-816706A40	48-816706A45
10.25 x 14P	48-73138A40	48-73138A45
10.125 x 15P	48-73140A40	48-73140A45
10 x 16P	48-73142A40	48-73142A45
10 x 17P	48-73144A40	48-73144A45
10 x 19P	48-73146A40	48-73146A45
Stainless Steel	Mercury Rubber Hub Part Number	Mercury Reflex Part Number
12.25 x 9P	48-97868A10	48-97868A46

THE INFORMATION IN THIS DOCUMENT IS CONFIDENTIAL AND PROTECTED BY COPYRIGHT AND IS THE PROPERTY OF MERCURY MARINE.

This document is provided for the sole and exclusive use of the original recipient as prescribed by Mercury Marine and may not be distributed or copied, digitally or otherwise, without the prior written consent of Mercury Marine.

Stainless Steel	Mercury Rubber Hub Part Number	Mercury Reflex Part Number
11.625 x 11P	48-823478A5	48-823478A46
11 x 12P	48-855856A5	48-855856A46
10.5 x 13P	48-855858A5	48-855858A46
10.375 x 14P	48-855860A5	48-855860A46
10.25 x 15P	48-855862A5	48-855862A46
10.675 x 12P	48-878612A40	48-878612A46
10.675 x 13P	48-878614A40	48-878614A46
10.675 x 14P	48-878616A40	48-878616A46
10.675 x 15P	48-878618A40	48-878618A46

Quicksilver Flo-Torq Reflex Supersession Chart

Aluminum	Mercury Rubber Hub Part Number	Mercury Reflex Part Number
12.5 x 8P	QA2060R	QA2060X
12.25 x 9P	QA2062R	QA2062X
11.25 x 10P	QA2064R	QA2064X
11.625 x 10.5P	QA2068R	QA2068X
12 x 10.5P	QA2066R	QA2066X
10.875 x 11P	QA2070R	QA2070X
10.75 x 12P	QA2072R	QA2072X
10.625 x 12P	QA2074R	QA2074X
10.375 x 13P	QA2078R	QA2078X
10.5 x 13P	QA2076R	QA2076X
10.375 x 14P	QA2080R	QA2080X
10.25 x 14P	QA2082R	QA2082X
10.125 x 15P	QA2084R	QA2084X
10 x 17P	QA2088R	QA2088X

Stainless Steel	Mercury Rubber Hub Part Number	Mercury Reflex Part Number
11 x 12P	QS5164R	QS5164X
10.5 x 13P	QS5166R	QS5166X
10.375 x 14P	QS5168R	QS5168X
10.25 x 15P	QS5170R	QS5170X

THE INFORMATION IN THIS DOCUMENT IS CONFIDENTIAL AND PROTECTED BY COPYRIGHT AND IS THE PROPERTY OF MERCURY MARINE.

This document is provided for the sole and exclusive use of the original recipient as prescribed by Mercury Marine and may not be distributed or copied, digitally or otherwise, without the prior written consent of Mercury Marine.