

Circulate to:     Sales Manager     Accounting     Service Manager     Technician     Parts Manager

## Official Recall Notification U.S. Federal Boat Safety Act

# Verado Steering Head Screw Torque Inspection

## Models Affected

Models Covered	Serial Number Range
L6 Verado 200–350	2B403255–2B443388

**NOTE:** Refer to the serial number table at the end of this bulletin to verify that the engine is affected.

## Scope

Worldwide

## Situation

The steering head fasteners may not have had the correct torque applied to them. This could lead to compromised steering performance which may lead to difficulty maintaining desired boat heading, and limitation and/or loss of boat control. The affected engines need to have the torque checked on the steering head screws. If insufficient torque is found, the fasteners need to be tightened to the proper torque of 122 Nm (90 lb-ft).

## Correction

The engine must be mounted on a boat or on an engine stand for this procedure.

1. Tilt the engine to its maximum tilt, leave the tilt lock disengaged for easy access to the steering head screws.

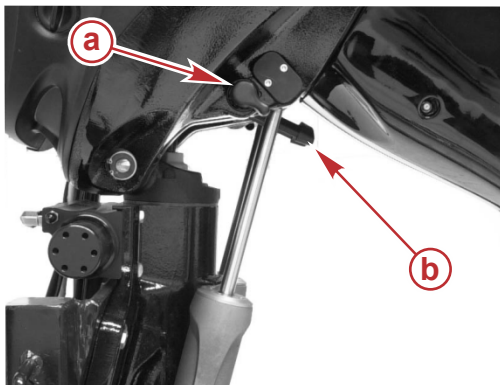

- a** - Tilt lock lever disengaged
- b** - Tilt lock bracket disengaged

63385

2. Check the torque on the rear steering head screws. The steering head screws are tightened at the factory to the proper torque in pairs across from each other.

**IMPORTANT:** If any of the rear steering head screws are not at the correct torque, all of the steering head screws must be properly tightened to the specified torque.

THE INFORMATION IN THIS DOCUMENT IS CONFIDENTIAL AND PROTECTED BY COPYRIGHT AND IS THE PROPERTY OF MERCURY MARINE.

This document is provided for the sole and exclusive use of the original recipient as prescribed by Mercury Marine and may not be distributed or copied, digitally or otherwise, without the prior written consent of Mercury Marine.

## Verado Steering Head Screw Torque Inspection

**NOTE:** If the rear four steering head screws are found to be tightened to the proper torque and not loose, then there is no need to check the front two steering head screws.

Description	Nm	lb-in.	lb-ft
Steering head screw	122	-	90

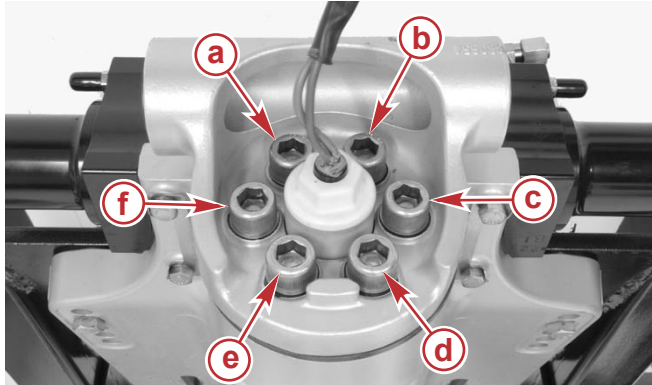

63391

The pedestal and tilt pin have been removed to show clarity

- a** - Front steering head screw
- b** - Front steering head screw
- c** - Rear steering head screw
- d** - Rear steering head screw
- e** - Rear steering head screw
- f** - Rear steering head screw

(a)-(d)	Torque pair
(b)-(e)	Torque pair
(c)-(f)	Torque pair

- To be able to gain access to the front two steering head screws, a modification to a 12 mm hex tool must be made or obtained from Mercury to be able to clear the tilt tube.

**NOTE:** Access to the front steering head screws is limited due to interference with the tilt pin.

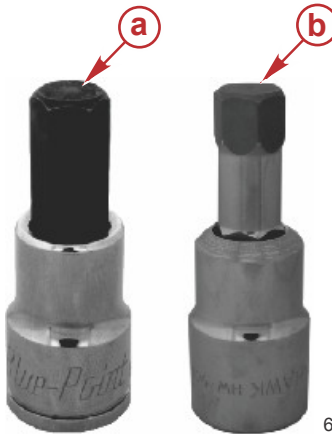

63409

- a** - Standard 12 mm hex tool
- b** - Modified 12 mm hex tool

THE INFORMATION IN THIS DOCUMENT IS CONFIDENTIAL AND PROTECTED BY COPYRIGHT AND IS THE PROPERTY OF MERCURY MARINE.

This document is provided for the sole and exclusive use of the original recipient as prescribed by Mercury Marine and may not be distributed or copied, digitally or otherwise, without the prior written consent of Mercury Marine.

4. The middle of the hex tool needs to be ground down to clear the tilt tube.

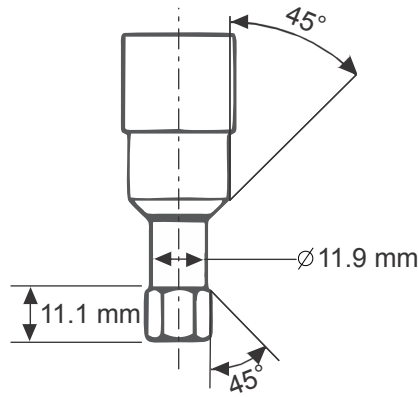

63430

The following image shows the modified 12 mm hex tool with a 1/2" drive torque wrench. The modified 12 mm hex tool is inserted in a front steering head screw and clears the tilt tube.

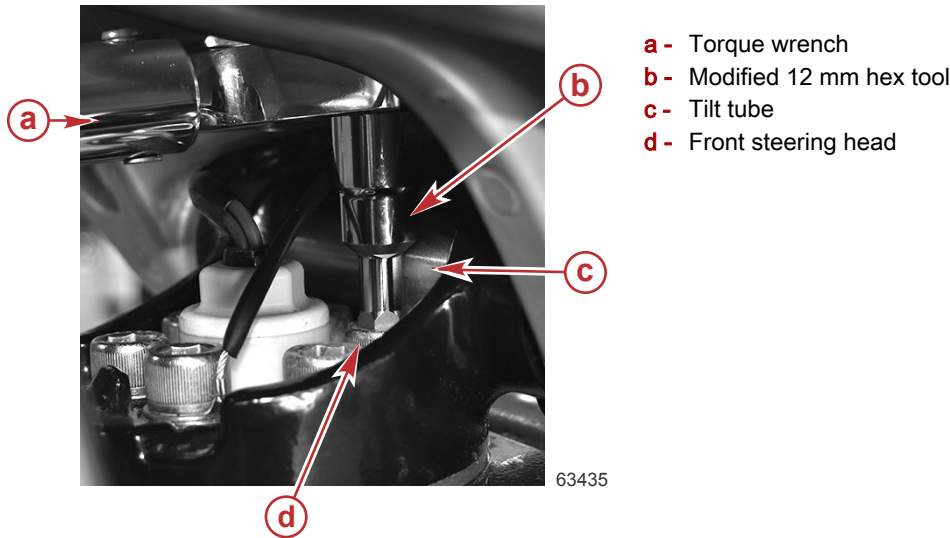

63435

## Owner Notification

A letter will be sent to every registered owner of a potentially affected outboard. The letter will advise the owner to take their outboard to any Mercury Marine authorized dealer for inspection or repair. Visit MercNET, contact Mercury Marine customer service, or your regional service center to determine whether repairs on a specific outboard within the affected serial number range has been completed. As a Mercury Marine dealer, you should contact known affected customers to advise them of this recall and schedule an appointment for the repair. A copy of the customer letter is attached.

## Parts Required

Qty.	Description	Part Number
1	12 mm hex tool	8M0132058

## Warranty

**United States and Canada:** Mercury Marine will credit the dealer for the cost of labor and parts. Submit a warranty claim through your normal warranty-processing channel, listing:

- Engine serial number
- Labor: 0.5 hour
- Warranty flat rate code: SB05
- Part code: 899

THE INFORMATION IN THIS DOCUMENT IS CONFIDENTIAL AND PROTECTED BY COPYRIGHT AND IS THE PROPERTY OF MERCURY MARINE.

This document is provided for the sole and exclusive use of the original recipient as prescribed by Mercury Marine and may not be distributed or copied, digitally or otherwise, without the prior written consent of Mercury Marine.

## Verado Steering Head Screw Torque Inspection

- Failure code: 03
- Labor: 0.3 hour
- Tool modification labor code: SB03

**Outside the United States and Canada:** Follow the instruction issued by your local office or by your distributor.

## Serial Number List

2B403255	2B404166	2B404762	2B406104	2B407394	2B408771	2B409679	2B410807
2B403257	2B404167	2B404775	2B406130	2B407397	2B408841	2B409769	2B410881
2B403278	2B404171	2B404806	2B406173	2B407399	2B408845	2B409784	2B411002
2B403305	2B404186	2B404812	2B406177	2B407405	2B408929	2B409797	2B411012
2B403314	2B404200	2B404814	2B406178	2B407406	2B408945	2B409799	2B411020
2B403352	2B404202	2B404818	2B406179	2B407511	2B408950	2B409801	2B411043
2B403368	2B404203	2B404824	2B406320	2B407529	2B408980	2B409806	2B411074
2B403364	2B404204	2B404825	2B406322	2B407554	2B408989	2B409910	2B411201
2B403371	2B404207	2B404827	2B406323	2B407561	2B409030	2B410118	2B411320
2B403372	2B404210	2B404832	2B406368	2B407571	2B409098	2B410119	2B411327
2B403376	2B404213	2B404903	2B406450	2B407572	2B409099	2B410194	2B411356
2B403499	2B404235	2B404905	2B406468	2B407598	2B409101	2B410205	2B411379
2B403508	2B404266	2B404906	2B406500	2B407697	2B409102	2B410285	2B411380
2B403513	2B404281	2B404907	2B406618	2B407705	2B409105	2B410292	2B411395
2B403515	2B404284	2B404909	2B406626	2B407706	2B409106	2B410296	2B411399
2B403528	2B404286	2B404961	2B406630	2B407710	2B409111	2B410356	2B411467
2B403630	2B404287	2B405115	2B406643	2B407858	2B409113	2B410359	2B411486
2B403631	2B404406	2B405116	2B406645	2B407863	2B409114	2B410478	2B411487
2B403641	2B404410	2B405123	2B406646	2B407880	2B409116	2B410499	2B411528
2B403658	2B404412	2B405242	2B406649	2B407890	2B409117	2B410509	2B411594
2B403700	2B404414	2B405316	2B406751	2B407895	2B409119	2B410597	2B411912
2B403816	2B404488	2B405327	2B406752	2B407913	2B409132	2B410601	2B411914
2B403818	2B404492	2B405330	2B406798	2B408004	2B409244	2B410608	2B411936
2B403832	2B404506	2B405366	2B406908	2B408035	2B409251	2B410622	2B411940
2B403842	2B404550	2B405496	2B406921	2B408129	2B409254	2B410642	2B411975
2B403856	2B404561	2B405637	2B406922	2B408137	2B409310	2B410649	2B412037
2B403882	2B404572	2B405838	2B406932	2B408143	2B409315	2B410653	2B412190
2B403883	2B404586	2B405856	2B406955	2B408201	2B409316	2B410663	2B412197
2B403887	2B404605	2B405866	2B407144	2B408214	2B409432	2B410664	2B412199
2B404068	2B404612	2B405867	2B407268	2B408260	2B409444	2B410745	2B412200
2B404072	2B404613	2B405872	2B407305	2B408359	2B409447	2B410758	2B412201
2B404074	2B404626	2B405881	2B407309	2B408384	2B409449	2B410775	2B412211
2B404076	2B404655	2B405896	2B407310	2B408446	2B409483	2B410784	2B412238
2B404081	2B404665	2B406050	2B407381	2B408459	2B409491	2B410803	2B412359
2B404086	2B404666	2B406057	2B407387	2B408692	2B409502	2B410805	2B412372

THE INFORMATION IN THIS DOCUMENT IS CONFIDENTIAL AND PROTECTED BY COPYRIGHT AND IS THE PROPERTY OF MERCURY MARINE.

This document is provided for the sole and exclusive use of the original recipient as prescribed by Mercury Marine and may not be distributed or copied, digitally or otherwise, without the prior written consent of Mercury Marine.

2B412678	2B414846	2B416048	2B417298	2B418976	2B420905	2B443083
2B412690	2B414900	2B416086	2B417345	2B419002	2B420937	2B443318
2B412691	2B414905	2B416093	2B417434	2B419070	2B420970	2B443357
2B412776	2B415002	2B416094	2B417495	2B419451	2B421071	2B443379
2B412802	2B415007	2B416123	2B417501	2B419513	2B421073	2B443388
2B412836	2B415012	2B416133	2B417735	2B419517	2B421393	
2B412839	2B415013	2B416290	2B417832	2B419540	2B421399	
2B412848	2B415064	2B416309	2B417890	2B419545	2B421403	
2B413191	2B415082	2B416312	2B418079	2B419546	2B421433	
2B413207	2B415083	2B416497	2B418091	2B419565	2B421451	
2B413222	2B415107	2B416512	2B418098	2B419739	2B421535	
2B413227	2B415204	2B416528	2B418127	2B419803	2B421570	
2B413239	2B415207	2B416597	2B418141	2B419808	2B421613	
2B413243	2B415283	2B416603	2B418128	2B419817	2B421618	
2B413374	2B415329	2B416683	2B418129	2B419850	2B421717	
2B413632	2B415349	2B416684	2B418131	2B419852	2B421730	
2B413703	2B415356	2B416823	2B418139	2B420020	2B421740	
2B413710	2B415361	2B416824	2B418158	2B420015	2B421767	
2B413750	2B415396	2B416828	2B418159	2B420101	2B421817	
2B413968	2B415415	2B416870	2B418162	2B420106	2B421885	
2B414055	2B415522	2B416940	2B418245	2B420125	2B421893	
2B414094	2B415613	2B416941	2B418262	2B420131	2B421966	
2B414427	2B415631	2B416943	2B418264	2B420337	2B422067	
2B414429	2B415633	2B416944	2B418267	2B420339	2B422385	
2B414473	2B415741	2B416945	2B418443	2B420343	2B422454	
2B414477	2B415744	2B416951	2B418452	2B420344	2B422472	
2B414541	2B415745	2B416970	2B418493	2B420345	2B442551	
2B414557	2B415770	2B416989	2B418512	2B420360	2B442563	
2B414560	2B415870	2B416996	2B418654	2B420365	2B442587	
2B414567	2B415888	2B416997	2B418695	2B420540	2B442588	
2B414641	2B415889	2B417171	2B418829	2B420583	2B442678	
2B414716	2B415894	2B417179	2B418831	2B420631	2B442881	
2B414747	2B415899	2B417191	2B418832	2B420877	2B442882	
2B414781	2B415915	2B417205	2B418865	2B420878	2B442891	
2B414809	2B415986	2B417230	2B418924	2B420884	2B442944	
2B414843	2B416020	2B417288	2B418971	2B420892	2B442968	

THE INFORMATION IN THIS DOCUMENT IS CONFIDENTIAL AND PROTECTED BY COPYRIGHT AND IS THE PROPERTY OF MERCURY MARINE.

This document is provided for the sole and exclusive use of the original recipient as prescribed by Mercury Marine and may not be distributed or copied, digitally or otherwise, without the prior written consent of Mercury Marine.

## **NOTICE FOR RECALL UNDER THE U.S FEDERAL BOAT SAFETY ACT**

Dear Mercury Outboard Owner:

Thank you for your purchase of a Mercury Verado outboard engine. Mercury Marine is dedicated to providing superior product reliability and customer satisfaction. As part of our commitment to superior customer satisfaction, we have determined that your outboard must be recalled under the Federal Boat Safety Act so that we can perform an inspection of the steering head screws.

### **What is the condition?**

Mercury Marine has identified a potential issue with the applied torque on your engine's steering head screws. The screws may not have been torqued correctly during manufacturing. This could lead to compromised steering performance which may lead to difficulty maintaining desired boat heading, and limitation and/or loss of boat control.

### **What will Mercury Marine do?**

Mercury will inspect and torque the steering head screws on your engine. We have provided instructions to our dealers on the proper method to inspect and properly torque these steering head screws if needed.

### **What should you do?**

Please contact your Mercury Outboard dealer and mention Outboard Service Bulletin 2017-10 to schedule an appointment to have this inspection and repair performed. Your dealer will be able to determine how long this repair will take.

**Please present this notice to your dealer when you bring your engine in for your service appointment.**

### **What if you have other questions or if you no longer own this engine?**

Please contact your Mercury Outboard dealer or call Mercury Outboard Customer Service at 1-920-929-5040 between 7:30 AM and 5:30 PM CST.

We have sent this notice in the interest of your continued satisfaction with our product, and we sincerely regret any inconvenience this may cause you.

Thank you for boating with Mercury Marine.

Mercury Marine Service