



service bulletin

TO: SERVICE MANAGER TECHNICIANS
PARTS MANAGER

No. 94-5

A. Drive Unit Trim Tab / New Anodic Plate

Models

All Bravo Drives and all Alpha One Generation II drives
Except the (1.98:1 and 2.40:1) Ratio.

Identification

The Zinc Trim Tab with the fin has been replaced with a new style (flat plate) type Aluminum Anode on all 1.50:1 / 1.65:1 and 1.84:1 Alpha One Generation II and Bravo One / Two and Three drives.

The only drives that will have a Trim Tab with a fin will be the **1.98:1** and the **2.40:1**. These drives are used with the 3.0L that does not have power steering and may require a Trim Tab to help Correct steering torque, It will also be used on the 3.0LX package which has power steering.

The Trim Tab used on the 3.0L is made from Aluminum, there will be no more Zinc Anodes used on MerCruiser Product.

Following are examples of the new anodic trim tabs that will be offered for the complete product line and the product that they go on.

**NEW STYLE TRIM TAB ANODES AND THE MODELS
THEY ARE USED ON, INCLUDING THE DRIVE UNIT GEAR RATIOS**

[STANDARD]

**ENGINE: 3.0L /3.0LX
DRIVE: 1.98:1 / 2.40:1
part no. 31640 -- 4**

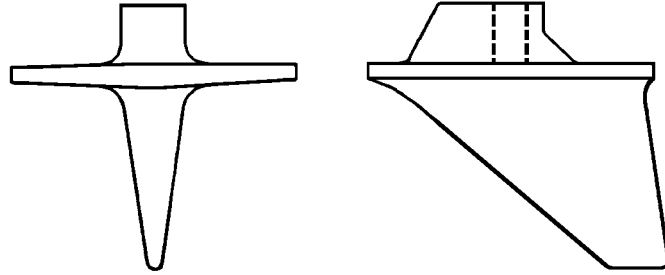

74051

**ENGINE: 4.3LX THRU 502 MAG
ALSO DIESEL 7.3L
DRIVE: ALPHA / ALL BRAVO
part no. 76214A2**

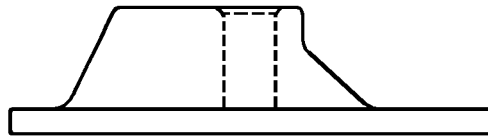

74054

**ENGINE: 5.7L THRU 7.4L
ALSO DIESEL 7.3L
DRIVE: BRAVO THREE
part no. 76214 -- 4**

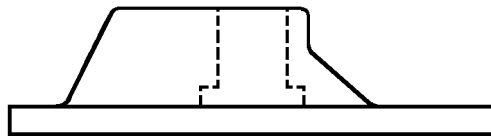

74055

[OPTIONAL]

**ENGINE: 3.0L THRU 502 MAG
DRIVE: ALL ALPHA / BRAVO
part no. 822777A1**

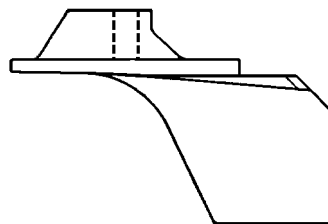

74050