



MerCruiser

service bulletin

- WARRANTY INFORMATION SERVICE INFORMATION
 PARTS INFORMATION

Bulletin No. 2002-04

Circulate to: Sales Manager Accounting Service Manager Technician Parts Manager

▲ = Revised April 2003. This bulletin supersedes the previous bulletin 2002-04 May 2002.

▲Required 496/8.1S Water Rail Parts Replacement

Models Affected

MCM 496 MAG Sterndrive Engines, S/N 0M025000 - 0M095324

MCM 496 MAG HO Sterndrive Engines, S/N 0M025000 - 0M095324

MIE 8.1S Horizon Inboard Engines, S/N 0M025000 - 0M027850

MIE 8.1S HO Inboard Engines, S/N 0M025000 - 0M027850

Any MCM 496 or MIE 8.1S Engine equipped with Water Rails on the exhaust manifold.

NOTE: Not all products in the serial number range given are affected by this fix. Some products may have been updated before they left the factory, or have been updated by the boat builder or another dealer. Dealers on MercNET should first check the product history before starting the repair to verify that the product they are working on still has an open fix program for it.

▲Situation

Under certain circumstances, corrosion to the aluminum water rail may occur at the brass fitting locations. This is more likely to occur when the boat is used in salt water, brackish water, or water with a high mineral content.

THE INFORMATION IN THIS DOCUMENT IS CONFIDENTIAL AND PROTECTED BY COPYRIGHT AND IS THE PROPERTY OF MERCURY MARINE.

This document is provided for the sole and exclusive use of the original recipient as prescribed by Mercury Marine and may not be distributed or copied, digitally or otherwise, without the prior written consent of Mercury Marine.

Inspection and Correction

1. Remove the water rail connector and the hose bib fitting from both water rails on the engine.

NOTE: *There is a loose check ball inside the water rail connector. Be careful not to drop the check ball when removing the water rail connector.*

CAUTION

Failure to reinstall the check ball can result in engine overheating and damage to internal engine components.

2. Inspect the threaded snout of the water rail and the hole in the water rail that held the hose bib fitting for severe damage due to corrosion.
 - On the water rail snout, severe corrosion damage is defined as damage that extends all the way around the snout or more than 1 full thread deep at any one location on either water rail snout.
 - In the hole for the hose bib fitting, severe corrosion damage is defined as damage that leaves less than 3 full undamaged threads.
3. Based on the results of your inspection, proceed as follows:
 - No severe damage found – Water rails should continue to be used. The water rail connector and the brass hose bib fitting must be replaced on both water rails on the engine. Order one Water Rail Connector & Fitting Kit per engine.
 - Severe damage present – Both water rails must be replaced. Order one Water Rail Replacement Kit per engine.

THE INFORMATION IN THIS DOCUMENT IS CONFIDENTIAL AND PROTECTED BY COPYRIGHT AND IS THE PROPERTY OF MERCURY MARINE.

This document is provided for the sole and exclusive use of the original recipient as prescribed by Mercury Marine and may not be distributed or copied, digitally or otherwise, without the prior written consent of Mercury Marine.

Ordering Replacement Kit

Qty 1	P/N 863116A1	Water Rail Connector & Fitting Kit
Qty 1	P/N 862992A1	Water Rail Replacement Kit

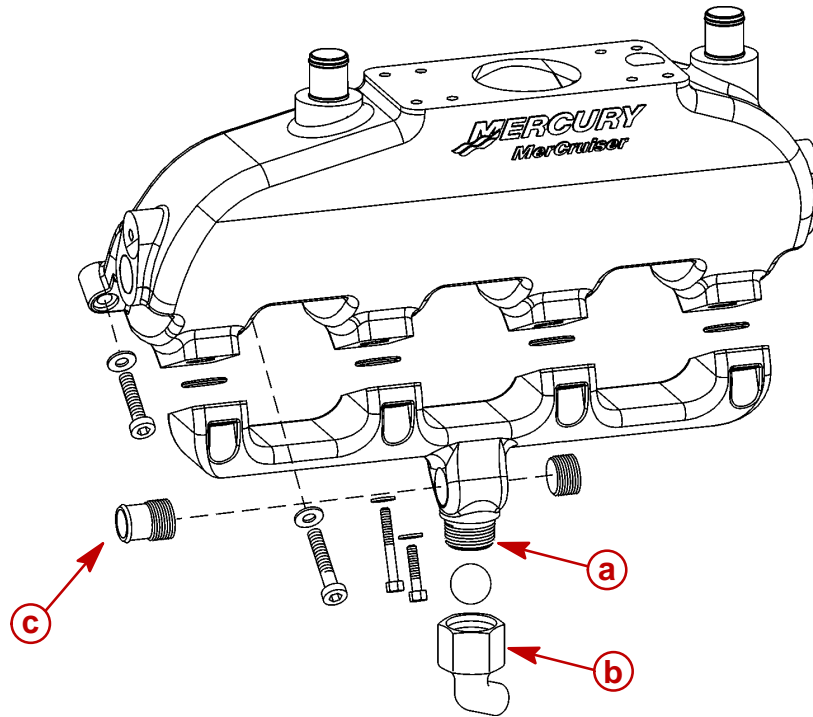

- a** - Water Rail Snout
- b** - Water Rail Connector
- c** - Hose Bib Fitting

▲ Owner Notification

USA and Canada Only: A letter will be sent to the registered owner of the affected Mercury MerCruiser engine. The letter will reference Service Bulletin 2002-04 and will advise the owner to return their boat to the selling dealer, or any authorized Mercury MerCruiser service dealer, for this inspection and replacement of water rail connector and fitting.

THE INFORMATION IN THIS DOCUMENT IS CONFIDENTIAL AND PROTECTED BY COPYRIGHT AND IS THE PROPERTY OF MERCURY MARINE.

This document is provided for the sole and exclusive use of the original recipient as prescribed by Mercury Marine and may not be distributed or copied, digitally or otherwise, without the prior written consent of Mercury Marine.

▲Warranty

Mercury Marine will credit the dealer for the cost of labor through May 31, 2005.

Submit a warranty claim through your normal warranty-processing channel, listing:

- MerCruiser serial number.

For P/N 863116A 1 Water Rail Connector Kit Installation.

- Flat Rate Code and Labor – EXCP 0.5.
- Part Code – 699.
- Failure Code – 40.

For P/N 862992A 1 Water Rail Replacement Kit Installation.

- Flat Rate Code and Labor – EXCP 1.0.
- Part Code – 699.
- Failure Code – 40.

Old Part or Parts:

- **USA and Canada:** Scrap.
- **International:** Follow instructions issued by your Marine Power International office or by your distributor.

THE INFORMATION IN THIS DOCUMENT IS CONFIDENTIAL AND PROTECTED BY COPYRIGHT AND IS THE PROPERTY OF MERCURY MARINE.

This document is provided for the sole and exclusive use of the original recipient as prescribed by Mercury Marine and may not be distributed or copied, digitally or otherwise, without the prior written consent of Mercury Marine.