

## Propeller Mounting Hardware

Beginning with the 1990 model year certain 90, 120 and 150 horsepower outboard and L-Drive models started using a new type gear housing with DUAL EXHAUST. This terminology refers to a combination of snout exhaust (type used on previous models) and thru prop hub exhaust. The new gear housing can be identified by the location of the water intake on each side of the strut. (See Figure 1.)

The previously used SINGLE EXHAUST gear Housing has the water intake located at the prop shaft centerline. (See Figure 2.)

With the introduction of the DUAL EXHAUST gear housing several internal components have changed, including a propeller shaft the requires new propeller mounting hardware. The purpose of this bulletin is to provide information regarding correct usage of propeller mounting hardware for each type of gear housing.

**SERVICE NOTE:** When installing a propeller, the PROP THRUST SPACER should first be placed in the prop hub, then the spacer and prop together should be installed on the prop shaft.

### PROPELLER HARDWARE

#### Dual Exhaust Models - 90 thru 150 HP

- |             |                      |   |
|-------------|----------------------|---|
| 1) 698099-1 | Spacer (Prop Thrust) | Thru Hub Exhaust Props (Except 5H258 & P745)  |
| 2) 744099   | Spacer (Prop Thrust) | 5H258 & P745 Props (Spacer Shipped with Prop) |
| 3) 697299   | Washer (Prop Thrust) | Thru Hub Exhaust Props (Except P744 & P745)   |
| 4) 697140   | Washer (Tab)         | All Thru Prop Exhaust Props                   |
| 5) 7000     | Stop Nut (3/4-16)    | All Thru Prop Exhaust Props                   |

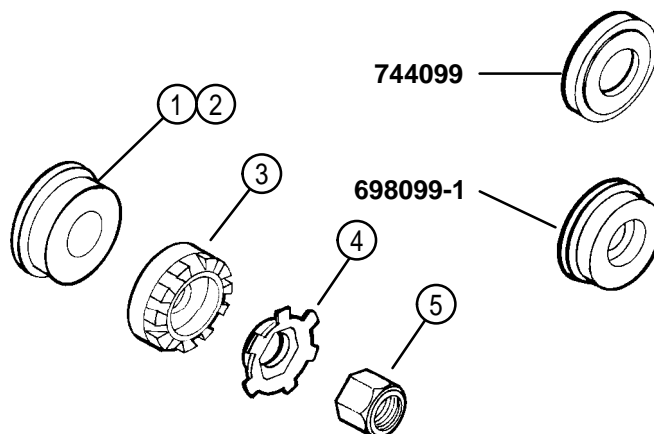
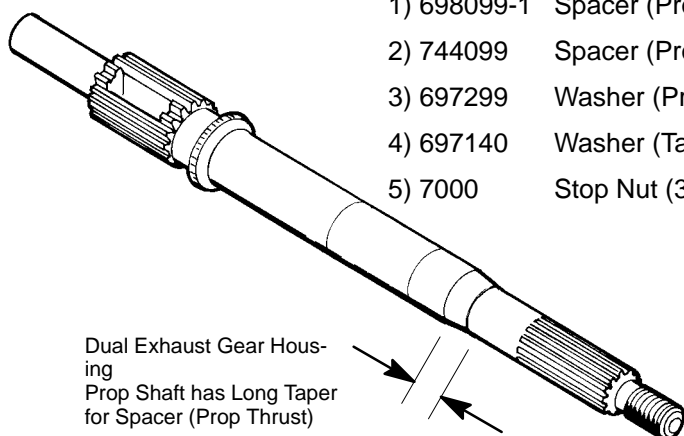
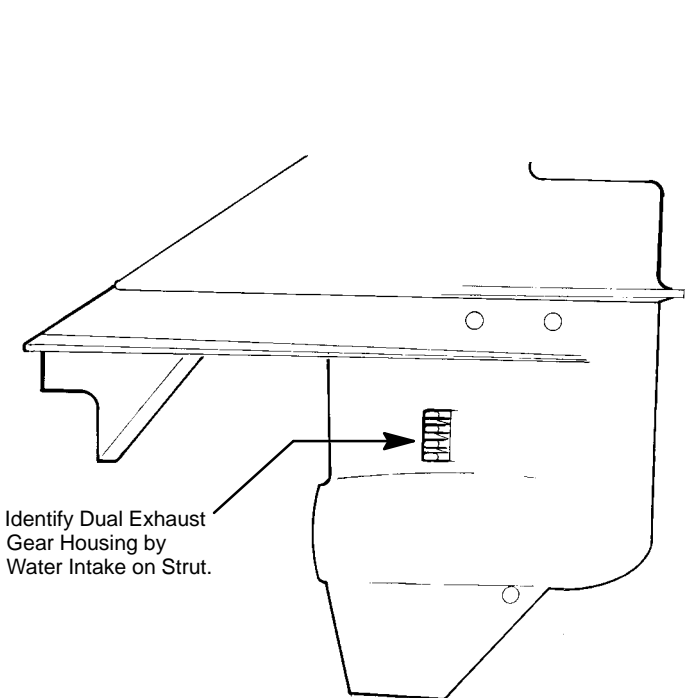
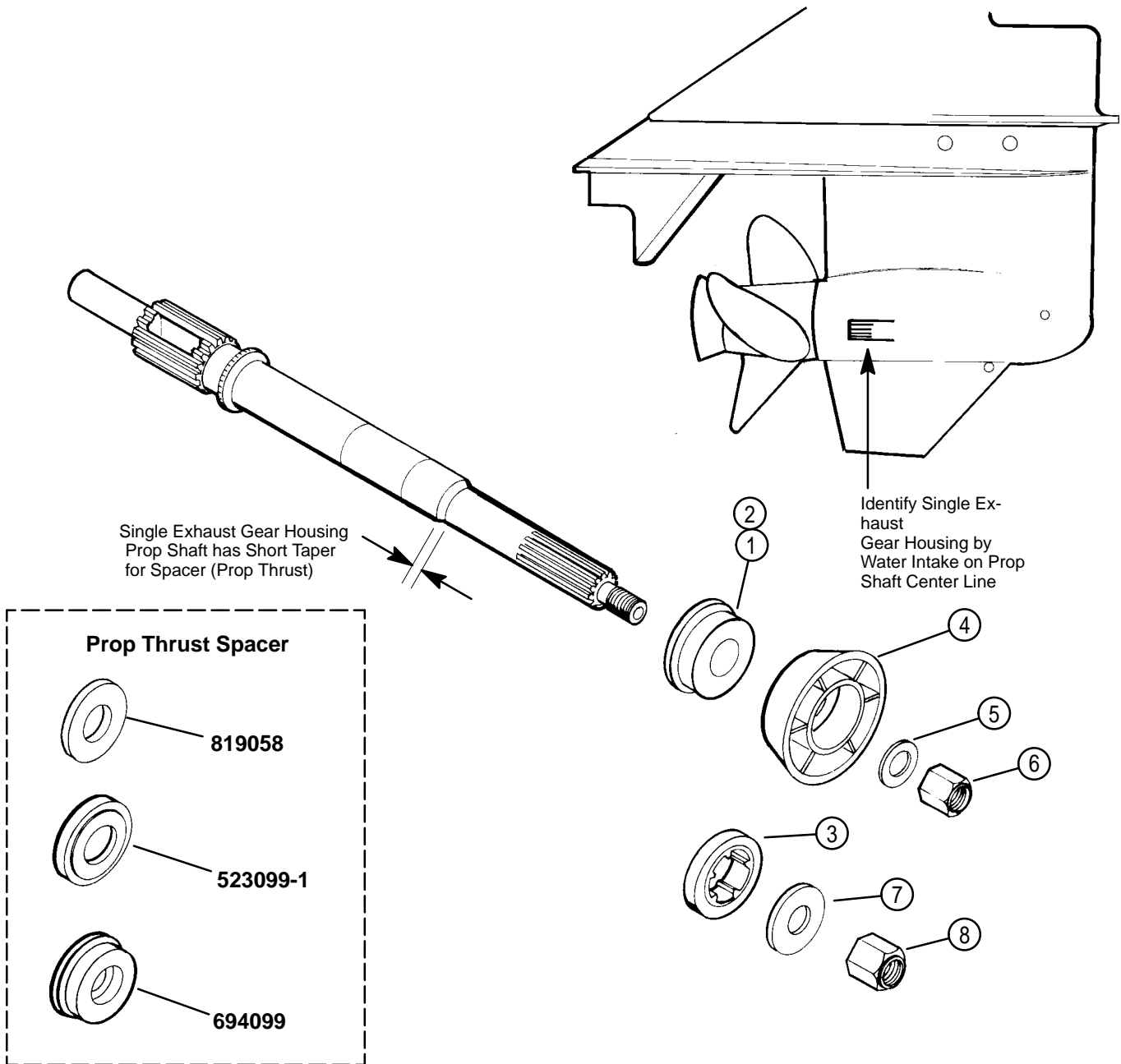

Figure 1.

(OVER)

**PROPELLER HARDWARE**  
**Single Exhaust Models - 85 thru 150 HP**

1) 523099-1	Spacer (Prop Thrust)	All Props - Except 5H258 & P745 or 694099
2) 819058	Spacer (Prop Thrust)	5H258 & P745 Props Only
3) 523282	Washer (Prop Spline)	Flared Hub Props
4) 532299	Spacer (Plastic Flare)	Straight Hub Props
5) 1866	Washer (Stop Nut)	Prop Shaft w/ 5/8-18 Thread
6) 7048	Stop Nut (5/8-18)	Prop Shaft w/ 5/8-18 Thread
7) 8167	Washer	Prop Shaft w/ 3/4-16 Thread
8) 7000	Stop Nut (3/4-16)	Prop Shaft w/ 3/4-16 Thread



**Figure 2.**