



# parts bulletin



No. 98-2

## Steering Attachment Bolt 10-849838

### Models Affected

All Mercury and Mariner Hi-Performance Outboards:  
Pro Max/Super Magnum 150/200/225/& 300  
All 2.5 EFI Models

Beginning on January 2, 1998 all Hi-Performance model outboards have been shipped with a new steering attachment bolt, 10-849838, which attaches the steering link rod to the steering tiller arm.

When servicing steering components on Hi-Performance outboards built before January of 1998, the steering attachment bolt should be replaced with the new bolt.

### BOLT IDENTIFICATION

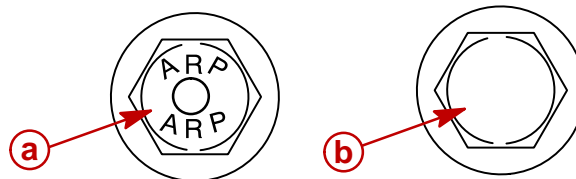

- a** - Recommended Bolt (10-849838) for All Hi-Performance Engines Has Vendor Letters (ARP) on Head
- b** - Bolt Used Before January, 1998 Has No Letters.

### **CAUTION**

**STEERING ATTACHMENT COMPONENTS USED ON HI-PERFORMANCE OUTBOARDS SHOULD BE VISUALLY INSPECTED FOR WEAR, LUBRICATED AND ALL ATTACHMENT HARDWARE CHECKED FOR PROPER TORQUE TIGHTNESS EVERY 25 HRS. OF OPERATION.**

1. An access hole is provided thru the bottom cowl to ease installation of the link rod connecting bolt. Reinstall plug after completion.
2. Install steering link rod per illustration.

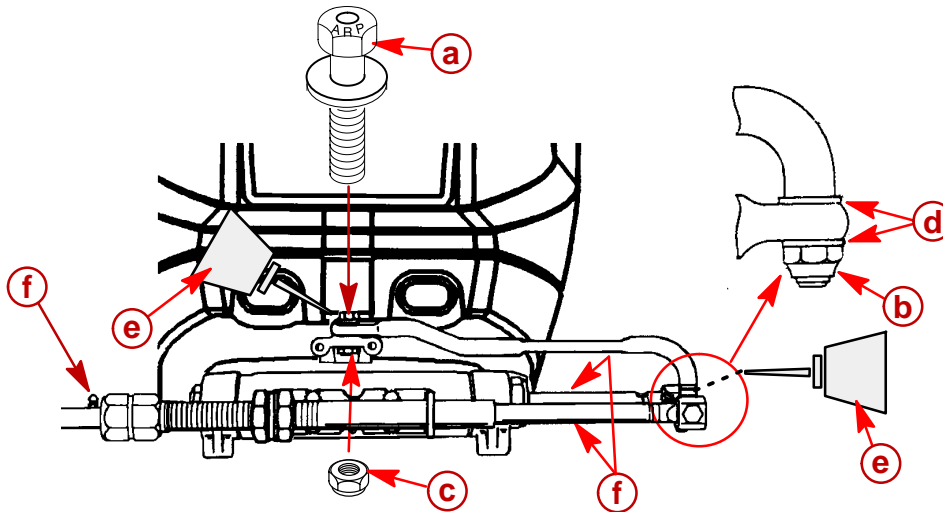

- a** - Special Bolt (10-849838) - Tighten to 20 lb. ft. (27 N·m)
- b** - Nylon Insert Locknut (11-34863) -Tighten Until Nut Seats Then Back Off 1/4 Turn
- c** - Nylon Insert Locknut - Tighten to 20 lb. ft. (27 N·m) after Torquing (a)
- d** - Flat Washers
- e** - 30W Motor Oil
- f** - Lubricate with 2-4-C With Teflon (92-825407A12) or Special Lubricant 101 (92-13872A1)