



PARTS CATALOG

140 ENGINE

SERIAL NUMBER

140 GM 181 I/L4 1972-1978 3332138 THRU 5157668

TABLE OF CONTENTS:

CAMSHAFT, CRANKSHAFT AND WATER PUMP	34
CARBURETOR ASSEMBLY	20
CYLINDER BLOCK, PISTON AND BEARINGS	32
CYLINDER HEAD AND ROCKER COVER	36
DISTRIBUTOR ASSEMBLY AND COIL	10
EXHAUST ELBOW ASSEMBLY	40
EXHAUST MANIFOLD ASSEMBLY	24
FLYWHEEL HOUSING AND ENGINE SUPPORT	28
FUEL PUMP, FUEL FILTER AND CARBURETOR	16
OIL PAN, OIL PUMP AND CRANKCASE COVER	38
PARTS INDEX	42
STARTER MOTOR AND ALTERNATOR	6
THROTTLE LINKAGE	14
WIRING HARNESS,CIRCUIT BREAKER AND STARTER SOLENOID	2

NOTE: Indented description indicate that these parts are included in preceding assembly.

AR = As Required

NSS = Not Sold Separate

OPT = Optional

NS = Not Shown

NOTE: Following symbols are located in **SYM** column.

■ = COMPONENT OF ENGINE/POWERHEAD
GASKET SET (27-52364A2)

◆ = EXHAUST MANIFOLD GASKET SET (27-
53354A1)

⊕ = WATER PUMP GASKET SET (27-34213A2)

THESE PARTS BOOKS/FICHE CARD ARE COPYRIGHTED AND MAY NOT BE DISTRIBUTED OR REPRODUCED IN ANY OTHER FORMAT BY ANYONE OTHER THAN MERCURY MARINE WITHOUT THE PRIOR WRITTEN CONSENT OF MERCURY MARINE.

REPLACEMENT PARTS ! WARNING !

Electrical, ignition and fuel system components on MerCruiser Engines and Stern Drives are designed and manufactured to comply with U.S. Coast Guard Rules and Regulations to minimize risks of fire or explosion. Use of replacement electrical, ignition or fuel system components, which do not comply to these rules and regulations, could result in a fire or explosion hazard and should be voided.

When servicing the electrical, ignition and fuel systems, it is extremely important that all components are properly installed and tightened. If not, any electrical or ignition component opening would permit sparks to ignite fuel vapors from fuel system leaks, if they existed.

ENGINE MECHANICAL COMPONENTS

Many of the engine mechanical components are designed for marine applications. Unlike automotive engines, marine engines are subjected to extended periods of heavy load and wide- open-throttle operation, therefore, require heavy-duty components. Special marine engine parts have design and manufacturing specifications, which are required to provide long life and dependable performance. Marine engine parts also must be able to resist the corrosive action of salt or brackish water that will rust or corrode standard automotive parts within a short period of time.

Failure to use recommended Mercury Precision Parts OR Quicksilver service replacement parts can result in poor engine performance and/or durability, rapid corrosion of parts subjected to salt water and possibly complete failure of the engine.

Use of parts other than recommended service replacement parts will void the warranty on those parts which are damaged as a result of the use of other than recommended parts.

WIRING HARNESS, CIRCUIT BREAKER AND STARTER SOLENOID

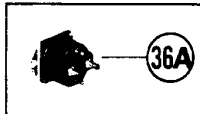
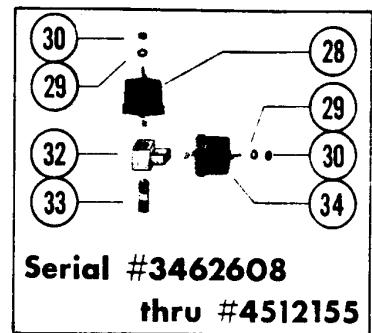
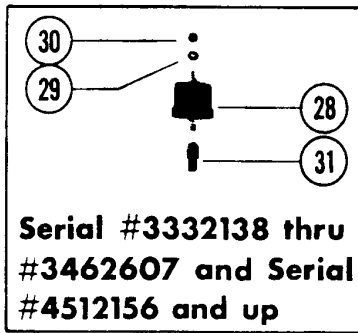
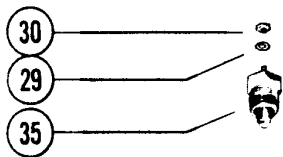

84-94227A2
Resistance Wire Kit

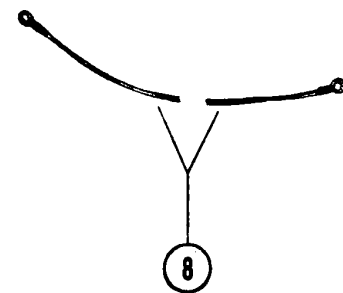
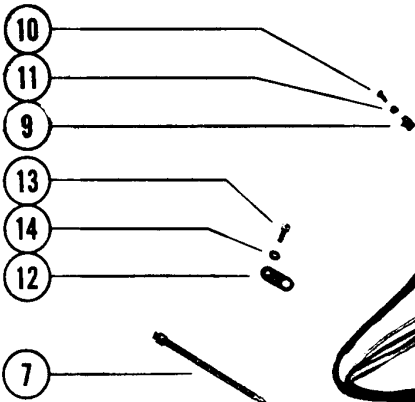
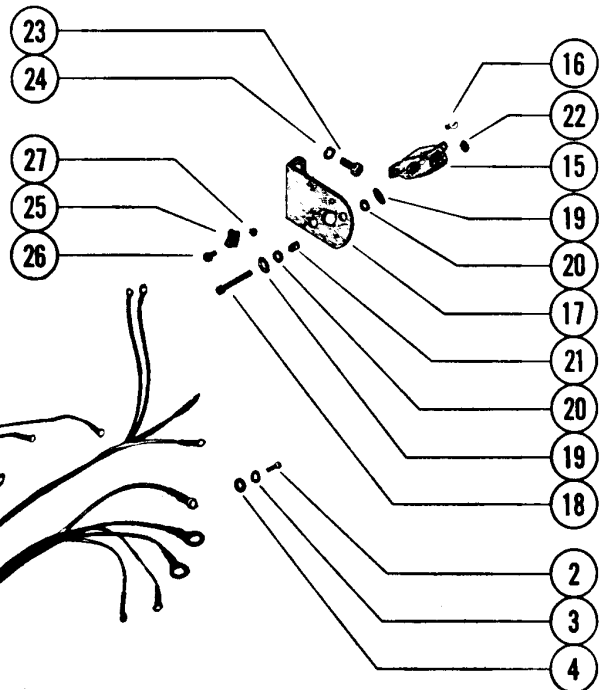
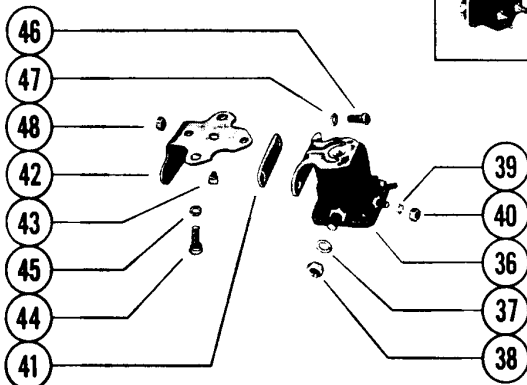

WIRING HARNESS,CIRCUIT BREAKER AND STARTER SOLENOID

REF. NO.	PART NO.	SYM.	QTY.	DESCRIPTION
1	84-61975		1	WIRING HARNESS, EXTERNAL SERIAL 03332138-03462607
	84-63715		1	WIRING HARNESS, EXTERNAL SERIAL 03462608-03771644
	84-66962A1		1	WIRING HARNESS, EXTERNAL SERIAL 03771645-09999999
2	10-20055		1	SCREW, WIRING HARNESS LEAD TO ALTERNATOR (3/8")
3	13-26996		1	LOCKWASHER, WIRING HARNESS LEAD SCREW
4	12-30164		1	WASHER, WIRING HARNESS LEAD SCREW
5	26079		1	PLATE, WIRING HARNESS TO MOUNTING BRACKET
6	10-46718		4	SCREW, WIRING HARNESS PLATE TO MOUNTING BRACKET (3/4")
7	61990		1	STA-STRAP, STARTER SOLENOID LEAD SERIAL 03332138-00346260
8	39593		1	BATTERY CABLE POSITIVE SERIAL 03332138-00346260
	39594		1	BATTERY CABLE NEGATIVE SERIAL 03332138-00346260
9	54-54178		1	CLAMP, WIRING HARNESS TO CVLINDER BLOCK SERIAL 03332138-00346260
10	10-25703		1	SCREW, WIRING HARNESS HARNESS CLAMP ATTACHING (1/2") SERIAL 03332138-00346260
11	13-37459		1	LOCKWASHER, WIRING HARNESS CLAMP SCREW SERIAL 03332138-00346260
12	63770		2	TAB, HARNESS ATTACHING SERIAL 00462608-09999999
13	10-35585		2	SCREW, HARNESS TO ROCKER COVER SERIAL 00462608-09999999
14	12-20583		2	WASTHER, HARNESS TO ROCKER COVER SCREW SERIAL 00462608-09999999
15	59816		1	CIRCUIT BREAKER SERIAL 03332138-03771544
16	10-36046		2	SCREW, WIRING HARNESS LEAD TO CIRCUIT BREAKER SERIAL 03332138-03771544
15	88-65093		1	CIRCUIT BREAKER SERIAL 03771645-04918569
-	11-20645		2	NUT, HARNESS TO CIRCUIT BREAKER STUD SERIAL 03771645-04918569
-	13-26996		2	LOCKWASHER, HARNESS TO CIRCUIT BREAKER STUD SERIAL 03771645-04918569
	88-78813		1	CIRCUIT BREAKER SERIAL 04918570-09999999
17	61800		1	BRACKET, CIRCUIT BREAKER SERIAL 03332138-03462607
	62566		1	BRACKET, CIRCUIT BREAKER SERIAL 03462608-09999999
18	10-47618		2	SCREW, CIRCUIT BREAKER TO BRACKET (1")
19	12-47960		4	WASHER, CIRCUIT BREAKER ATTACHING SCREW
20	25-61999		4	GROMMET, CIRCUIT BREAKER ATTACHING SCREW
21	23-61998		2	SPACER, CIRCUIT BREAKER ATTACHING SCREW SERIAL 03332138-03462607
	23-63431		2	SPACER, CIRCUIT BREAKER ATTACHING SCREW SERIAL 03462608-09999999
22	11-46438		2	NUT, CIRCUIT BREAKER ATTACHING SCREW
23	10-21077		1	SCREW, CIRCUIT BREAKER BRACKET TO CVLINDER HEAD (7/8") SERI SERIAL 03332138-03462607
	10-27165		1	SCREW, CIRCUIT BREAKER BRACKET TO CYLINDER HEAD (3/4") SERIAL 03332138-03462607

CONTINUED ON NEXT PAGE ➡

WIRING HARNESS, CIRCUIT BREAKER AND STARTER SOLENOID

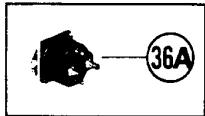
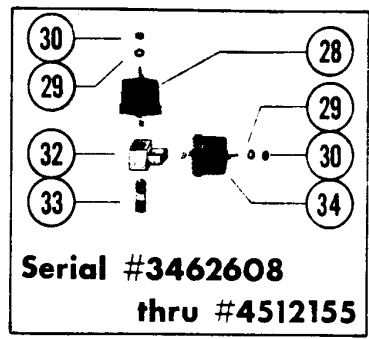
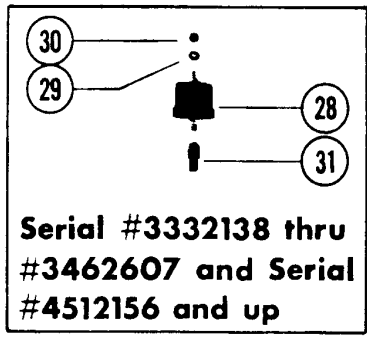
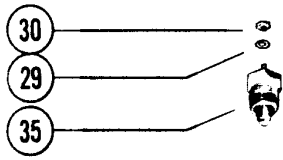

84-94227A2
Resistance Wire Kit

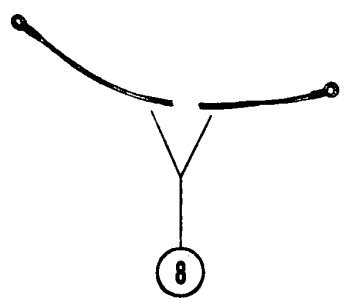
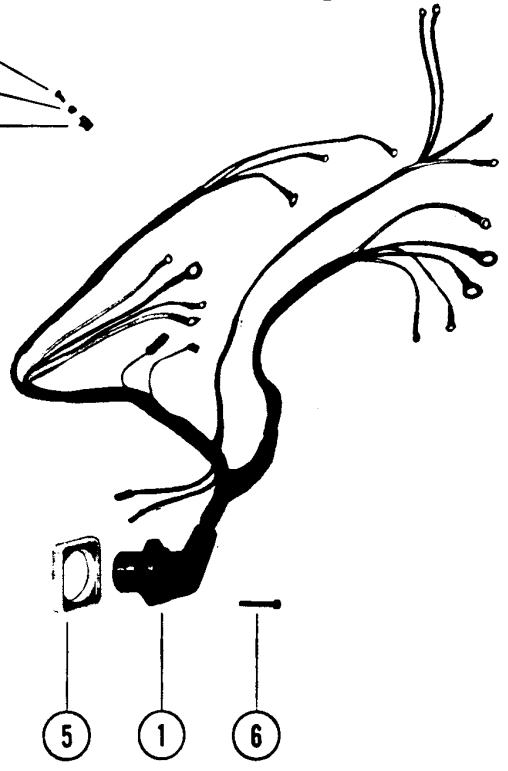
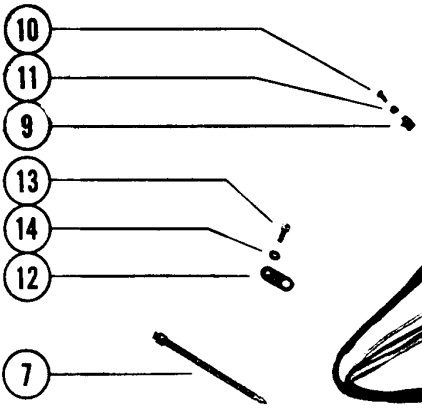
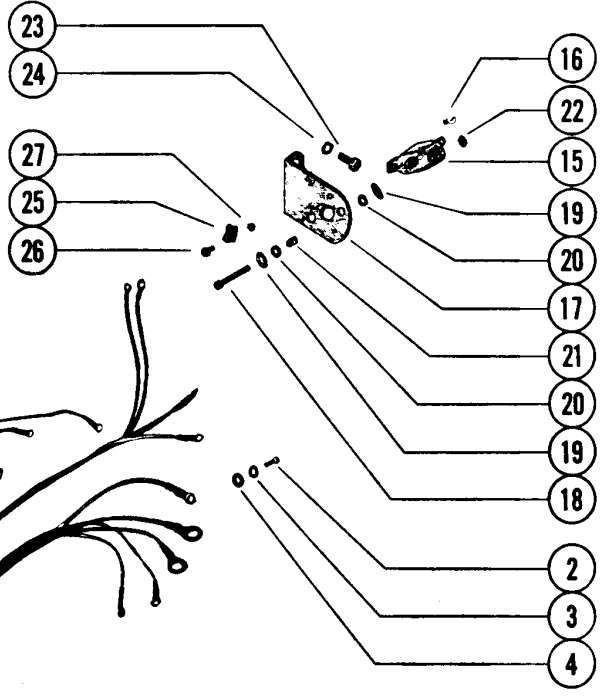
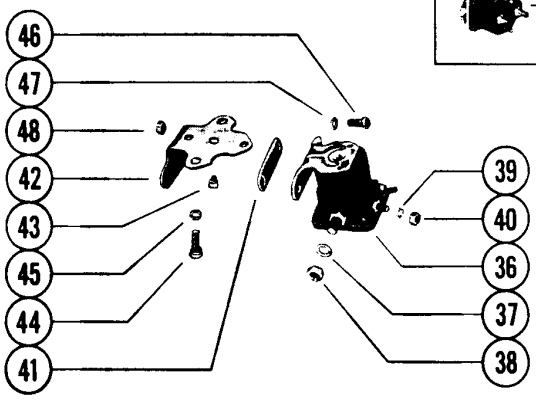

WIRING HARNESS,CIRCUIT BREAKER AND STARTER SOLENOID

REF. NO.	PART NO.	SYM.	QTY.	DESCRIPTION
23	10-21077		2	SCREW, CIRCUIT BREAKER BRACKET TO CYLINDER HEAD (7/8")-SERI SERIAL 03462608-09999999
24	13-37459		2	LOCKWASHER, CIRCUIT BREAKER BRACKET SCREW
25	54-60517		1	CLAMP, WIRING HARNESS TO BRACKET SERIAL 03332138-00377164
26	10-47194		1	SCREW, CLAMP TO BRACKET (9/16") SERIAL 03332138-00377164
27	11-46438		1	NUT, CLAMP ATTACHING SCREW SERIAL 03332138-00377164
28	34623		1	OIL PRESSURE SENDER ASSEMBLY
29	13-26996		2	WASHER, WATER SENDER/OIL PRESSURE SENDER TERMINAL (#10)
30	11-20645		2	NUT, WATER SENDER/OIL PRESSURE SENDER TERMINAL (10-32)
31	22-32974		1	ADAPTOR, OIL PRESSURE SENDER TO CYLINDER BLOCK SERIAL 03332138-03462607
32	22-52930		1	FITTING, TEE - OIL PRESSURE SERIAL 03462608-04512155
33	22-64698		1	FITTING, NIPPLE - OIL PRESSURE SERIAL 03462608-04512155
34	38559		1	SWITCH, OIL PRESSURE SERIAL 03462608-04512155
35	36525		1	WATER TEMPERATURE SENDER ASSEMBLY
36	25661		1	STARTER SOLENIOD ASSEMBLY SERIAL 00000000-04460664
36A	89-68258		1	STARTER SOLENOID SERIAL 04460665-09999999
37	13-26993		2	LOCKWASHER, STARTER SOLENOID TERMINAL (5/16")
38	11-68292		2	NUT, STARTER SOLENOID TERMINAL (5/16")
39	13-26996		2	LOCKWASHER, STARTER SOLENOID TERMINAL (#10)
40	11-20645		2	NUT, STARTE SOLENOID TERMINAL (10-32)
41	36177		1	INSULATOR, STARTER SOLENOID BRACKET SERIAL 03332138-03462607
42	36176A2		1	BRACKET ASSEMBLY, STARTER SOLENOID MOUNTING SERIAL 03332138-03462607
43	49342		1	BUMPER, MOUNTING BRACKET SERIAL 03332138-03462607
44	10-33231		2	SCREW, MOUNTING BRACKET TO MANIFOLD BODY (1/2") SERIAL 03332138-03462607
45	13-26993		2	LOCKWASHER, MOUNTING BRACKET SCREW SERIAL 03332138-03462607
46	10-21625		2	SCREW, STARTER SOLENOID TO MOUNTING BRACKET (3/4")
47	13-26992		2	LOCKWASHER, STARTER SOLENOID SCREW
48	11-20664		2	NUT, STARTER SOLENIOD SCREW
-	33865		2	WRAP, ENGINE HARNESS

STARTER MOTOR AND ALTERNATOR

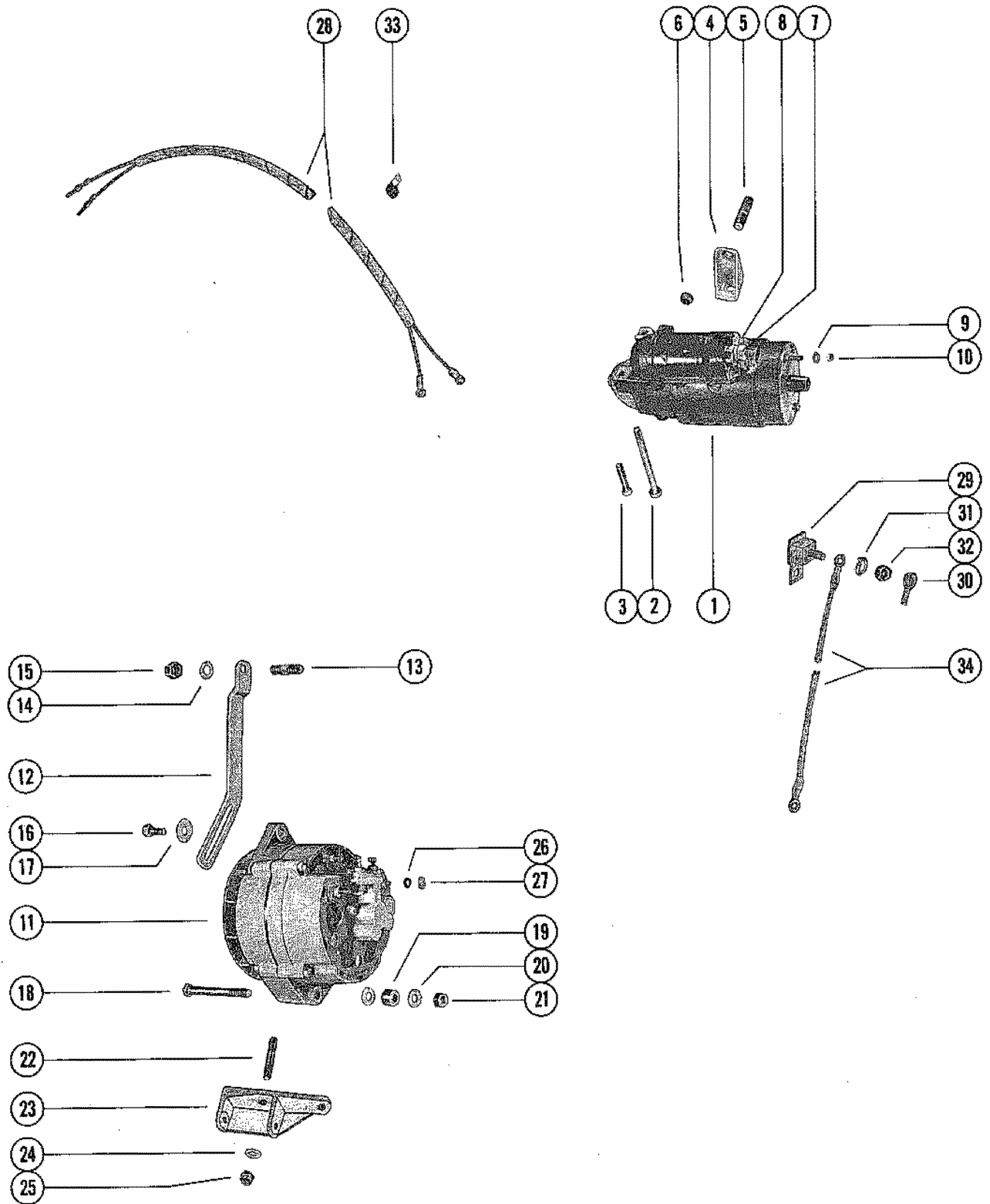

STARTER MOTOR AND ALTERNATOR

REF. NO.	PART NO.	SYM.	QTY.	DESCRIPTION
1	50-59799		1	STARTER MOTOR ASSEMBLY (DELCO REMY #1108477)
	50-69863A1		1	STARTER MOTOR ASSEMBLY (DELCO REMY #1108756)
2	10-34545		1	BOLT, STARTER MOTOR MOUNTING (4 21/32")
3	10-34544		1	BOLT, STARTER MOTOR MOUNTING (1 15/16")
4	54671		1	BRACE, STARTER MOTOR
5	16-52387		2	STUD, BRACE TO MOTOR AND CYLINDER BLOCK
6	11-64809		2	NUT, BRACE STUD
7	11-32219		1	NUT, SOLENOID SWITCH TERMINAL (3/9-16)
8	11-26419		1	NUT, SOLENOID SWITCH TERMINAL (8-32)
9	13-26995		1	LOCKWASHER, STARTER MOTOR TERMINAL (#8)
	13-26996		1	LOCKWASHER, STARTER MOTOR TERMINAL (#10)
10	11-26419		1	NUT, STARTE MOTOR TERMINAL (8-32)
	11-20645		1	NUT, STARTER MOTOR TERMINAL (10-32)
11	59755		1	ALTERNATOR ASSEMBLY (DELCO REMY #1100577)
	69729		1	ALTERNATOR ASSEMBLY (DELCO REMY #1102496)
	78403A1		1	ALTERNATOR ASSEMBLY MOTOROLA #8MR2023F)
12	58333		1	BRACE, ALTERNATOR TO CYLINDER BLOCK (FRONT)
13	16-54177		1	STUD, ALTERNATOR BRACE TO CYLINDER BLOCK (1 3/8")
14	12-20553		1	WASHER, ALTERNATOR BRACE STUD
15	11-23161		1	NUT, ALTERNATOR BRACE STUD
16	10-29198		1	SCREW, ALTERNALTOR BRACE TO ALTERNATOR (7/8")
17	12-26168		1	WASHER, ALTERNATOR BRACE SCREW
18	10-37626		1	SCREW, ALTERNATOR TO BRACKET (4 1/4")
19	23-56777		1	SPACER, ALTERNATOR TO BRACKET SERIAL 03332138-03462607
	23-63894		1	SPACER, ALTERNATOR TO BRACKET SERIAL 03462608-09999999
20	12-25970		2	WASHER, ALTERNATOR TO BRACKET
21	11-23161		1	NUT, ALTERNATOR SCREW
22	16-54176		2	STUD, ALTERNATOR BRK. (1 5/8") SERIAL 03332138-03462607
	16-56826		2	STUD, ALTERNATOR BRK. (1 1/2") SERIAL 03462608-09999999
23	56778		1	BRACKET, ALTERNATOR MOUTING SERIAL 03332138-03462607
	63857A1		1	BRACKET ASS'Y, ALTERNATOR MOUTING SERIAL 03462608-09999999
24	12-20553		2	WASHER, MOUNTING BRACKERT STUD
25	11-2161		2	NUT, MOUNTING BRACKET STUD
26	13-26991		1	LOCKWASHER, ALTERNATOR TERMINAL
27	11-68531		1	NUT, ALTERNATOR TERMINAL
28	84-78581A3		1	WIRING HARNESS ASSEMBLY, ALTERNATOR SERIAL 04918570-09999999
29	88-79023A55		1	FUSE ASS'Y SOLENOID - 55 AMP SERIAL 00000000-05101214
	88-79023A90		1	FUSE ASS'Y SOLENOID - 90 AMP SERIAL 04918570-09999999

CONTINUED ON NEXT PAGE ➡

STARTER MOTOR AND ALTERNATOR

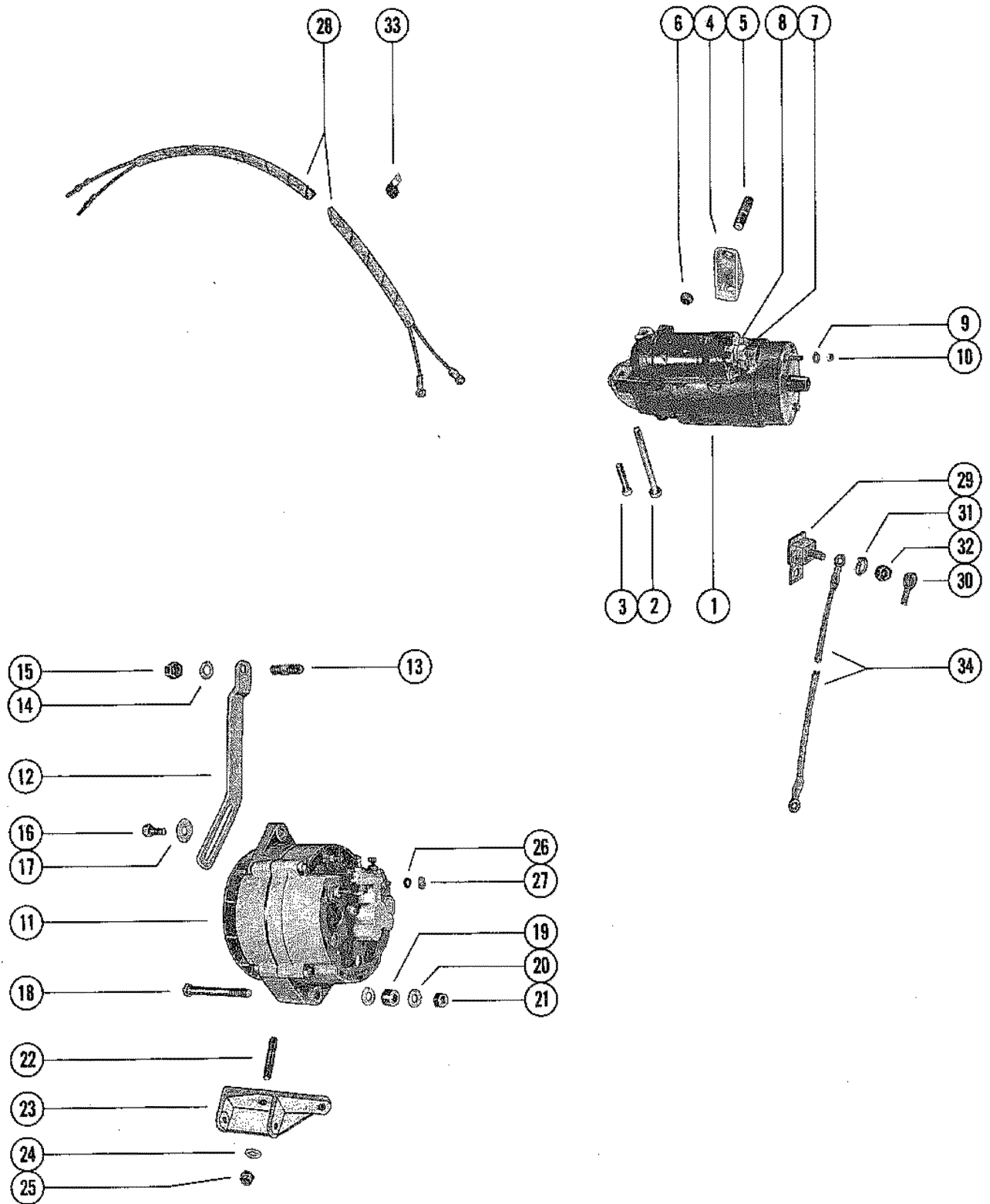

STARTER MOTOR AND ALTERNATOR

REF. NO.	PART NO.	SYM.	QTY.	DESCRIPTION
30	85-79695		1	BOOT, INSULATOR SERIAL 04918570-09999999
31	13-26992		1	LOCKWASHER, SOLENOID ATTACHING SCREW SERIAL 04918570-09999999
32	11-21825		1	NUT, SOLENOID ATTACHING SCREW SERIAL 04918570-09999999
33	54-73668		1	"J" CLIP, HARNESS TO FLYWHEEL HOUSING SERIAL 04918570-09999999
34	84-79139A5		1	JOMPER WIRE, 90 AMP FUSE SERIAL 04918570-09999999

DISTRIBUTOR ASSEMBLY AND COIL

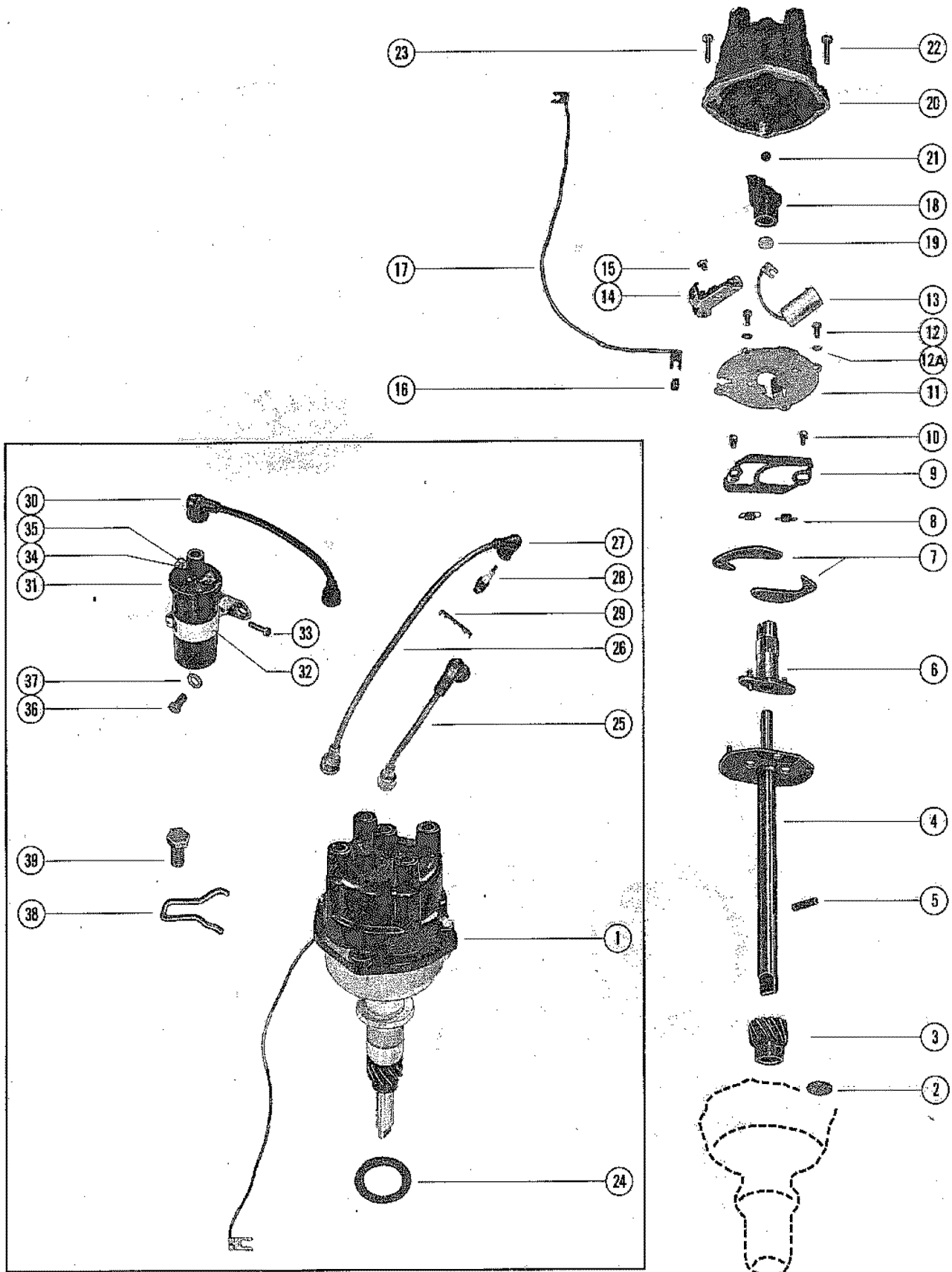

DISTRIBUTOR ASSEMBLY AND COIL

REF. NO.	PART NO.	SYM.	QTY.	DESCRIPTION
1	62424		1	DISTRIBUTOR ASSEMBLY COMPLETE
2	62426		2	SCREEN, VENT - DISTRIBUTOR HOUSING
3	43-33664		1	GEAR, DRIVE - MAIN SHAFT
4	58237		1	MAIN SHAFT AND WEIGHT PLATE
5	17-33649		1	PIN, DRIVE GEAR TO MAIN SHAFT
6	58235		1	CAM, BREAKER - ADVANCE
-	12-58220		1	WASHER, CAM AND SHAFT
-	26-58219		1	SEAL, HOUSING
-	33653		1	FELT, BREAKER CAM IUBRICATOR
-	33670		1	RETAINER, BREAKER CAM LUBRICATOR FELT
7	33769		2	WEIGHT, BREAKER CAM ADVANCE
8	24-58236		2	SPRING, BREAKER CAM ADVANCE WEIGHT
9	33655		1	PLATE, WEIGHT HOLD DOWN
10	10-33722		2	SCREW, WEIGHT HOLD DOWN PLATE TO WEIGHT PLATE
11	33665		1	PLATE, MOUNTING - BREAKER ASSEMBLY AND CONDENSER
12	10-33648		2	SCREW, MOUNTING PLATE TO PRIMARY HOUSING
12A	12-62425		2	WASHER, BREAKER PLATE SUPPORT SCREW
13	33662		1	CONDENSER
-	48024		1	BRACKET, CONDENSER MOUNTING
-	10-48021		1	SCREW, CONDENSER BRACKET ATTACHING
14	34235		1	BREAKER ASSEMBLY, DISTRIBUTOR
15	10-33650		1	SCREW, BREAKER ASSEMBLY TO MOUNTING PLATE
16	25-33666		1	GROMMET, MOUNTING PLATE - PRIMARY WIRE
17	48025		1	LEAD, PRIMARY
18	58217		1	ROTOR, DISTRIBUTOR
19	12-36275		1	WASHER, ROTOR
20	33667		1	CAP, DISTRIBUTOR
21	33654		1	BUTTON, CARBON - DISTRIBUTOR CAP
22	10-33660		1	SCREW, DISTRIBUTOR CAP TO PRIMARY HOUSING (8-32)
23	10-33663		1	SCREW, DISTRIBUTOR CAP TO PRIMARY HOUSING (10-32)
24	27-34486		1	GASKET, DISTRIBUTOR
25	84-69713--1		2	LEAD ASSEMBLY, HIGH TENSION - DISTRIBUTOR (6")
26	84-69713--2		2	LEAD ASSEMBLY, HIGH TENSION - DISTRIBUTOR (14")
27	47604A1		4	PROTECTOR, HIGH TENSION LEAD
-	60096		4	SLEEVE, TERMINAL END COVER
28	33-54527		4	SPARK PLUG (AC#CR 44N) - NON TAPERED
	33-59571		4	SPARK PLUG (AC#R43T) - TAPERED
29	32782		1	RETAINER, HIGH TENSION LEADS
30	32763A1		1	WIRE ASSEMBLY, DISTRIBUTOR TO COIL (8 1/4") SERIAL 03332138-03771644
31	26433		1	COIL, IGNITION SERIAL 03332138-03771644
32	33321		1	BRACKET, IGNITION COIL MOUNTING SERIAL 03332138-03771644

CONTINUED ON NEXT PAGE ➡

DISTRIBUTOR ASSEMBLY AND COIL

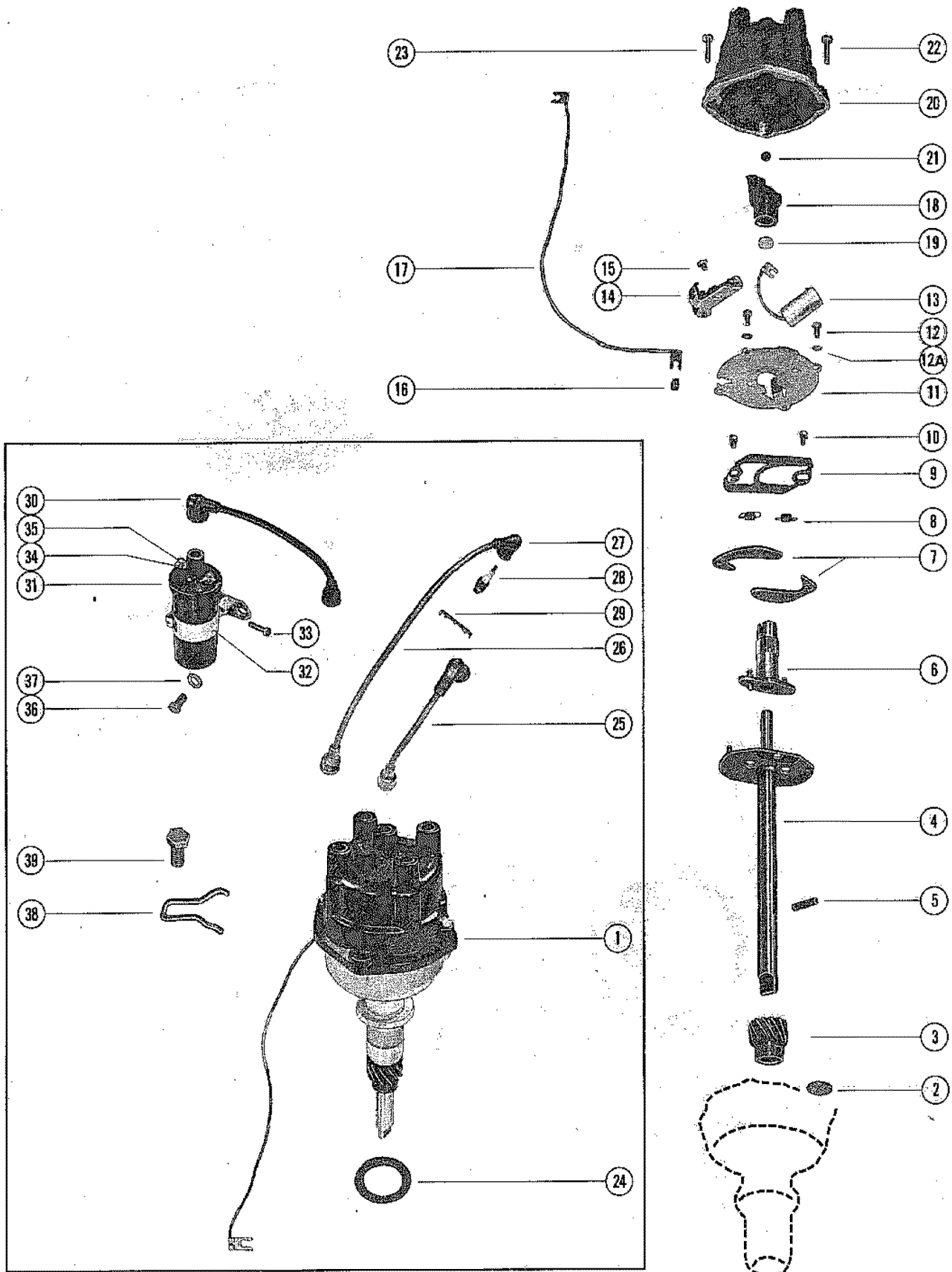

DISTRIBUTOR ASSEMBLY AND COIL

REF. NO.	PART NO.	SYM.	QTY.	DESCRIPTION
33	10-33311		1	SCREW, MOUNTING BRACKET TO COIL (1 1/2") SERIAL 03332138-03771644
30	84-67203		1	WIRE, DISTRIBUTOR TO COIL (12") SERIAL 03771645-09999999
31	32193		1	COIL, IGNITION SERIAL 03771645-09999999
32	65970		1	BRACKET, IGNITION COIL MOUNTING SERIAL 03771645-09999999
33	10-66652		1	SCREW, MOUNTING BRACKET TO COIL SERIAL 03771645-09999999
34	12-30164		2	WASHER, IGNITION COIL TERMINAL
	13-26996		2	LOCKWASHER, IGNITION COIL TERMINAL
35	11-20645		2	NUT, IGNITION COIL TERMINAL
36	10-27165		1	SCREW, IGNITION COIL TO CYLINDER BLOCK
37	12-20553		1	WASHER, IGNITION COIL SCREW
38	62420		1	CLAMP UNIT, DISTRIBUTOR SERIAL 00000000-04512155
	72624		1	CLAMP UNIT, DISTRIBUTOR SERIAL 04512156-09999999
39	10-35169		1	SCREW, DISTRIBUTOR TO CYLINDER BLOCK

THROTTLE LINKAGE

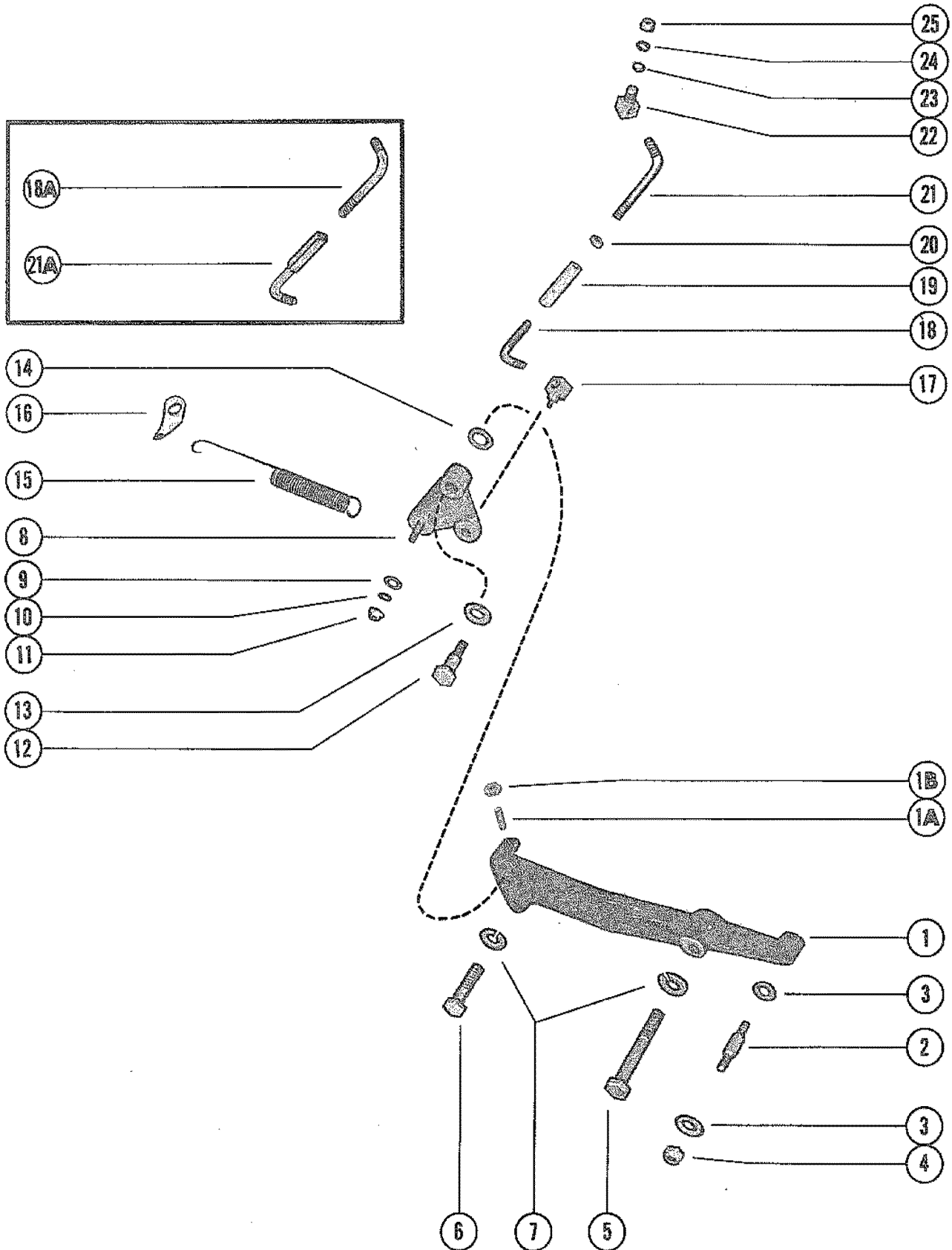

THROTTLE LINKAGE

REF. NO.	PART NO.	SYM.	QTY.	DESCRIPTION
1	52124		1	BRACKET, MOUNTING - THROTTLE LINKAGE SERIAL 00000000-04460664
	70127		1	BRACKET, MOUNTING - THROTTLE LINKAGE SERIAL 04460665-09999999
1A	10-64969		1	SCREW, THROTTLE STOP SERIAL 04460665-09999999
1B	11-33122		1	NUT, THROTTLE STOP SCREW SERIAL 04460665-09999999
2	16-38525		1	STUD, ANCHOR - THROTTLE CABLE TO MOUNTING BRACKET
3	12-24664		2	WASHER, THROTTLE CABLE ANCHOR STUD
4	11-20586		1	NUT, THROTTLE CABLE ANCHOR STUD
5	10-25038		1	BOLT, MOUNTING BRACKET TO EXHAUST MANIFOLD (7/8")
6	10-20362		1	BOLT, MOUNTING BRACKET TO EXHAUST MANIFOLD (1 1/2")
7	13-39107		2	LOCKWASHER, MOUNTING BRACKET BOLT
8	38979		1	LEVER, THROTTLE - MOUNTING BRACKET SERIAL 03332138-03462607
	63713		1	LEVER, THROTTLE - MOUNTING BRACKET SERIAL 03462608-04918569
	78890		1	LEVER, THROTTLE - MOUNTING BRACKET SERIAL 04918570-09999999
9	12-35950		1	WASHER, THROTTLE LEVER AND STUD (7/16" O.D.)
10	12-30164		1	WASHER, THROTTLE LEVER STUD (3/8" O.D.)
11	11-20110		1	NUT, THROTTLE LEVER STUD
12	10-38507		1	SCREW, STEP - THROTTLE LEVER TO MOUNTING BRACKET
13	12-57792		1	WASHER, THROTTLE LEVER STEP SCREW (21/64" I.D.)
14	12-20553		1	WASHER, THROTTLE LEVER STEP SCREW (3/8" O.D.)
15	24-52082		1	SPRING, THROTTLE RETURN
16	52075		1	BRACKET, THROTTLE RETURN SPRING
17	27947		1	SWIVEL, LINK ROD TO THROTTLE LEVER
18	38982		1	LINK ROD, THROTTLE SERIAL 03332138-04156999
19	33393		1	SLEEVE, ADJUSTING - THROTTLE LINK ROD SERIAL 03332138-04156999
20	11-25168		1	NUT, JAM - THROTTLE LINK ROD SERIAL 03332138-04156999
21	33394		1	LINK ROD, CARBURETOR SERIAL 03332138-04156999
18A	64804		1	LINK ROD, THROTTLE SERIAL 04157000-09999999
21A	63145A1		1	LINK ROD, CABURETOR SERIAL 04157000-09999999
22	38983		1	SWIVEL, LINK ROD TO CARBURETOR
23	12-35950		1	WASHER, LINK ROD TO CARURETOR SWIVEL
24	12-30164		1	WASHER, LINK ROD TO CARBURETOR SWIVEL
25	11-20110		1	NUT, LINK ROD TO CARBURETOR SWIVEL

FUEL PUMP, FUEL FILTER AND CARBURETOR

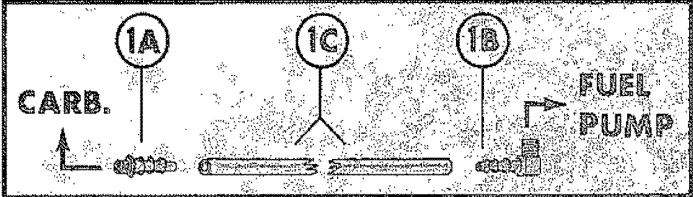
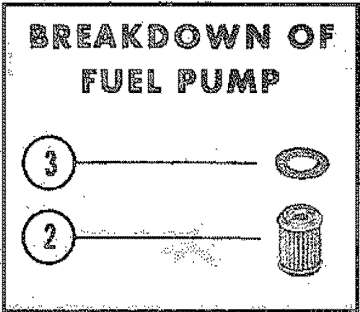
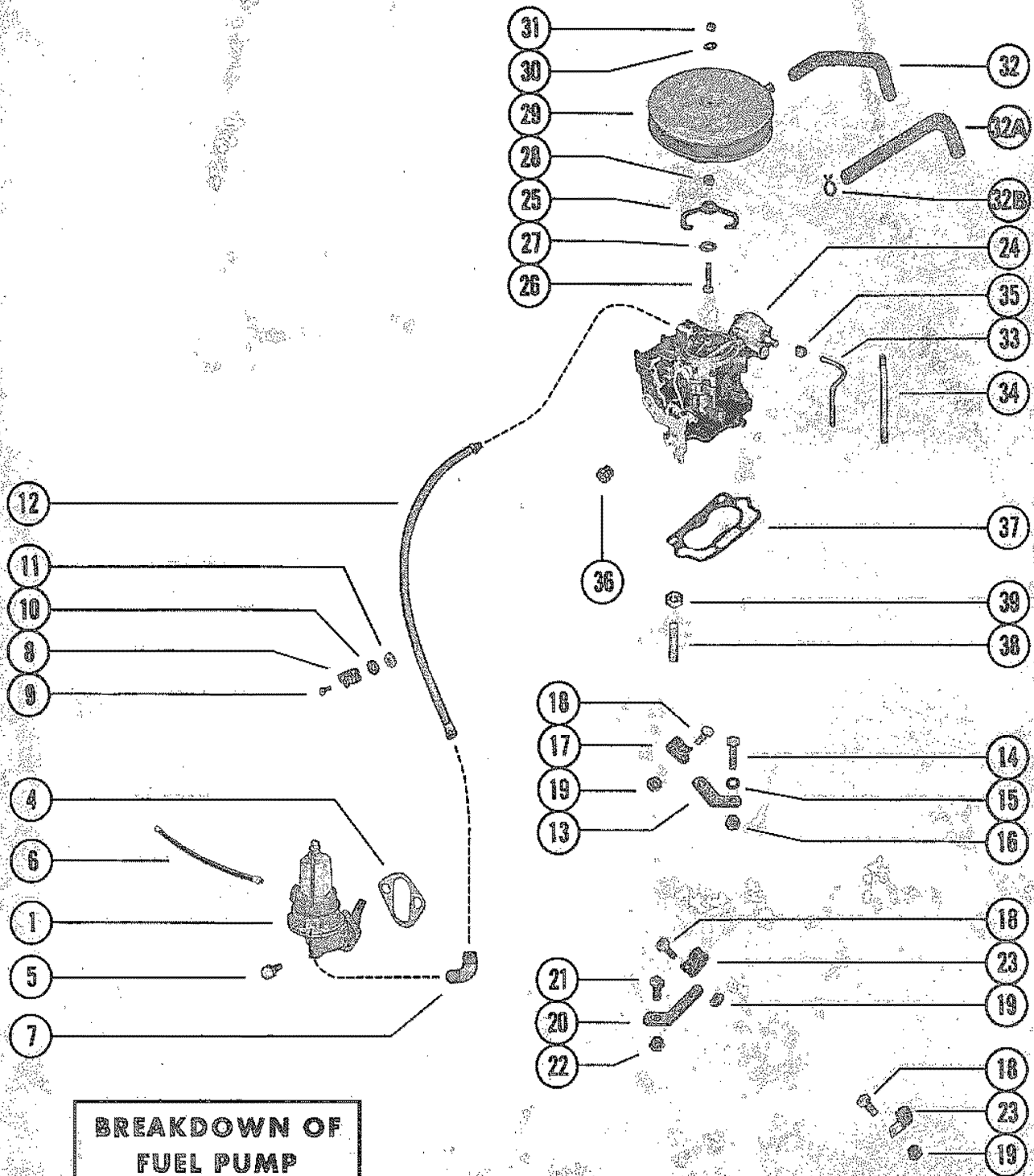

FUEL PUMP, FUEL FILTER AND CARBURETOR

REF. NO.	PART NO.	SYM.	QTY.	DESCRIPTION
1	47585		1	FUEL PUMP ASSEMBLY SERIAL 00000000-04460664
	71327		1	FUEL PUMP ASSEMBLY SERIAL 04460665-04918569
	77594		1	FUEL PUMP ASSEMBLY SERIAL 04918470-09999999
1A	22-73816		1	CPNNECTOR, VENT TO CARBURETOR SERIAL 04460665-09999999
1B	22-73817		1	CONNECTOR, VENT TUBE TO FUEL PUMP SERIAL 04460665-09999999
1C	32-73815		1	TUBE, VENT SERIAL 04460665-09999999
2	35-49088		1	FILTER, FUEL - FUEL PUMP
3	49089		1	DIAPHRAGM KIT, FUEL PUMP
4	27-34213	✦	1	GASKET, FUEL PUMP
5	10-45488		2	SCREW, FUEL PUMP TO CYLINDER BLOCK (3/4")
6	32-30466		1	FUEL LINE, TANK TO FUEL PUMP SERIAL 03332138-03462607
7	22-49217		1	FITTING, FUEL LINE SERIAL 03332138-03462607
	22-64294		2	FITTING, STEEL FUEL LINE SERIAL 03462608-33771644
	22-70584		1	FITTING, STEEL FUEL LINE SERIAL 03771645-09999999
8	54-65653		1	CLIP, FUEL LINE TO ROCKER COVER SERIAL 03771645-09999999
9	10-32079		1	SCREW, CLIP TO ROCKER COVER SERIAL 03771645-09999999
8	54-28938		1	CLIP, FUEL LINE TO CYLINDER BLOCK SERIAL 03332138-03462607
9	10-29199		1	SCREW, FUEL LINE CLIP TO CYLINDER BLOCK (1") SERIAL 03332138-03462607
10	12-24662		1	WASHER, FUEL LINE CLIP SCREW SERIAL 03332138-03462607
11	11-20890		1	NUT, FUEL LINE CLIP SCREW SERIAL 03332138-03462607
12	32-53824		1	FUEL LINE, FUEL PUMP TO CARBURETOR SERIAL 03332138-03462607
	32-64296A1		1	FUEL LINE, FUEL PUMP TO CARBURETOR - STEEL SERIAL 03462608-03771644
	32-65651		1	FUEL LINE, FUEL PUMP TO CARBURETOR - STEEL SERIAL 03771645-04156999
	32-69145		1	FUEL LINE, FUEL PUMP TO CARBURETOR - STEEL SERIAL 04157000-09999999
13	65406		1	BRACKET, FUEL LINE TO THERMOSTAT COVER SERIAL 03462608-03771644
14	10-52447		1	SCREW, BRACKET TO THERMOSTAT COVER (2 1/4") SERIAL 03462608-03771644
15	13-26993		1	LOCKWASHER, BRACKET TO THERMOSTAT COVER SCREW SERIAL 03462608-03771644
16	23-52095		1	SPACER, FUEL LINE SUPPORT BRACKET SERIAL 03462608-03771644
17	54-64646		2	CLIP, FUEL LINE ATTACHING SERIAL 03462608-03771644
18	10-33524		3	SCREW, CLIP ATTACHING SERIAL 03462608-03771644
19	11-46793		3	NUT, CLIP ATTACHING SCREW SERIAL 03462608-03771644

✦ = WATER PUMP GASKET SET (27-34213A2)

CONTINUED ON NEXT PAGE ➡

FUEL PUMP, FUEL FILTER AND CARBURETOR

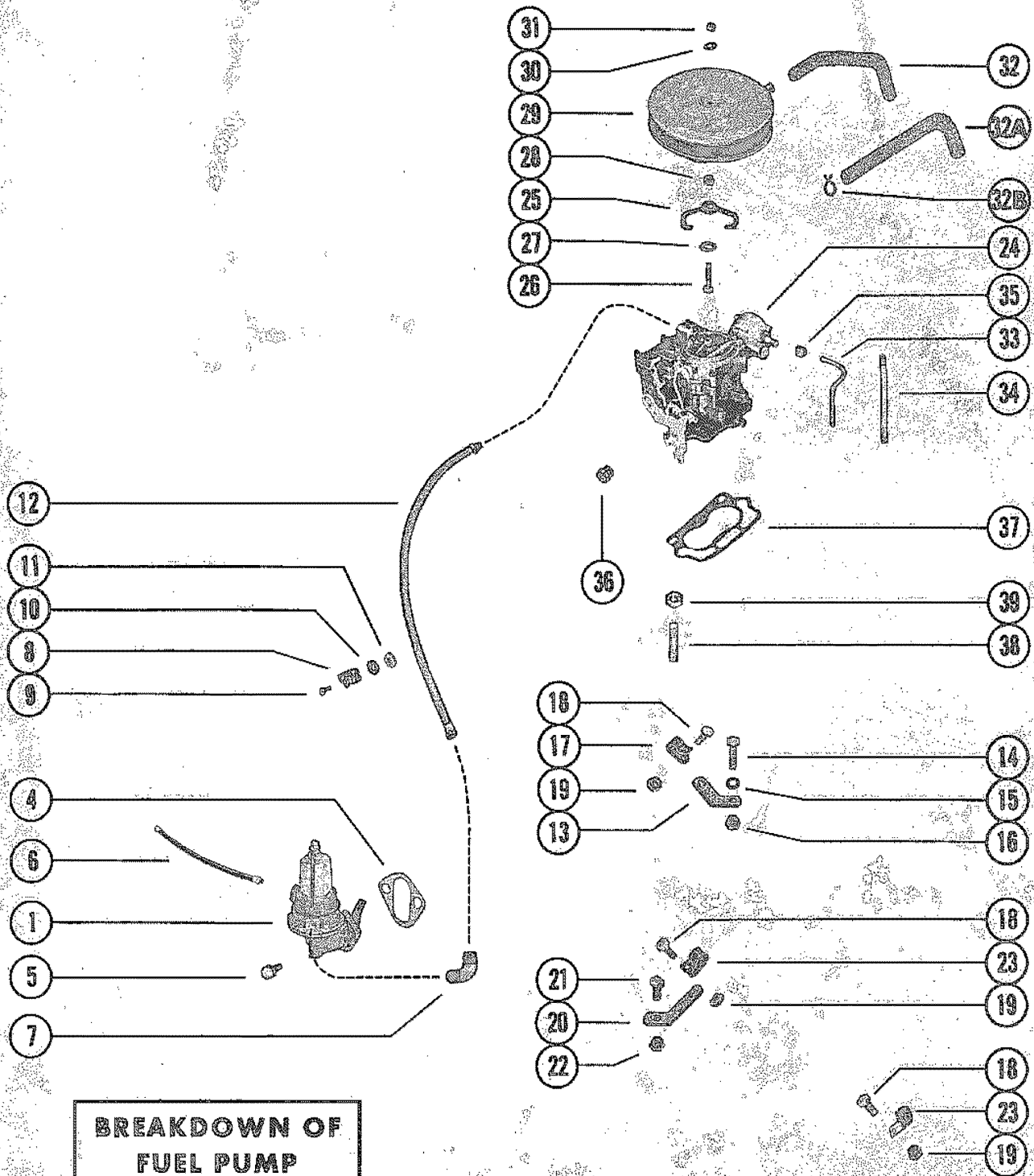

BREAKDOWN OF FUEL PUMP

- 3 — O-ring
- 2 — Fuel pump housing

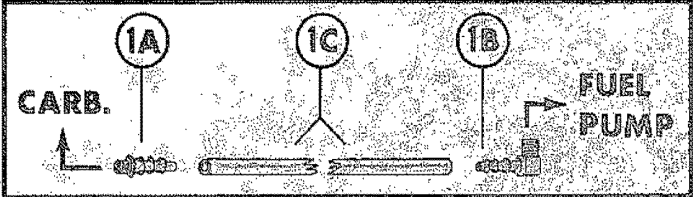

FUEL PUMP, FUEL FILTER AND CARBURETOR

REF. NO.	PART NO.	SYM.	QTY.	DESCRIPTION
20	65411		1	BRACKET, FUEL LINE TO CRANKCASE COVER SERIAL 03462608-03771644
21	10-29199		1	SCREW, BRACKET TO CRANKCASE COVER (1") SERIAL 03462608-03771644
22	11-56374		1	NUT, FUEL LINE TO CRANKCASE COVER SCREW SERIAL 03462608-03771644
23	54-61001		1	CLIP, FUEL LINE TO FRONT LIFTING EYE SERIAL 03462608-03771644
24	1351-4293A1		1	CARBURETOR ASSEMBLY SEE PAGE 11 FOR BREAKDOWN SERIAL 03332138-03771644
	1351-5203A1		1	CARBURETOR ASSEMBLY SEE PAGE 11 FOR BREAKDOWN SERIAL 03771645-09999999
25	52734		1	BAIL, FLAME ARRESTOR TO CARBURETOR NOT INCLUDED IN B-1351-5203A1 ASSEMBLY
26	10-22476		1	SCREW, FLAME ARRESTOR TO CARBURETOR BAIL (7/8") NOT INCLUDED IN B-1351-5203A1 ASSEMBLY
27	12-20533		1	WASHER, FLAME ARRESTOR SCREW NOT INCLUDED IN B-1351-5203A1 ASSEMBLY
28	11-28941		1	NUT, FLAME ARRESTOR SCREW NOT INCLUDED IN B-1351-5203A1 ASSEMBLY
29	62264		1	FLAME ARRESTOR SERIAL 00000000-04461249
	73999		1	FLAME ARRESTOR SERIAL 04461250-09999999
30	12-22937		1	WASHER, FLAME ARRESTOR MOUNTING STUD
31	11-20586		1	NUT, FLAME ARRESTOR MOUNTING STUD (TOP)
32	32-61997		1	HOSE, VENT-TO ROCKER COVER SERIAL 00000000-04481625
32A	32-62060		1	HOES, VENT - TO ROCKER COVER SERIAL 04481626-09999999
32B	54-64648		1	CLAMP, HOSE ATTACHING
33	32-53371		1	PINE, CHOKE - CARBURETOR
34	53404		1	COVERING, CHOKE PIPE
35	22-70583		1	NUT, CHOLE PIPE TO CARBURETOR
36	22-68307		1	PLUG,PIPE - CARBURETOR
37	27-64692	◆	1	GASKET, CARBURETOR TO EXHAUST MANIFOLD
38	16-33111		4	STUD, CARBURETOR MOUNTING - EXHAUST MANIFOLD (1 9/16")
39	11-29250		4	NUT, CARBURETOR MOUNTING STUD

◆ = EXHAUST MANIFOLD GASKET SET (27-53354A1)

CARBURETOR ASSEMBLY

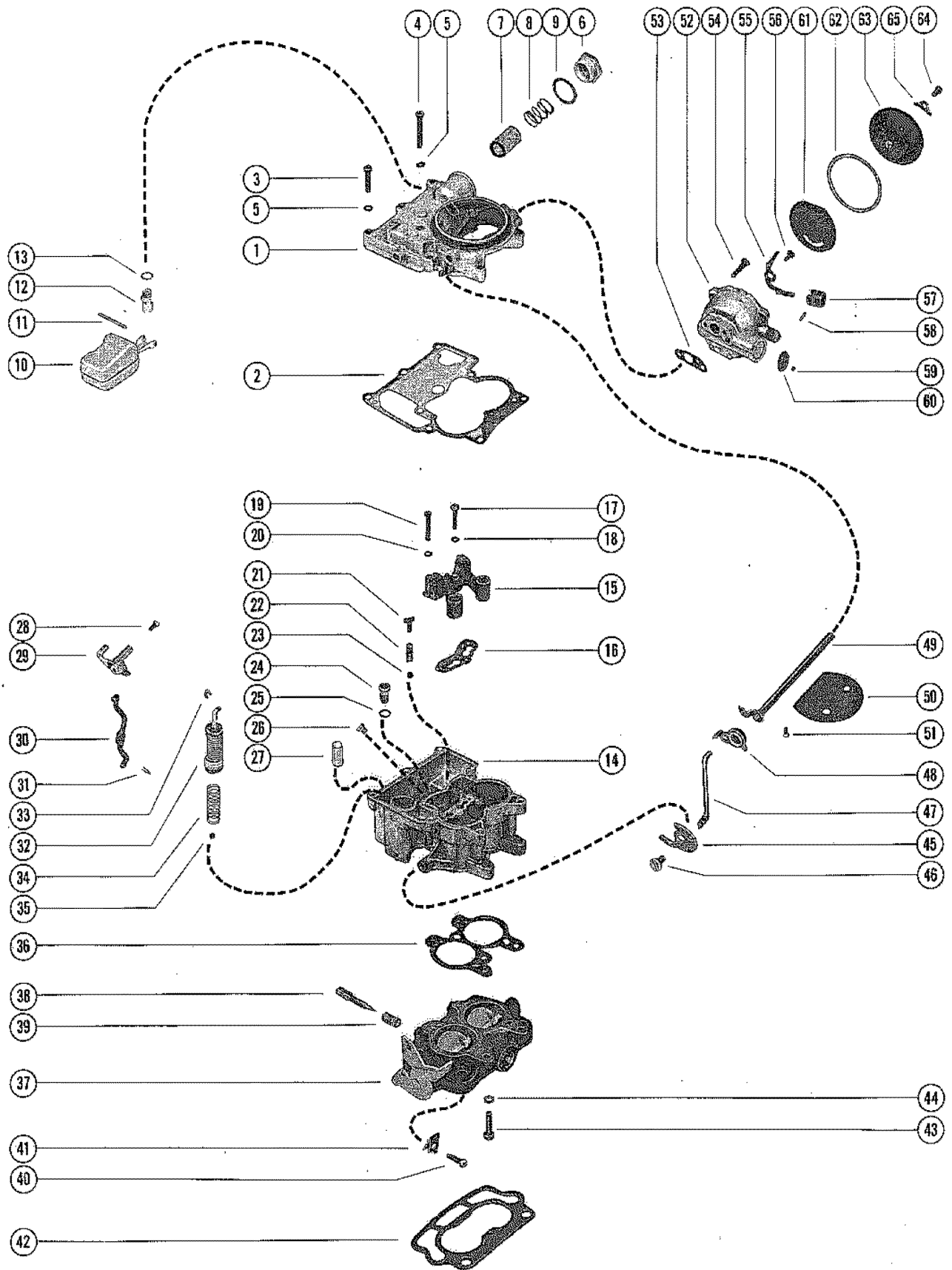

CARBURETOR ASSEMBLY

REF. NO.	PART NO.	SYM.	QTY.	DESCRIPTION
-	1351-4293A1		1	CARBURETOR ASSEMBLY, COMPLETE SERIAL 03332138-03771644
-	1351-5203A1		1	CARBURETOR ASEMBLY, COMPLETE SERIAL 03771645-09999999
1	N.S.S.		1	AIR HORN (ROCHESTER #7041370)
2			1	GASKET, AIR HORN
3	10-33043		7	SCREW, AIR HORN TO FLOAT BOWL (SHORT)
4	10-33048		1	SCREW, AIR HORN TO FLOAT BOWL (LONG)
5	13-26996		8	LOCKWASHER, AIR HORN SCREW
6	1397-4337		1	NUT, FUEL INLET SERIAL 03332138-03771644
	1397-3330		1	NUT, FUEL INLET SERIAL 03771645-09999999
7	35-53336		1	FILTER, FUEL INLET
8	24-48143		1	SPRING, FUEL FILTER
9			1	GASKET, FUEL INLET NUT
10	1397-2060		1	FLOAT ASSEMBLY
11	N.S.S.		1	PIN, HINGE - FLOAT TO AIR HORN (ROCHESTER #7002081)
12			1	INLET NEEDLE AND SEAT ASSEMBLY
13			1	GASKET, INLET NEEDLE AND SEAT
14	1397-4258		1	FLOAT BOWL ASSEMBLY
15	N.S.S.		1	VENTURI CLUSTER ASSEMBLY, FLOAT BOWL-ROCHESTER #7040911 SERIAL 03332138-03771644
	N.S.S.		1	VENTURI CLUSTER ASSEMBLY, FLOAT BOWL-ROCHESTER #7031949 SERIAL 03771645-09999999
16			1	GASKET, VENTURI CLUSTER
17	N.S.S.		1	SCREW, VENTURI CLUSTER TO FLOAT BOWL (CENTER)- ROCHESTER #7000294
18			1	GASKET, VENTURI CLUSTER SCREW (CENTER)
19	N.S.S.		2	SCREW, VENTURI CLUSTER TO FLOAT BOWL (OUTER) ROCHESTER #700 ROCHESTER #7031949
20	13-26995		2	LOCKWASHER, VENTURI CLUSTER SCREW (OUTER)
21			1	GUIDE, PUMP DISCHARGE - FLOAT BOWL
22			1	SPRING, PUMP DISCHARGE - FLOAT BOWL
23			1	BALL, PUMP DISCHARGE - FLOAT BOWL
24			1	POWER VALVE ASSEMBLY, FLOAT BOWL
25			1	GASKET, POWER VALVE
26	1397-2447		1	JET, FLOAT BOWL (STANDARD)
27			1	STRAINER, PUMP INLET
28	10-33047		1	SCREW, AIR HORN PUMP LEVER
29	N.S.S.		1	PUMP SHAFT AND LEVER ASSEMBLY, AIR HORN (ROCHESTER #7036764)
30	N.S.S.		1	ROD, PUMP (ROCHESTER #7036759)
31			1	CLIP, RETAINER - PUMP ROD
32			1	PUMP ASSEMBLY, FLOAT BOWL
33			1	CLIP, RETAINER - FLOAT BOWL PUMP
34			1	SPRING, PUMP RETURN - FLOAT BOWL

CONTINUED ON NEXT PAGE ➡

CARBURETOR ASSEMBLY

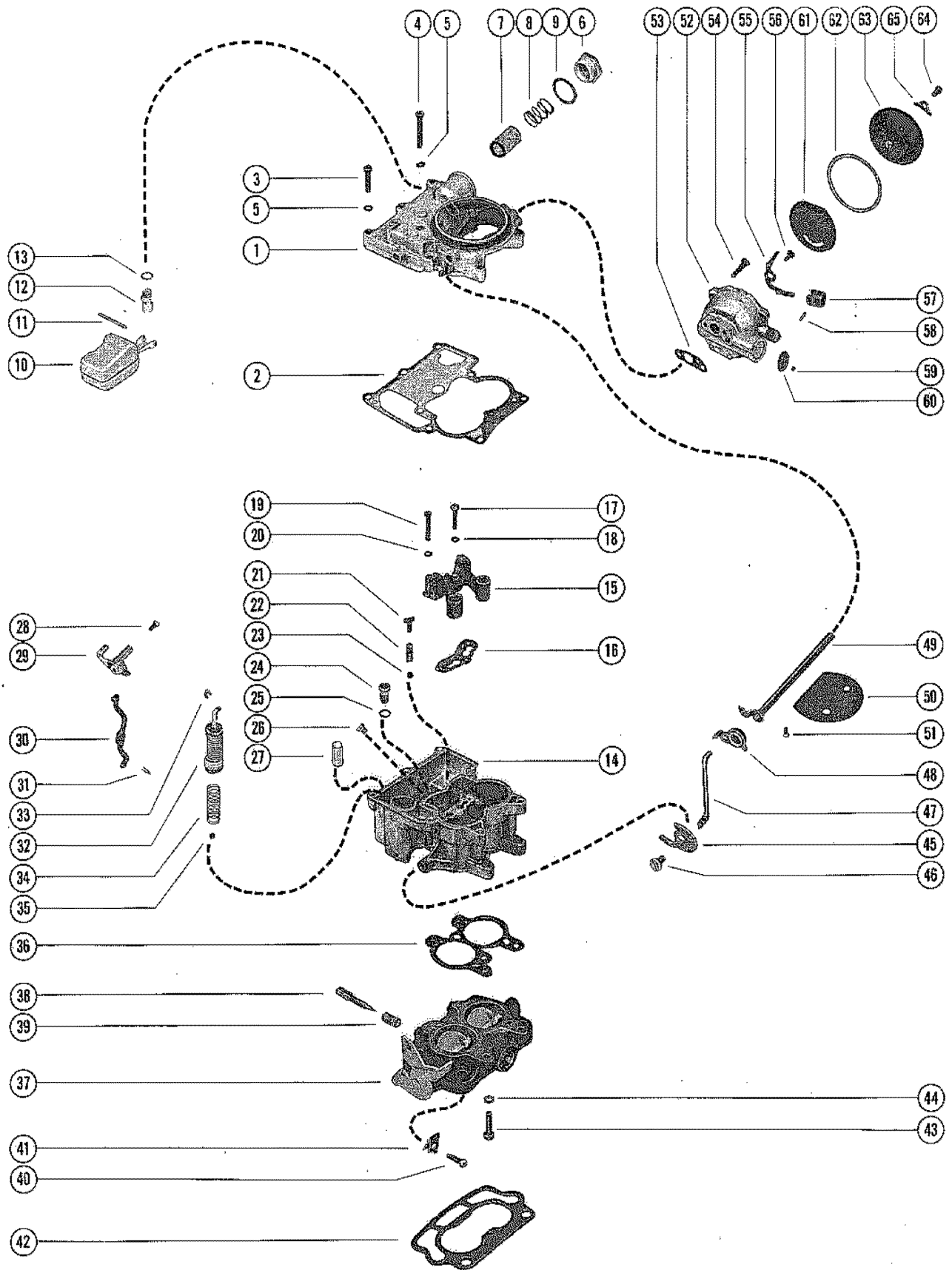

CARBURETOR ASSEMBLY

REF. NO.	PART NO.	SYM.	QTY.	DESCRIPTION
35			1	BALL, CHECK - PUMP INLET - FLOAT BOWL
36			1	GASKET, THROTTLE BODY
37	1397-2639		1	THROTTLE BODY ASSEMBLY
38			2	IDLE ADJUSTING NEEDLE THROTTLE BODY
39	24-33050		2	SPRING, IDLE ADJUSTING NEEDLE
40	1397-2638		1	IDLE STOP SCREW, THROTTLE BODY
41	54-39108		1	CLIP, IDLE STOP SCREW
42	27-32910		1	GASKET, CARBURETOR FLANGE
43	10-33052		3	SCREW, THROTTLE BODY TO FLOAT BOWL
44	13-21547		3	LOCKWASHER, THROTTLE BODY SCREW
45	1397-2071		1	CAM, FAST IDLE - FLOAT BOWL
46	10-33042		1	SCREW, FAST IDLE CAM TO FLOAT BOWL
47	N.S.S.		1	ROD, CHOKE (ROCHESTER #7025667)
48	1397-4257		1	CHOKE LEVER AND COLLAR ASSEMBLY, CHOKE SHAFT
49	1397-2632		1	CHOKE SHAFT ASSEMBLY
50	1397-43583		1	VALVE, CHOKE - CHOKE SHAFT
51	10-33045		1	SCREW, CHOKE VALVE TO CHOKE SHAFT
52	1397-2630		1	CHOKE HOUSING ASSEMBLY
53			1	GASKET, CHOKE HOUSING
54	10-33053		1	SCREW, CHOKE HOUSING TO AIR HORN
55	N.S.S.		1	LEVER ASSEMBLY, CHOKE PISTON (ROCHESTER #7010051)
56	10-33056		1	SCREW, CHOKE PISTON LEVER TO CHOKE HOUSING
57	1397-2059		1	CHOKE PISTON, CHOKE HOUSING
58	17-33049		1	PIN, CHOKE PISTON TO CHOKE PISTON LEVER
59	1397-2050		1	PLUG, BALL - CHOKE HOUSING
60	19-33041		1	WELCH PLUG, CHOKE HOUSING
61	1397-2057		1	PLATE, BAFFLE - CHOKE HOUSING
62			1	GASKET, STAT COVER AND COIL 7
63	1397-2648		1	STAT COVER AND COIL ASSEMBLY
64	10-33047		3	SCREW , STAT COVER AND COIL TO CHOKE HOUSING
65	54-33036		3	RETAINER, STAT COVER AND COIL TO CHOKE HOUSING SCREW
-	1397-2637		1	OVERHAUL KIT
-	1397-3464		1	POWER CARBURETOR KIT
-	1397-2634		1	GASKET KIT
-	1397-2992		1	ALTITUDE KIT (5,000 FT)
-	N.S.S.		1	ALTITUDE KIT (10,000 FT.)-ROCHESTER #7025962

EXHAUST MANIFOLD ASSEMBLY

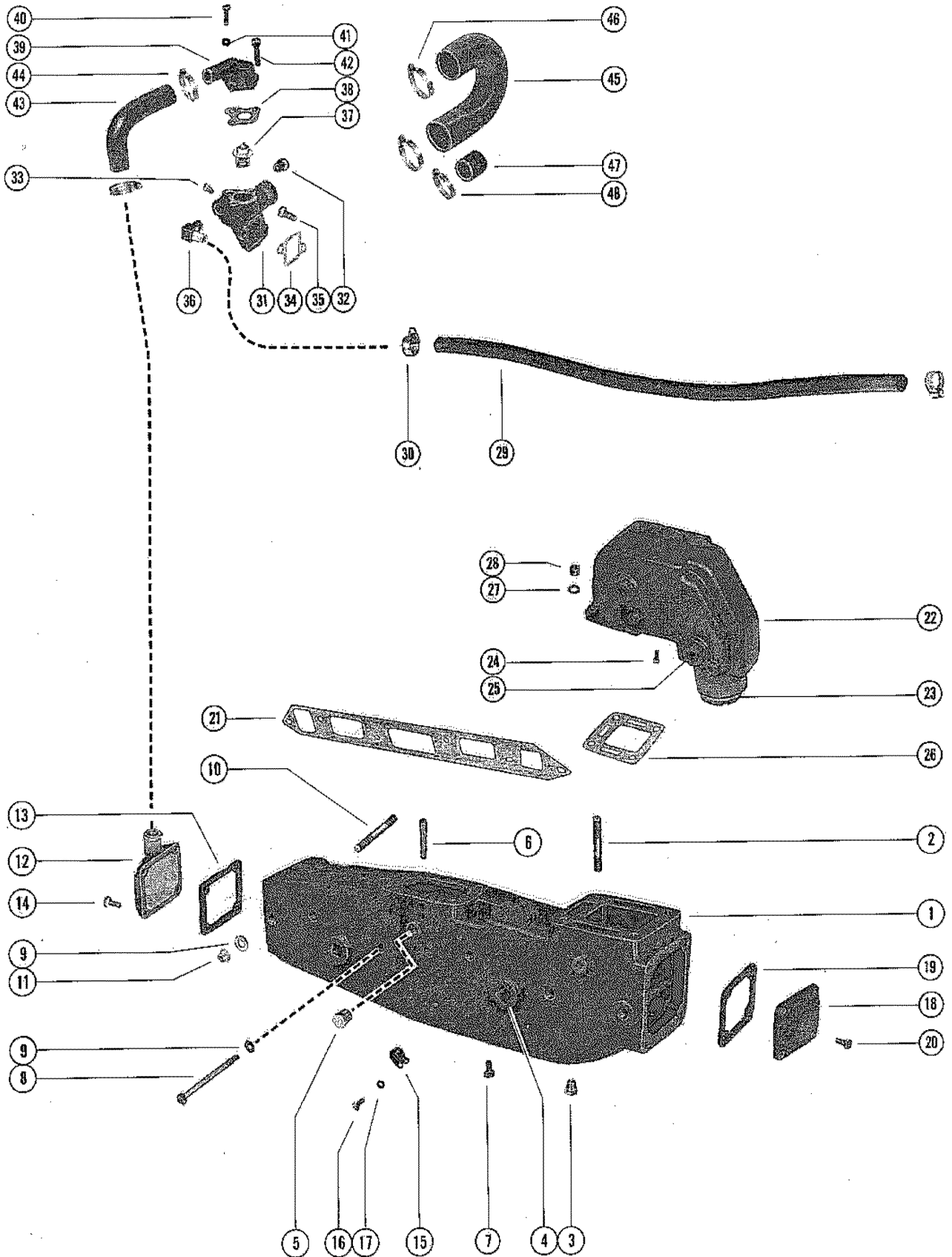

EXHAUST MANIFOLD ASSEMBLY

REF. NO.	PART NO.	SYM.	QTY.	DESCRIPTION
1	52390A1		1	EXHAUST MANIFOLD ASSEMBLY
2	16-49545		4	STUD, EXHAUST MANIFOLD TO EXHAUST ELBOW (1 3/4")
3	22-68307		1	PLUG, PIPE - EXHAUST MANIFOLD (1/8-27)
4	22-48118		1	PLUG, EXHAUST MANIFOLD
5	22-32561		1	PLUG, PIPE - EXHAUST MANIFOLD (1/4-18)
6	32-53370		1	TUBE, HEAT - EXHAUST MANIFOLD
7	10-33231		2	SCREW, PLUG - EXHAUST MANIFOLD (1/2")
8	10-52143		4	SCREW, EXHAUST MANIFOLD TO CYLINDER HEAD (4 3/4")
9	12-20553		6	WASHER, EXHAUST MANIFOLD SCREW
10	16-52093		2	STUD, EXHAUST MANIFOLD TO CYLINDER HEAD (5 1/4")
11	11-49838		2	NUT, EXHAUST MANIFOLD STUD
12	60252		1	END CAP/CONNECTOR, EXHAUST MANIFOLD (FRONT)
13	27-48043--1	◆	1	GASKET, END CAP/CONNECTOR TO EXHAUST MANIFOLD
14	10-25038		4	SCREW, END CAP/CONNECTOR TO EXH. MANIFOLD (7/8")- SERIAL 00000000-04481625
	10-24234		4	SCREW, END CAP/CONNECTOR TO EXH. MANIFOLD (1") SERIAL 04481626-09999999
15	54-60517		1	CLAMP, WIRING HARNESS TO EXHAUST MANIFOLD (3/8") SERIAL 03332138-03462607
	54-60516		1	CLAMP, WIRING HARNESS TO EXHAUST MANIFOLD (9/16") SERIAL 03332138-03462607
16	10-29240		2	SCREW, WIRING HARNESS CLAMP FASTENING (5/8") SERIAL 03332138-03462607
	10-29240		2	SCREW, WIRING HARNESS CLAMP FASTENING (5/8") SERIAL 03462608-09999999
17	12-24676		3	WASHER, WIRING HARNESS CLAMP SCREW SERIAL 03462608-09999999
18	54870		3	END CAP, EXHAUST MANIFOLD (REAR) SERIAL 00000000-04481625
	73813A1		1	END CAP, EXHAUST MANIFOLD (REAR) SERIAL 04481626-09999999
19	27-48043--1	◆	1	GASKET, END CAP TO EXHAUST MANIFOLD SERIAL 00000000-04481625
	27-73814	◆	1	GASKET, END CAP TO EXHAUST MANIFOLD SERIAL 04481626-09999999
20	10-25038		4	SCREW, END CAP TO EXHAUST MANIFOLD (7/8") SERIAL 00000000-04481625
	10-25299		4	SCREW, END CAP TO EXHAUST MANIFOLD (3/4") SERIAL 04481626-09999999
21	27-53354	■ ◆	1	GASKET, EXHAUST MANIFOLD TO CYLINDER HEAD
22	60426A1		1	EXHAUST ELBOW ASSEMBLY SERIAL 00000000-04512155
	76351A1		1	EXHAUST ELBOW ASSEMBLY SERIAL 04512156-09999999
23	32-58616A1		1	TUBE, WATER SEPERATION - EXHAUST ELBOW SERIAL 00000000-04512155
24	22-68307		1	PLUG, PIPE - EXHAUST ELBOW

■ = COMPONENT OF ENGINE/POWERHEAD GASKET SET (27-52364A2)

◆ = EXHAUST MANIFOLD GASKET SET (27-53354A1)

CONTINUED ON NEXT PAGE ➡

EXHAUST MANIFOLD ASSEMBLY

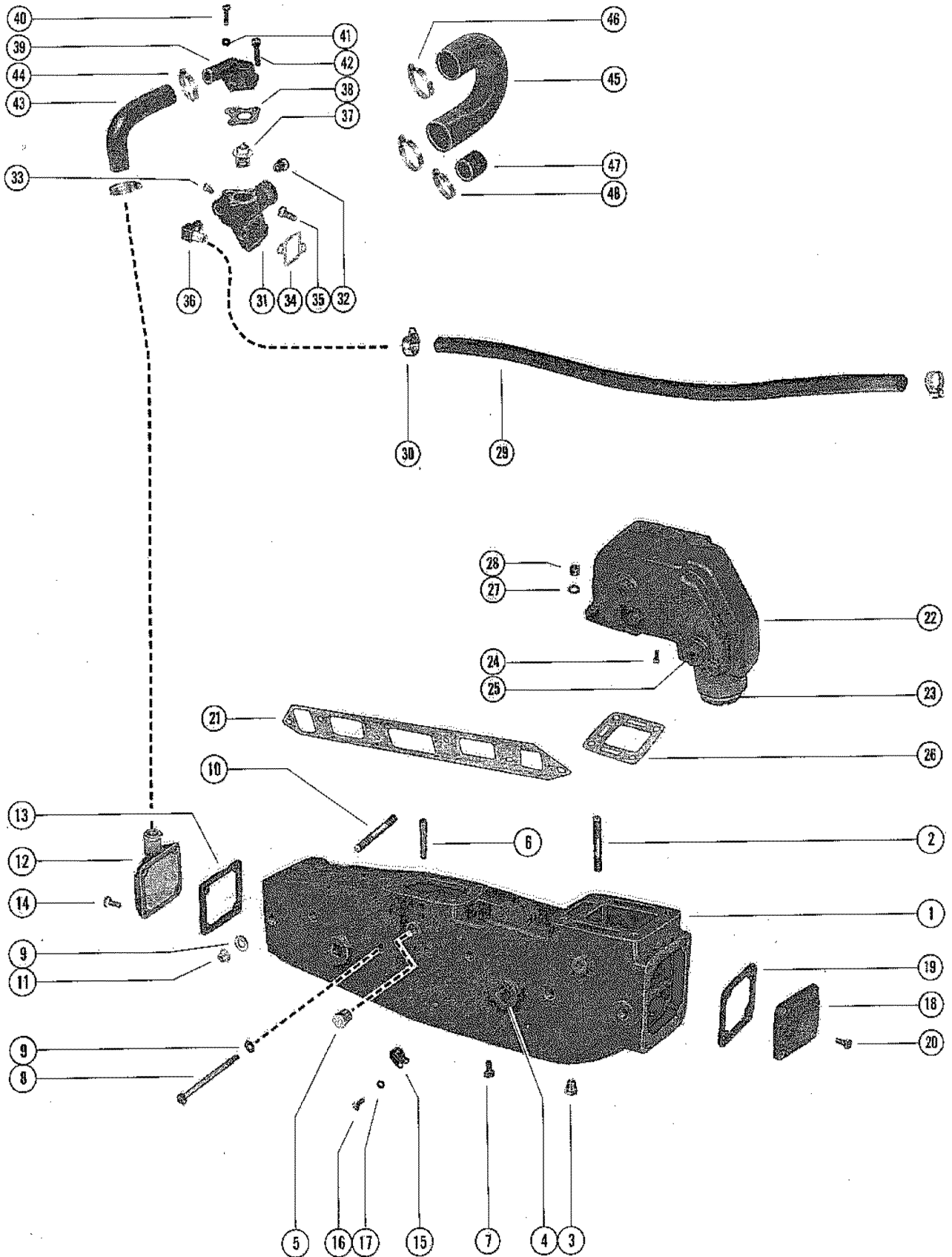

EXHAUST MANIFOLD ASSEMBLY

REF. NO.	PART NO.	SYM.	QTY.	DESCRIPTION
25	22-33198		4	PLUG, EXHAUST ELBOW
26	27-99777--2	◆	1	GASKET, EXHAUST ELBOW TO EXHAUST MANIFOLD
27	13-37459		4	LOCKWASHER, EXHAUST ELBOW TO EXHAUST MANIFOLD STUD
28	11-49838		4	NUT, EXHAUST ELBOW TO EXHAUST MANIFOLD STUD
29	32-47642		1	HOSE ASSEMBLY, INLET - WATER DISTRIBUTION BLOCK TO DRIVE UNI
30	54-32523		2	CLAMP, INLET HOSE TO WATER DISTRIBUTION BLOCK AND DRIVE UNIT
31	47587A2		1	BLOCK ASSEMBLY, WATER DISTRIBUTION - CYLINDER HEAD SERIAL 03332138-03462607
32	22-32803		1	PLUG, PIPE - WATER DISTRIBUTION BLOCK SERIAL 03332138-03462607
33	22-68307		1	PLUG, PIPE - WATER DISTRIBUTION BLOCK SERIAL 03332138-03462607
31	63908A2		1	BLOCK ASSEMBLY, WATER DISTRIBUTION SERIAL 03462608-09999999
33	22-68307		2	PLUG, PIPE - WATER DISTRIBUTION BLOCK SERIAL 03462608-09999999
34	27-814680	■	1	GASKET, WATER DISTRIBUTION BLOCK
35	10-21077		2	SCREW, WATER DISTRIBUTION BLOCK TO CYLINDER HEAD (7/8")
36	22-53509		1	ELBOW, WATER DISTRIBUTION BLOCK
37	59078		1	THERMOSTAT
38	27-47590	◆	1	GASKET, THERMOSTAT COVER
39	60372A1		1	COVER ASSEMBLY, THERMOSTAT - WATER DISTRIBUTION BLOCK
40	10-60374		2	SCREW, THERMOSTAT COVER ATTACHING (1 3/4")
41	12-36533		1	WASHER, THERMOSTAT COVER SCREW
42	10-52447		1	SCREW, THERMOSTAT COVER ATTACHING (2 1/4") SERIAL 03462608-03771644
43	32-52481		1	HOSE, WATER DISTRIBUTION BLOCK TO END CAP/CONNECTOR
44	54-32780		2	CLAMP, HOSE TO WATER DISTRIBUTION BLOCK AND END CAP/CONNECTO
45	32-47640		1	HOSE, WATER DISTRIBUTION BLOCK TO WATER PUMP
46	54-32781		2	CLAMP, HOSE TO WATER DISTRIBUTION BLOCK AND WATER PUMP
47	32877		1	COVER, WATER PUMP SERIAL # THRU SERIAL 03332138-03462607
48	54-38426		1	CLAMP, WATER PUMP COVER TO WATER PUMP SERIAL 03332138-03462607

■ = COMPONENT OF ENGINE/POWERHEAD GASKET SET (27-52364A2)

◆ = EXHAUST MANIFOLD GASKET SET (27-53354A1)

FLYWHEEL HOUSING AND ENGINE SUPPORT

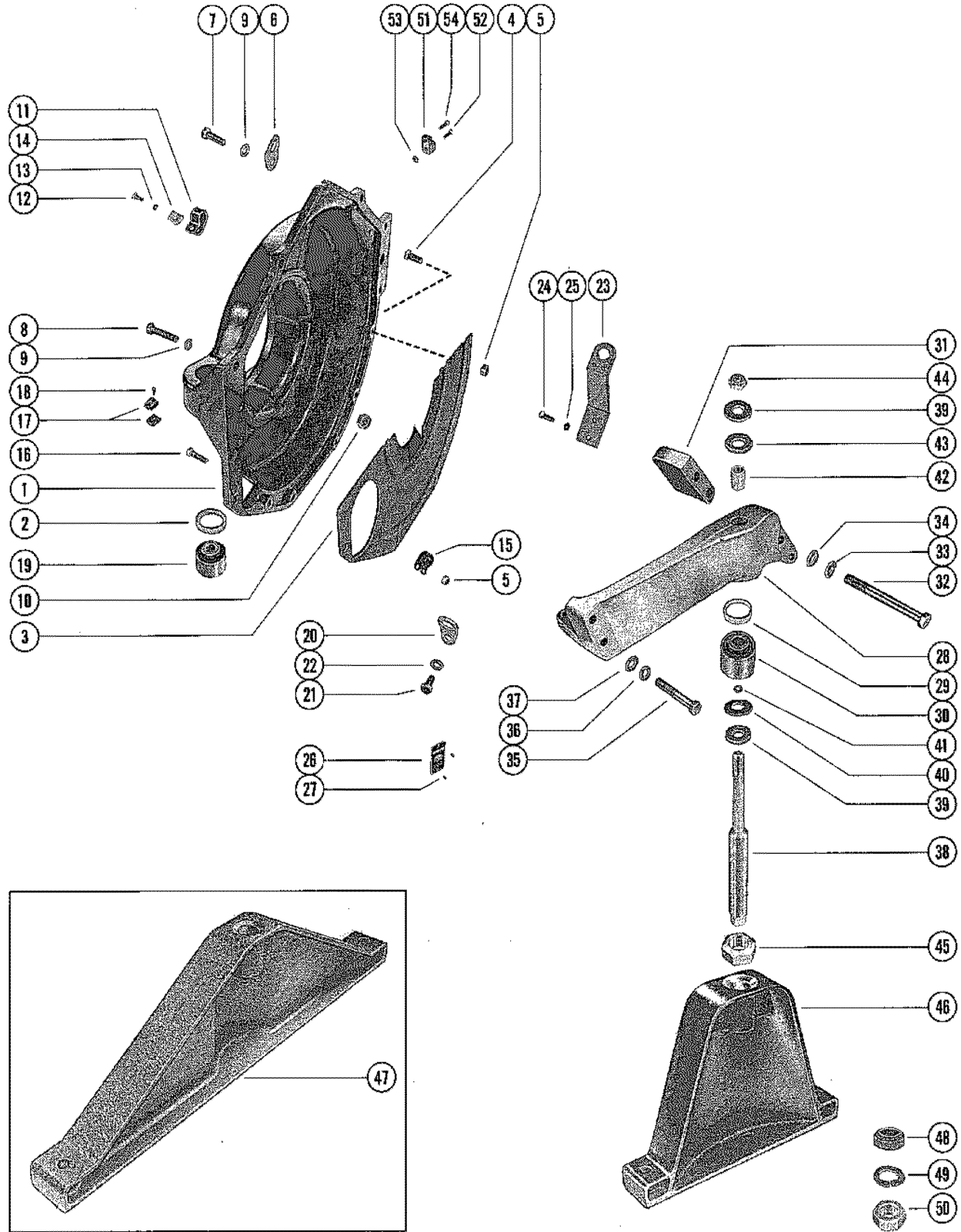

FLYWHEEL HOUSING AND ENGINE SUPPORT

REF. NO.	PART NO.	SYM.	QTY.	DESCRIPTION
1	55898A3		1	FLYWHEEL HOUSING ASSEMBLY, REAR MOUNTING SERIAL 00332138-03462607
	65059A1		1	FLYWHEEL HOUSING ASSEMBLY, REAR MOUNTING SERIAL 03462608-09999999
2	23-46742		2	SPACER, FLYWHEEL HOUSING MOUNT
3	35864		1	COVER PLATE, FLYWHEEL HOUSING
4	10-47277		6	SCREW, COVER PLATE TO FLYWHEEL HOUSING (3/4")
5	11-46793		6	NUT, COVER PLATE SCREW
6	54-72531		1	EYE, LIFTING - FLYWHEEL HOUSING SCREW
7	10-26632		5	SCREW, FLYWHEEL HOUSING TO CYLINDER BLOCK (1/4")
8	10-34613		1	SCREW, FLYWHEEL HOUSING TO CYLINDER BLOCK (1 3/4")
9	13-37459		6	LOCKWASHER, BRACKET AND FLYWHEEL HOUSING SCREW
10	11-28517		1	NUT, BRACKET AND FLYWHEEL HOUSING SCREW
11	54-24871		1	CLAMP, WIRING HARNESS TO FLYWHEEL HOUSING SERIAL 03332138-03462607
12	10-22028		1	SCREW, WIRING HARNESS CLAMP ATTACHING SERIAL 03332138-03462607
13	13-26996		1	LOCKWASHER, WIRING HARNESS CLAMP SCREW SERIAL 03332138-03462607
14	22789		1	"C" WASHER, WIRING HARNESS CLAMP SERIAL 03332138-03462607
15	54-61001		1	CLIP, WIRING HARNESS TO FLYWHEEL SERIAL 03462608-09999999
16	10-26065		1	SCREW, WIRING HARNESS CLIP TO COVER PLATE (1") SERIAL 03462608-09999999
17	39974		4	CONNECTOR, HARNESS LEADS TO FLYWHEEL HOUSING SERIAL 03332138-03462607
18	10-47618		4	SCREW, CONNECTOR TO FLYWHEEL HOUSING (1") SERIAL 03332138-03462607
17	39974		2	CONNECTOR, HARNESS LEADS TO FLYWHEEL HOUSING SERIAL 03462608-03771644
18	10-37892		2	SCREW, CONNECTOR TO FLYWHEEL HOUSING (1") SERIAL 03462608-03771644
19	32832		1	MOUNT, FLYWHEEL HOUSING (LEFT)
	33149		1	MOUNT, FLYWHEEL HOUSING (RIGHT)
20	54-34764		1	EYE, LIFTER - CYLINDER BLOCK SERIAL 03332138-03462607
21	10-27165		1	SCREW, LIFTING EYE TO CYLINDER BLOCK SERIAL 03332138-03462607
22	13-37459		1	LOCKWASHER, LIFTING EYE SCREW SERIAL 03332138-03462607
23	67850		1	EYE, LIFTING - CYLINDER BLOCK SERIAL 03462608-09999999
24	10-54528		2	SCREW, LIFTING EYE TO CYLINDER BLOCK SERIAL 03462608-09999999
25	13-35364		2	LOCKWASHER, LIFTING EYE SCREW SERIAL 03462608-09999999
26	38-31042		1	SERIAL PLATE
27	10-28642		2	SCREW, DRIVE - SERIAL PLATE TO CYLINDER BLOCK

CONTINUED ON NEXT PAGE ➡

FLYWHEEL HOUSING AND ENGINE SUPPORT

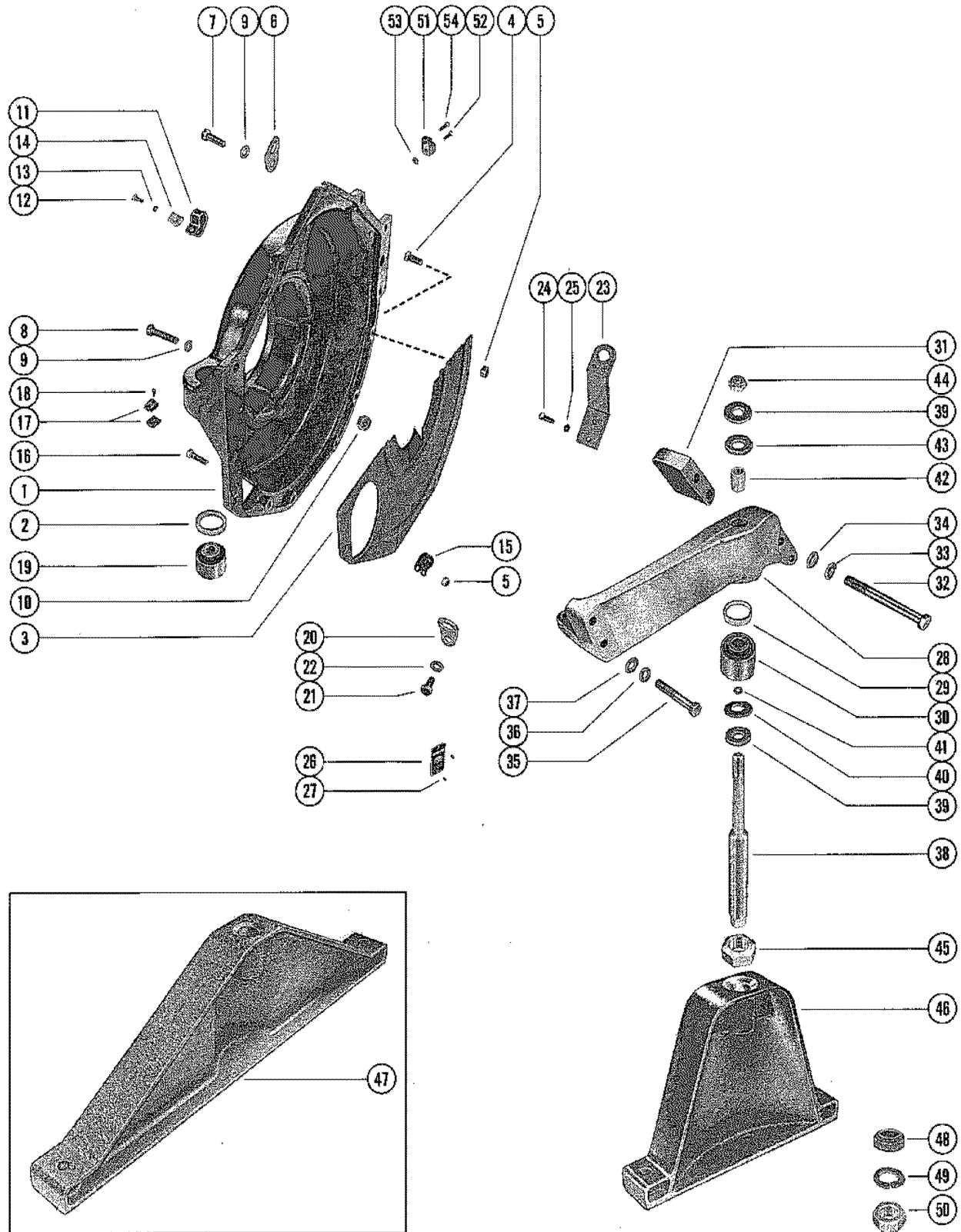

FLYWHEEL HOUSING AND ENGINE SUPPORT

REF. NO.	PART NO.	SYM.	QTY.	DESCRIPTION
28	36099A2		1	BRACKET ASSEMBLY, FRONT MOUNTING SERIAL 0000000-04461249
	73571A2		1	BRACKET ASSEMBLY, FRONT MOUNTING SERIAL 04461250-09999999
29	23-35903		1	SPACER, FRONT MOUNTING BRACKET
30	32833		1	MOUNT, FRONT MOUNTING BRACKET
31	35862		1	BLOCK, SPACER - FRONT MOUNTING BRACKET
32	10-32557		2	SCREW, BRACKET AND SPACER BLOCK TO CYLINDER BLOCK (4 1/2")
33	13-32993		2	LOCKWASHER, BRACKET AND SPACER BLOCK SCREW
34	12-22248		2	WASHER, BRACKET AND SPACER BLOCK SCREW
35	10-26486		2	SCREW, FRONT MOUNTING BRACKET TO CYLINDER BLOCK (2 3/8")
36	13-37459		2	LOCKWASHER, FRONT MOUNTING SCREW
37	12-34931		2	WASHER, FRONT MOUNTING BRACKET SCREW
38	16-36100		1	STUD, ADJUSTING - FRONT MOUNTING BRACKET
39	12-36103		2	WASHER, FRONT MOUNTING BRACKET ADJUSTING STUD
40	12-32638		1	WASHER, FRONT MOUNTING BRACKET ADJUSTING STUD
41	12-20959		1	WASHER, FRONT MOUNTING BRACKET ADJUSTING STUD
42	23-36101		1	SPACER, FRONT MOUNTING BARACKET ADJUSTING STUD
43	12-36104		1	WASHER, RUBBER - FRONT MOUNTING BRACKET ADJUSTING STUD
44	11-20220		1	NUT, FRONT MOUNTING BRACKET ADJUSTING STUD (TOP)
45	11-32882		1	NUT, FRONT MOUNTING BRACKET ADJUSTING STUD
46	32778		1	SUPPORT, FRONT - ENGINE MOUNT
47	32849		OPT.	SUPPORT, FRONT - ENGINE MOUNT
48	23-33064		1	SLEEVE, FRONT MOUNTING BRACKET ADJUSTING STUD
49	13-33065		1	LOCKWASHER, FRONT MOUNTING BRACKET STUD (BOTTOM)
50	11-47525		1	NUT, JAM - FRONT MOUNTING BRACKET ADJUSTING STUD (BOTTOM)
51	45915		1	TERMINAL BLOCK SERIAL 04461250-09999999
52	10-20189		1	SCREW, TERMINAL BLOCK TO FLYWHEEL HOUSING (3/4") SERIAL 04461250-09999999
53	11-27164		1	NUT, TERMINAL BLOCK SCREW SERIAL 04461250-09999999
54	10-30663		1	SCREW, ROTARY TRIM SENDER LEADS SERIAL 04461250-09999999

CYLINDER BLOCK, PISTON AND BEARINGS

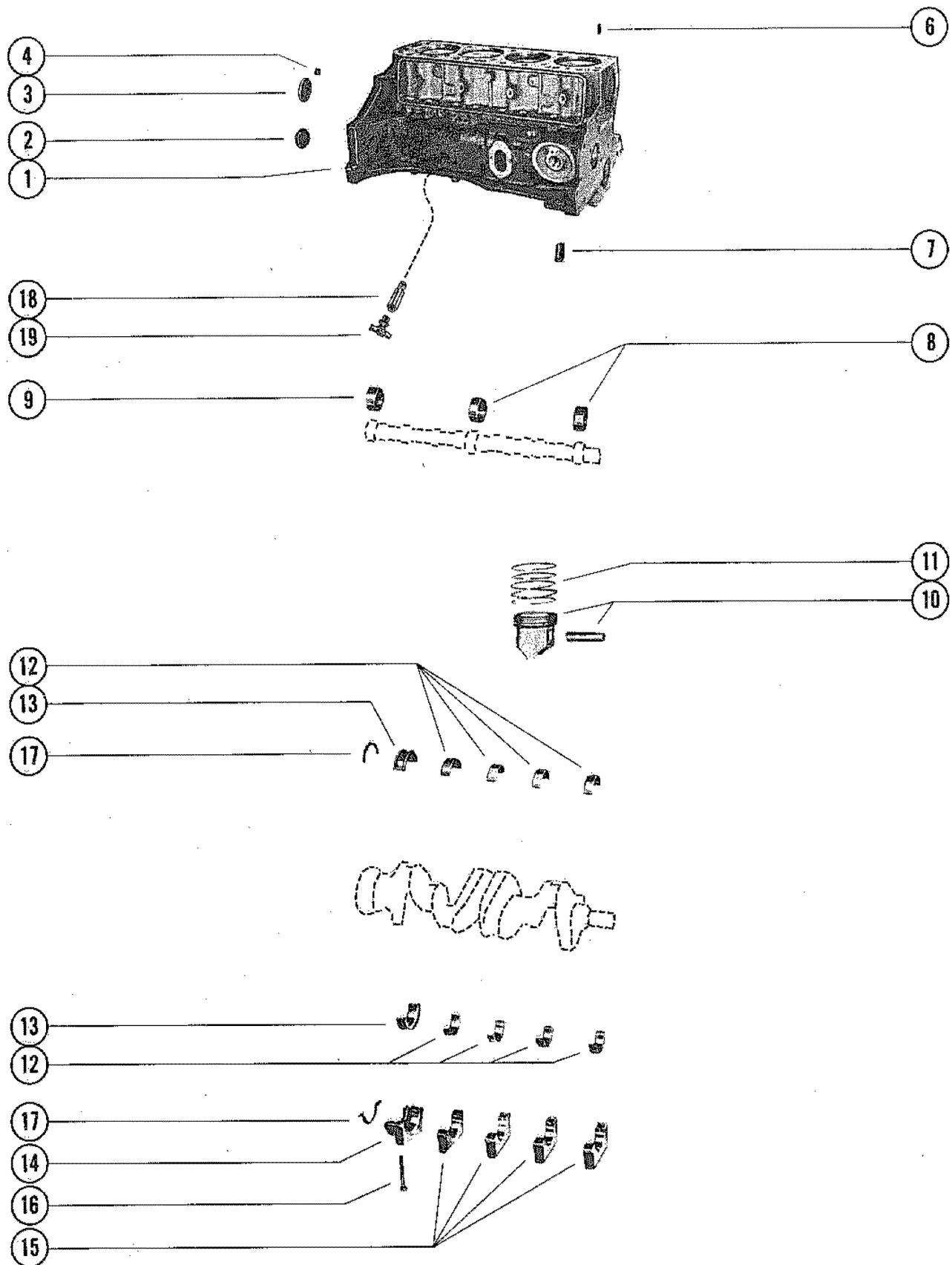

CYLINDER BLOCK, PISTON AND BEARINGS

REF. NO.	PART NO.	SYM.	QTY.	DESCRIPTION
1	839-3814		1	CYLINDER BLOCK ASSEMBLY (SEE NOTE BELOW)
2	19-34270		2	PLUG, EXPANSION - CYLINDER BLOCK (1 5/8" DIA.)
	19-34271		1	PLUG, EXPANSION - CYLINDER BLOCK (2" DIA.)
-	19-37531		1	PLUG, OIL CHANNEL - CYLINDER BLOCK
3	19-34488		1	PLUG, EXPANSION - CAMSHAFT BEARING HOLE
4	19-34487		1	PLUG, PIPE - CYLINDER BLOCK (3/8")
6	17-35465		2	PIN, DOWEL - CYLINDER BLOCK TO CYLINDER HEAD
7	23-35168		1	BEARING, DISTRIBUTOR PILOT SHAFT
8 & 9			1	BEARING, CAMSHAFT (SEE M/C SERVICE BULLETIN 83-19)
10	733-3819		4	PISTON AND PISTON PIN ASSEMBLY (STANDARD)
	733-3818		AR	PISTON AND PISTON PIN ASSEMBLY (.020 O.S.)
11	39-65153		4	RING, PISTON - 4 SETS (STANDARD)
	39-67125		AR	RING, PISTON - 4 SETS (.020 O.S.) SERIAL 03332138-00346207
	39-66217		AR	RING, PISTON - 4 SETS (.020 O.S.) SERIAL 03462608-09999999
12	23-52256		4	BEARING UNIT, CRANKSHAFT MAIN (STANDARD)
	23-52257		AR	BEARING UNIT, CRANKSHAFT MAIN (.001 U.S.)
	23-52258		AR	BEARING UNIT, CRANKSHAFT MAIN (.002 U.S.)
	23-52259		AR	BEARING UNIT, CRANKSHAFT MAIN (.010 U.S.)
	23-52260		AR	BEARING UNIT, CRANKSHAFT MAIN (.020 U.S.)
13	23-52261		1	BEARING UNIT, CRANKSHAFT MAIN - REAR (STANDARD)
	23-52262		AR	BEARING UNIT, CRANKSHAFT MAIN - REAR (.001 U.S.)
	23-52263		AR	BEARING UNIT, CRANKSHAFT MAIN - REAR (.002 U.S.)
	23-52264		AR	BEARING UNIT, CRANKSHAFT MAIN - REAR (.010 U.S.)
	23-52265		AR	BEARING UNIT, CRANKSHAFT MAIN - REAR (.020 U.S.)
14	49954		1	CAP, REAR - CRANKSHAFT BEARING
15	35310		4	CAP, INTERMEDIATE AND FRONT - CRANKSHAFT BEARING
16	10-46717		10	BOLT, CRANKSHAFT BEARING CAP TO CYLINDER BLOCK (2 31/32")
	16-48350		1	STUD, OIL PUMP SCREEN SUPPORT TO BEARING CAP
17	26-58203		1	OIL SEAL UNIT, CRANKSHAFT REAR BEARING
-	34543		1	VALVE, BY-PASS - OIL FILTER
18	22-64425		1	FITTING, EXTENSION - CYLINDER BLOCK
19	22-64426		1	FITTING, DRAIN - CYLINDER BLOCK

CAMSHAFT, CRANKSHAFT AND WATER PUMP

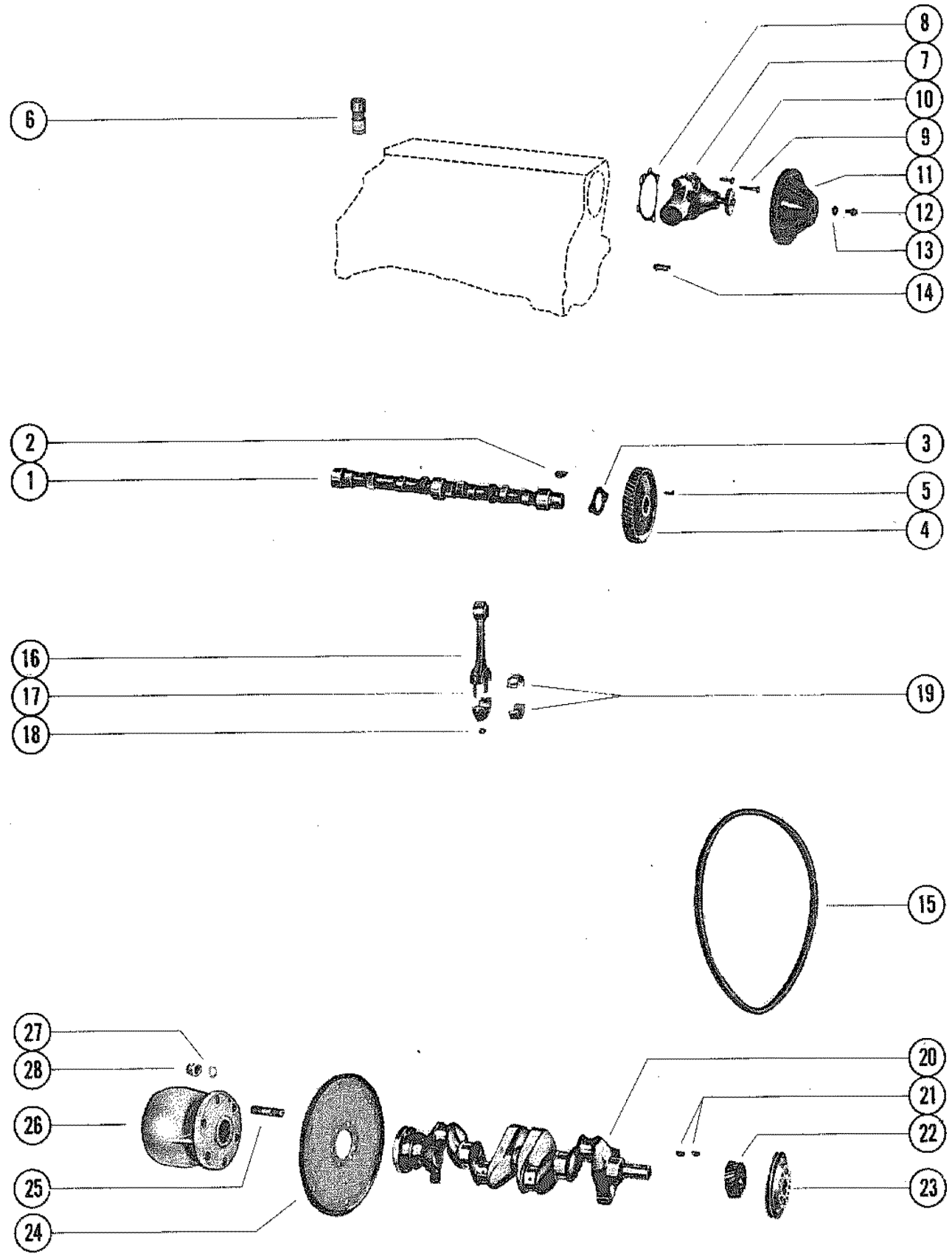

CAMSHAFT, CRANKSHAFT AND WATER PUMP

REF. NO.	PART NO.	SYM.	QTY.	DESCRIPTION
1	424-3864		1	CAMSHAFT
2	28-34466		1	KEY, CAMSHAFT GEAR LOCATING
3	23-34469		1	BEARING, CAMSHAFT THRUST
4	43-58283		1	GEAR, TIMING - CAMSHAFT
5	10-21417A1		2	SCREW, TIMING GEAR TO CAMSHAFT (1/2")
6	46744		8	LIFTER, HYDRAULIC - TAPPET
7	65142		1	WATER PUMP ASSEMBLY SERIAL 03332138-03462607
	52353		1	WATER PUMP ASSEMBLY SERIAL 03462608-09999999
8	27-33956	‡	1	GASKET, WATER PUMP
9	10-34471		2	SCREW, WATER PUMP TO CYLINDER BLOCK (1 1/2")
10	10-34505		2	SCREW, WATER PUMP TO CYLINDER BLOCK (7/8")
11	52349		1	PULLEY, WATER PUMP
12	10-47277		4	SCREW, PULLEY TO WATER PUMP (3/4")
13	13-39107		4	LOCKWASHER, PULLEY SCREW
14	32-46471		1	NOZZLE, OIL - TIMING GEAR
15	57-32850		1	BELT, ALTERNATOR AND WATER PUMP SERIAL 03332138-03462607
	57-64032		1	BELT, ALTERNATOR AND WATER PUMP SERIAL 03462608-09999999
16	613-3817		4	CONNECTING ROD ASSEMBLY
17	10-52269		8	BOLT, CONNECTING ROD BEARING CAP
18	11-37493		8	NUT, CONNECTING ROD CAP BOLT
19	23-52221		4	BEARING(PAIR), CONN. ROD(STANDARD)
	23-52222		AR	BEARING(PAIR), CONN. ROD(.001 U.S.)
	23-52223		AR	BEARING(PAIR), CONN. ROD(.002 U.S.)
	23-52224		AR	BEARING(PAIR), CONN. ROD(.010 U.S.)
	23-52225		AR	BEARING(PAIR), CONN. ROD(020 U.S.)
20	423-3816		1	CRANKSHAFT
21	28-34466		2	KEY, PULLEY AND GEAR LOCATING
22	43-46743		1	GEAR, TIMING - CRANKSHAFT
23	55045		1	BALANCER, HARMONIC
24	220-2282		1	FLYWHEEL, CRANKSHAFT
25	16-32808		6	STUD, FLYWHEEL TO ENGINE COUPLING (2 1/16")
26	32492A5		1	ENGINE COUPLING ASSEMBLY
27	12-35935		6	WASHER, FLYWHEEL STUD
28	11-34933		6	NUT, FLYWHEEL STUD

‡ = WATER PUMP GASKET SET (27-34213A2)

CYLINDER HEAD AND ROCKER COVER

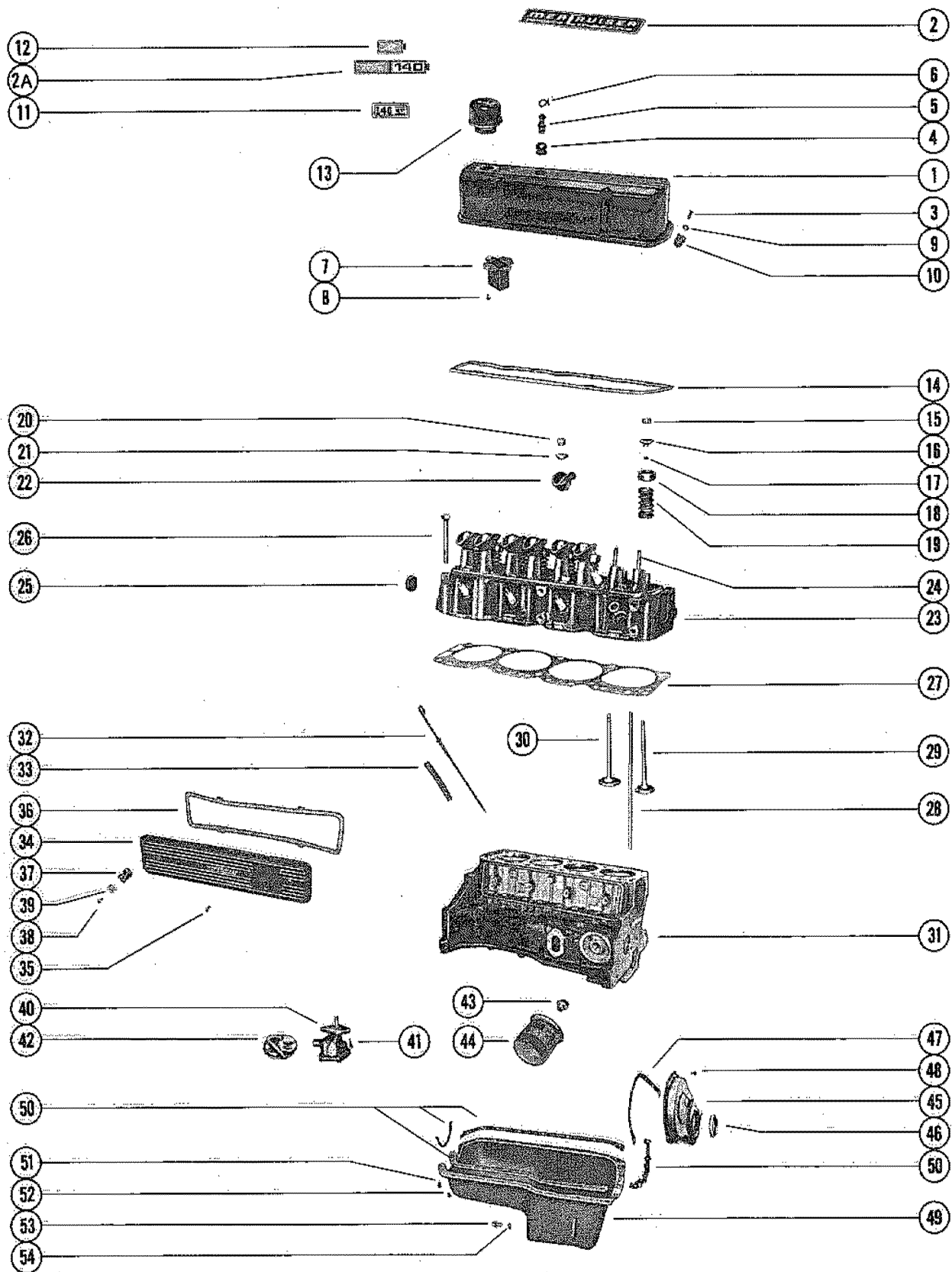

CYLINDER HEAD AND ROCKER COVER

REF. NO.	PART NO.	SYM.	QTY.	DESCRIPTION
1	62234A2		1	COVER ASSEMBLY, ROCKER SEE NOTE SERIAL 03332138-03462607
	65635		1	COVER ASSEMBLY, ROCKER SERIAL 03462608-09999999
2	37-55541		1	DECAL, ROCKER COVER SERIAL 00000000-04648609
2A	37-77247		1	DECAL, ROCKER COVER SERIAL 04648610-09999999
3	10-35585		5	SCREW, ROCKER COVER TO CYLINDER HEAD (3/4")
	10-38627		2	SCREW, ROCKER COVER TO CYLINDER HEAD (5/8")
4	25-52188		1	GROMMET, ROCKER COVER
5	47957		1	CONNECTOR, VENT HOSE
6	54-64648		1	CLAMP, VENT HOSE TO CONNECTOR
7	57638		1	BAFFLE, ROCKER COVER
8	10-62568		4	SCREW, BAFFLE TO ROCKER COVER (3/8")
9	12-20583		5	WASHER, ROCKER COVER SCREW
10	54-46721		2	CLIP, ROCKER COVER SCREW SERIAL 04648610-03462607
	54-49542		1	CLAMP, INLET HOSE - ROCKER COVER SCREW
11	37-55539		1	DECAL, ROCKER COVER - "140 H.P." SERIAL 00000000-04648609
12	37-77253		1	DECAL, WAVES SERIAL 04648610-09999999
13	49288		1	OIL FILLER CAP ASSEMBLY, ROCKER COVER
14	27-806452	■	1	GASKET, ROCKER COVER TO CYLINDER HEAD
15	28-54797		8	KEY, VALVE STEM (2 PER VALVE)
16	34515		8	CAP, VALVE STEM
17	26-34217	■	8	SEAL, VALVE SPRING CAP
18	34518		8	SHIELD, VALVE SPRING CAP
19	24-35214		8	SPRING, VALVE
20	11-34516		8	NUT, ROCKER VALVE ARM STUD
21	59340		8	BALL UNIT, ROCKER VALVE ARM STUD
22	34519		8	ARM, ROCKER VALVE
23	936-5544		1	CYLINDER HEAD ASSEMBLY
24	16-34521		AR	STUD, VALVE ROCKER ARM (.013 O.S.)
	16-35422		AR	STUD, VALVE ROCKER ARM (.003 O.S.)
25	19-34272		2	PLUG, EXPANSION - CYLINDER HEAD (15/16" DIA.)
26	10-34510		10	BOLT, CYLINDER HEAD TO CYLINDER BLOCK
27	27-52364	■	1	GASKET, CYLINDER HEAD TO CYLINDER BLOCK
28	58284		8	ROD, PUSH - VALVE
29	52365		4	VALVE, INLET (STANDARD STEM)
	52366		AR	VALVE, INLET (.015 O.S. STEM)
30	52367		4	VALVE, EXHAUST (STANDARD STEM)
	52368		AR	VALVE, EXHAUST (.015 O.S. STEM)
31	839-3814		1	CYLINDER BLOCK ASSEMBLY SEE PAGE 18 FOR BREAKDOWN

■ = COMPONENT OF ENGINE/POWERHEAD GASKET SET (27-52364A2)

OIL PAN, OIL PUMP AND CRANKCASE COVER

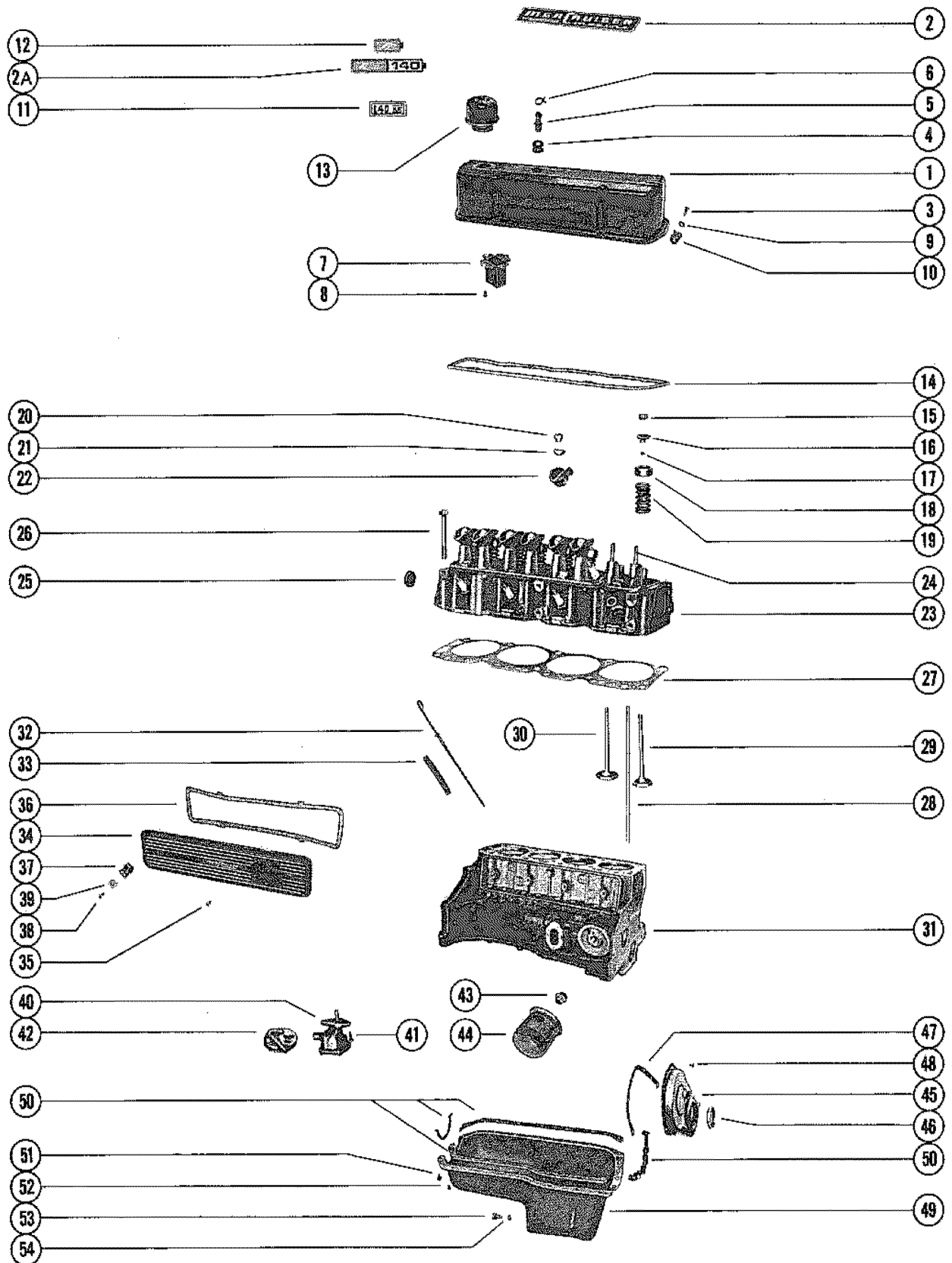

OIL PAN, OIL PUMP AND CRANKCASE COVER

REF. NO.	PART NO.	SYM.	QTY.	DESCRIPTION
32	45490		1	GAUGE ASSEMBLY, OIL LEVEL (DIP STICK)
33	32-37291		1	TUBE, OIL LEVEL GAUGE
34	39332A1		1	COVER ASSEMBLY, PUSH ROD
35	10-39783		4	SCREW, PUSH ROD TO CYLINDER BLOCK
36	27-34208	■	1	GASKET, PUSH ROD COVER
37	54-53883		1	CLIP, WIRING HARNESS TO PUSH ROD COVER SERIAL 03332138-03462607
38	10-62568		1	SCREW, WIRING HARNESS CLIP ATTACHED SERIAL 03332138-03462607
39	12-20583		1	WASHER, HARNESS CLIP SCREW SERIAL 03332138-03462607
40	36405		1	OIL PUMP ASSEMBLY
-	27-34460		1	GASKET, OIL PUMP COVER
41	10-35339		2	SCREW, OIL PUMP TO CYLINDER BLOCK (3/4")
42	52146		1	SCREEN ASSEMBLY, OIL PUMP
-	10-35366		1	SCREW, OIL PUMP SCREEN SUPPORT CLAMPING
-	60717		1	SUPPORT, OIL PUMP
43	32720		1	CONNECTOR, OIL FILTER TO CYLINDER BLOCK
44	54111		1	OIL FILTER ASSEMBLY
45	59341		1	COVER ASSEMBLY, CRANKCASE
46	26-59342		1	OIL SEAL, CRANKCASE COVER
47	27-49953	⊕	1	GASKET, CRANKCASE COVER
48	10-34277		8	SCREW, COVER TO CYLINDER BLOCK (7/16") SERIAL 03332138-03462607
	10-34277		7	SCREW, COVER TO CYLINDER BLOCK (7/16") SERIAL 03462608-03771645
	10-29179		1	SCREW, COVER TO CYLINDER BLOCK (1") SERIAL 03462608-03771644
49	52583A1		1	OIL PAN ASSEMBLY
50	27-52144		1	GASKET SET, OIL PAN
51	10-49950		12	SCREW, OIL PAN TO CYLINDER BLOCK (1/4")
52	10-34500		6	SCREW, OIL PAN TO CYLINDER BLOCK (5/16")
53	10-49956		1	SCREW, DRAIN - OIL PAN
54	27-49955		1	GASKET, OIL PAN DRAIN SCREW

■ = COMPONENT OF ENGINE/POWERHEAD GASKET SET (27-52364A2)

⊕ = WATER PUMP GASKET SET (27-34213A2)

EXHAUST ELBOW ASSEMBLY

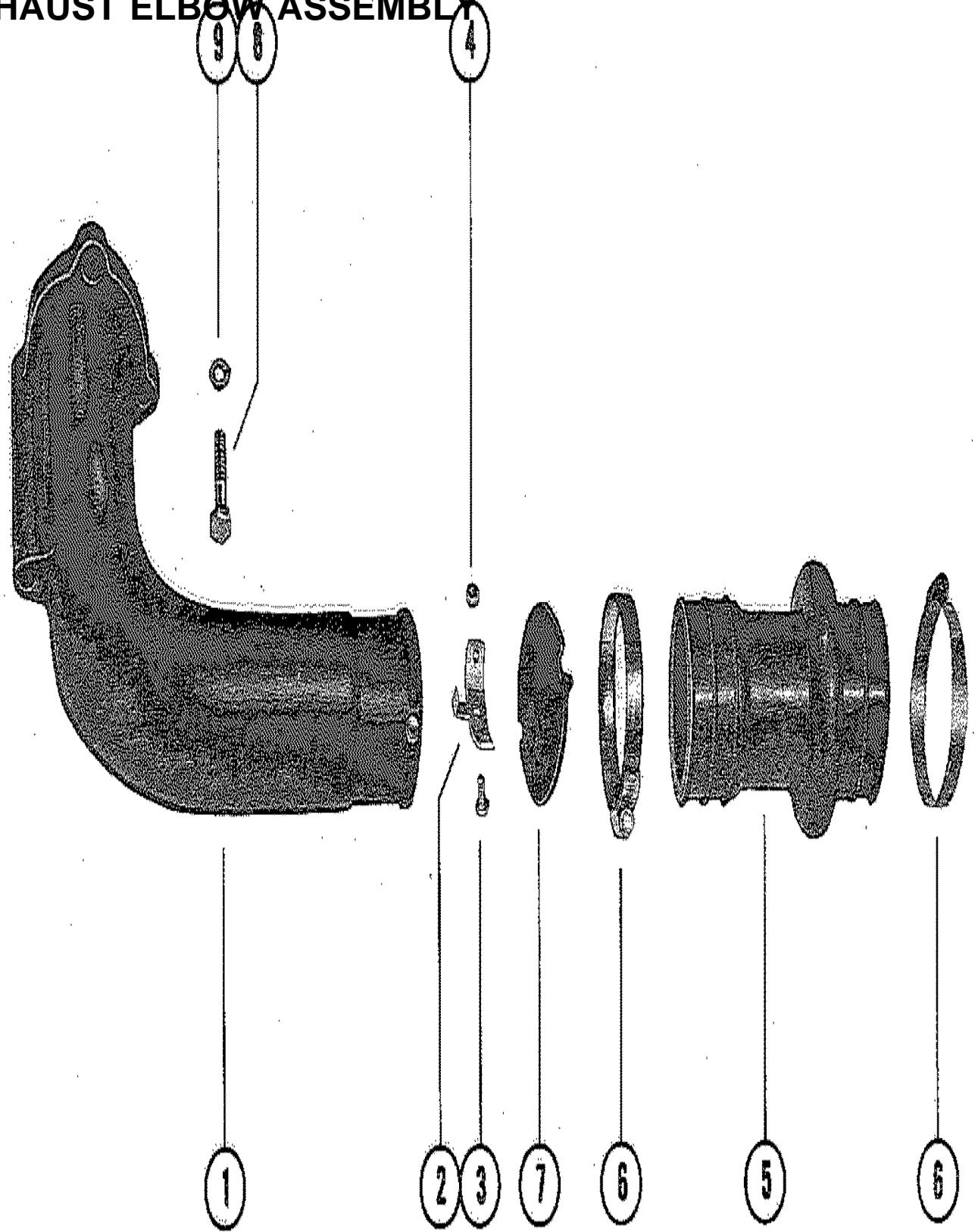

EXHAUST ELBOW ASSEMBLY

REF. NO.	PART NO.	SYM.	QTY.	DESCRIPTION
1	53113A2		1	EHAUST ELBOW ASSEMBLY
2	45798		2	BRACKET, SUPPORT - WATER SEALING
3	10-45813		4	SCREW, SUPPORT BRACKET TO EXHAUST ELBOW (1/2")
4	11-45812		4	NUT, SUPPORT BRACKET SCREW
5	53114		1	EXHAUST ELBOWS, UPPER
6	54-32739		2	CLAMP, BELLOWS ATTACHING
	54-33683		2	CLAMP, BELLOWS ATTACHING
7	45586		1	WATER SHUTTER
8	10-60992		3	SCREW, EXHAUST ELBOW ATTACHING (1 1/4")
9	13-35048		3	LOCKWASHER, EXHAUST ELBOW SCREW

PARTS INDEX

Part Number	Description	Pg.	Ref. No.	Part Number	Description	Pg.	Ref. No.
22789	"C" WASHER, WIRING HARNESS CLAMP	29	14	34623	OIL PRESSURE SENDER ASSEMBLY	5	28
25661	STARTER SOLENIOD ASSEMBLY	5	36	35310	CAP, INTERMEDIATE AND FRONT - CRANKSHAFT BEARING	33	15
26079	PLATE, WIRING HARNESS TO MOUNTING BRACKET	3	5	35862	BLOCK, SPACER - FRONT MOUNTING BRACKET . . .	31	31
26433	COIL, IGNITION	11	31	35864	COVER PLATE, FLYWHEEL HOUSING	29	3
27947	SWIVEL, LINK ROD TO THROTTLE LEVER	15	17	36099A2	BRACKET ASSEMBLY, FRONT MOUNTING	31	28
32193	COIL, IGNITION	13	31	36176A2	BRACKET ASSEMBLY, STARTER SOLENIOD MOUNTING	5	42
32492A5	ENGINE COUPLING ASSEMBLY	35	26	36177	INSULATOR, STARTER SOLENIOD BRACKET . . .	5	41
32720	CONNECTOR, OIL FILTER TO CYLINDER BLOCK . . .	39	43	36405	OIL PUMP ASSEMBLY	39	40
32763A1	WIRE ASSEMBLY, DISTRIBUTOR TO COIL (8 1/4")	11	30	36525	WATER TEMPERATURE SENDER ASSEMBLY	5	35
32778	SUPPORT, FRONT - ENGINE MOUNT	31	46	38559	SWITCH, OIL PRESSURE . .	5	34
32782	RETAINER, HIGH TENSION LEADS	11	29	38979	LEVER, THROTTLE - MOUNTING BRACKET . . .	15	8
32832	MOUNT, FLYWHEEL HOUSING (LEFT)	29	19	38982	LINK ROD, THROTTLE	15	18
32833	MOUNT, FRONT MOUNTING BRACKET	31	30	38983	SWIVEL, LINK ROD TO CARBURETOR	15	22
32849	SUPPORT, FRONT - ENGINE MOUNT	31	47	39332A1	COVER ASSEMBLY, PUSH ROD	39	34
32877	COVER, WATER PUMP SERIAL # THRU	27	47	39593	BATTERY CABLE POSITIVE	3	8
33149	MOUNT, FLYWHEEL HOUSING (RIGHT)	29	19	39594	BATTERY CABLE NEGATIVE	3	8
33321	BRACKET, IGNITION COIL MOUNTING	11	32	39974	CONNECTOR, HARNESS LEADS TO FLYWHEEL HOUSING	29	17
33393	SLEEVE, ADJUSTING - THROTTLE LINK ROD . . .	15	19	39974	CONNECTOR, HARNESS LEADS TO FLYWHEEL HOUSING	29	17
33394	LINK ROD, CARBURETOR . .	15	21	45490	GAUGE ASSEMBLY, OIL LEVEL (DIP STICK)	39	32
33653	FELT, BREAKER CAM LUBRICATOR	11	-	45586	WATER SHUTTER	41	7
33654	BUTTON, CARBON - DISTRIBUTOR CAP	11	21	45798	BRACKET, SUPPORT - WATER SEALING	41	2
33655	PLATE, WEIGHT HOLD DOWN	11	9	45915	TERMINAL BLOCK	31	51
33662	CONDENSER	11	13	46744	LIFTER, HYDRAULIC - TAPPET	35	6
33665	PLATE, MOUNTING - BREAKER ASSEMBLY AND CONDENSER	11	11	47585	FUEL PUMP ASSEMBLY . . .	17	1
33667	CAP, DISTRIBUTOR	11	20	47587A2	BLOCK ASSEMBLY, WATER DISTRIBUTION - CYLINDER HEAD	27	31
33670	RETAINER, BREAKER CAM LUBRICATOR FELT	11	-	47604A1	PROTECTOR, HIGH TENSION LEAD	11	27
33769	WEIGHT, BREAKER CAM ADVANCE	11	7	47957	CONNECTOR, VENT HOSE . .	37	5
33865	WRAP, ENGINE HARNESS . .	5	--	48024	BRACKET, CONDENSER MOUNTING	11	--
34235	BREAKER ASSEMBLY, DISTRIBUTOR	11	14	48025	LEAD, PRIMARY	11	17
34515	CAP, VALVE STEM	37	16	49089	DIAPHRAGM KIT, FUEL PUMP	17	3
34518	SHIELD, VALVE SPRING CAP	37	18	49288	OIL FILLER CAP ASSEMBLY, ROCKER COVER	37	13
34519	ARM, ROCKER VALVE	37	22	49342	BUMPER, MOUNTING BRACKET	5	43
34543	VALVE, BY-PASS - OIL FILTER	33	--				

PARTS INDEX

Part Number	Description	Pg.	Ref. No.	Part Number	Description	Pg.	Ref. No.
52075	BRACKET, THROTTLE RETURN SPRING	15	16	60717	SUPPORT, OIL PUMP	39	--
52124	BRACKET, MOUNTING - THROTTLE LINKAGE	15	1	61800	BRACKET, CIRCUIT BREAKER	3	17
52146	SCREEN ASSEMBLY, OIL PUMP	39	42	61990	STA-STRAP, STARTER SOLENOID LEAD	3	7
52349	PULLEY, WATER PUMP	35	11	62234A2	COVER ASSEMBLY, ROCKER	37	1
52353	WATER PUMP ASSEMBLY	35	7	62264	FLAME ARRESTOR	19	29
52365	VALVE, INLET (STANDARD STEM)	37	29	62420	CLAMP UNIT, DISTRIBUTOR	13	38
52366	VALVE, INLET (.015 O.S. STEM)	37	29	62424	DISTRIBUTOR ASSEMBLY COMPLETE	11	1
52367	VALVE, EXHAUST (STANDARD STEM)	37	30	62426	SCREEN, VENT - DISTRIBUTOR HOUSING	11	2
52368	VALVE, EXHAUST (.015 O.S. STEM)	37	30	62566	BRACKET, CIRCUIT BREAKER	3	17
52390A1	EXHAUST MANIFOLD ASSEMBLY	25	1	63145A1	LINK ROD, CABURETOR	15	21A
52583A1	OIL PAN ASSEMBLY	39	49	63713	LEVER, THROTTLE - MOUNTING BRACKET	15	8
52734	BAIL, FLAME ARRESTOR TO CARBURETOR	19	25	63770	TAB, HARNESS ATTACHING	3	12
53113A2	EHAUST ELBOW ASSEMBLY	41	1	63857A1	BRACKET ASS'Y, ALTERNATOR MOUTING	7	23
53114	EXHAUST ELBOWS, UPPER	41	5	63908A2	BLOCK ASSEMBLY, WATER DISTRIBUTION	27	31
53404	COVERING, CHOKE PIPE	19	34	64804	LINK ROD, THROTTLE	15	18A
54111	OIL FILTER ASSEMBLY	39	44	65059A1	FLYWHEEL HOUSING ASSEMBLY, REAR MOUNTING	29	1
54671	BRACE, STARTER MOTOR	7	4	65142	WATER PUMP ASSEMBLY	35	7
54870	END CAP, EXHAUST MANIFOLD (REAR)	25	18	65406	BRACKET, FUEL LINE TO THERMOSTAT COVER	17	13
55045	BALANCER, HARMONIC	35	23	65411	BRACKET, FUEL LINE TO CRANKCASE COVER	19	20
55898A3	FLYWHEEL HOUSING ASSEMBLY, REAR MOUNTING	29	1	65635	COVER ASSEMBLY, ROCKER	37	1
56778	BRACKET, ALTERNATOR MOUTING	7	23	65970	BRACKET, IGNITION COIL MOUNTING	13	32
57638	BAFFLE, ROCKER COVER	37	7	67850	EYE, LIFTING - CYLINDER BLOCK SERIAL	29	23
58217	ROTOR, DISTRIBUTOR	11	18	69729	ALTERNATOR ASSEMBLY (DELCO REMY #1102496)	7	11
58235	CAM, BREAKER - ADVANCE	11	6	70127	BRACKET, MOUNTING - THROTTLE LINKAGE	15	1
58237	MAIN SHAFT AND WEIGHT PLATE	11	4	71327	FUEL PUMP ASSEMBLY	17	1
58284	ROD, PUSH - VALVE	37	28	72624	CLAMP UNIT, DISTRIBUTOR	13	38
58333	BRACE, ALTERNATOR TO CYLINDER BLOCK (FRONT)	7	12	73571A2	BRACKET ASSEMBLY, FRONT MOUNTING	31	28
59078	THERMOSTAT	27	37	73813A1	END CAP, EXHAUST MANIFOLD (REAR)	25	18
59340	BALL UNIT, ROCKER VALVE ARM STUD	37	21	73999	FLAME ARRESTOR	19	29
59341	COVER ASSEMBLY, CRANKCASE	39	45	76351A1	EXHAUST ELBOW ASSEMBLY	25	22
59755	ALTERNATOR ASSEMBLY (DELCO REMY #1100577)	7	11	77594	FUEL PUMP ASSEMBLY	17	1
59816	CIRCUIT BREAKER	3	15	78403A1	ALTERNATOR ASSEMBLY MOTOROLA #8MR2023F)	7	11
60096	SLEEVE, TERMINAL END COVER	11	--	78890	LEVER, THROTTLE - MOUNTING BRACKET	15	8
60252	END CAP/CONNECTOR, EXHAUST MANIFOLD (FRONT)	25	12	N.S.S.	AIR HORN (ROCHESTER #7041370)	21	1
60372A1	COVER ASSEMBLY, THERMOSTAT - WATER DISTRIBUTION BLOCK	27	39	N.S.S.	ALTITUDE KIT (10,000 FT.)- ROCHESTER #7025962	23	--

PARTS INDEX

Part Number	Description	Pg.	Ref. No.	Part Number	Description	Pg.	Ref. No.
N.S.S.	LEVER ASSEMBLY, CHOKE PISTON (ROCHESTER #7010051)	23	55	10-25038	SCREW, END CAP TO EXHAUST MANIFOLD (7/8")	25	20
N.S.S.	PIN, HINGE - FLOAT TO AIR HORN (ROCHESTER #7002081)	21	11	10-25038	SCREW, END CAP/CONNECTOR TO EXH. MANIFOLD (7/8")-	25	14
N.S.S.	PUMP SHAFT AND LEVER ASSEMBLY, AIR HORN (ROCHESTER #7036764)	21	29	10-25299	SCREW, END CAP TO EXHAUST MANIFOLD (3/4")	25	20
N.S.S.	ROD, CHOKE (ROCHESTER #7025667)	23	47	10-25703	SCREW, WIRING HARNESS HARNESS CLAMP ATTACHING (1/2")	3	10
N.S.S.	ROD, PUMP (ROCHESTER #7036759)	21	30	10-26065	SCREW, WIRING HARNESS CLIP TO COVER PLATE (1")	29	16
N.S.S.	SCREW, VENTURI CLUSTER TO FLOAT BOWL (CENTER)-	21	17	10-26486	SCREW, FRONT MOUNTING BRACKET TO CYLINDER BLOCK (2 3/8")	31	35
N.S.S.	SCREW, VENTURI CLUSTER TO FLOAT BOWL (OUTER) ROCHESTER #700	21	19	10-26632	SCREW, FLYWHEEL HOUSING TO CYLINDER BLOCK (1/4")	29	7
N.S.S.	VENTURI CLUSTER ASSEMBLY, FLOAT BOWL-ROCHESTER #7031949	21	15	10-27165	SCREW, CIRCUIT BREAKER BRACKET TO CYLINDER HEAD (3/4")	3	23
N.S.S.	VENTURI CLUSTER ASSEMBLY, FLOAT BOWL-ROCHESTER #7040911	21	15	10-27165	SCREW, IGNITION COIL TO CYLINDER BLOCK	13	36
10-20055	SCREW, WIRING HARNESS LEAD TO ALTERNATOR (3/8")	3	2	10-27165	SCREW, LIFTING EYE TO CYLINDER BLOCK	29	21
10-20189	SCREW, TERMINAL BLOCK TO FLYWHEEL HOUSING (3/4")	31	52	10-28642	SCREW, DRIVE - SERIAL PLATE TO CYLINDER BLOCK	29	27
10-20362	BOLT, MOUNTING BRACKET TO EXHAUST MANIFOLD (1 1/2")	15	6	10-29179	SCREW, COVER TO CYLINDER BLOCK (1")	39	48
10-21077	SCREW, CIRCUIT BREAKER BRACKET TO CVLINDER HEAD (7/8") SERI	3	23	10-29198	SCREW, ALTERNALTOR BRACE TO ALTERNATOR (7/8")	7	16
10-21077	SCREW, CIRCUIT BREAKER BRACKET TO CYLINDER HEAD (7/8")-SERI	5	23	10-29199	SCREW, BRACKET TO CRANKCASE COVER (1")	19	21
10-21077	SCREW, WATER DISTRIBUTION BLOCK TO CYLINDER HEAD (7/8")	27	35	10-29199	SCREW, FUEL LINE CLIP TO CYLINDER BLOCK (1")	17	9
10-21417A1	SCREW, TIMING GEAR TO CAMSHAFT (1/2")	35	5	10-29240	SCREW, WIRING HARNESS CLAMP FASTENING (5/8")	25	16
10-21625	SCREW, STARTER SOLENOID TO MOUNTING BRACKET (3/4")	5	46	10-29240	SCREW, WIRING HARNESS CLAMP FASTENING (5/8")	25	16
10-22028	SCREW, WIRING HARNESS CLAMP ATTACHING	29	12	10-30663	SCREW, ROTARY TRIM SENDER LEADS	31	54
10-22476	SCREW, FLAME ARRESTOR TO CARBURETOR BAIL (7/8")	19	26	10-32079	SCREW, CLIP TO ROCKER COVER	17	9
10-24234	SCREW, END CAP/CONNECTOR TO EXH. MANIFOLD (1")	25	14	10-32557	SCREW, BRACKET AND SPACER BLOCK TO CYLINDER BLOCK (4 1/2")	31	32
				10-33042	SCREW, FAST IDLE CAM TO FLOAT BOWL	23	46
				10-33043	SCREW, AIR HORN TO FLOAT BOWL (SHORT)	21	3
				10-33045	SCREW, CHOKE VALVE TO CHOKE SHAFT	23	51
				10-33047	SCREW , STAT COVER AND COIL TO CHOKE HOUSING	23	64

PARTS INDEX

Part Number	Description	Pg.	Ref. No.	Part Number	Description	Pg.	Ref. No.
10-33047	SCREW, AIR HORN PUMP LEVER	21	28	10-35585	SCREW, ROCKER COVER TO CYLINDER HEAD (3/4")	37	3
10-33048	SCREW, AIR HORN TO FLOAT BOWL (LONG)	21	4	10-36046	SCREW, WIRING HARNESS LEAD TO CIRCUIT BREAKER	3	16
10-33052	SCREW, THROTTLE BODY TO FLOAT BOWL	23	43	10-37626	SCREW, ALTERNATOR TO BRACKET (4 1/4")	7	18
10-33053	SCREW, CHOKE HOUSING TO AIR HORN	23	54	10-37892	SCREW, CONNECTOR TO FLYWHEEL HOUSING (1")	29	18
10-33056	SCREW, CHOKE PISTON LEVER TO CHOKE HOUSING	23	56	10-38507	SCREW, STEP - THROTTLE LEVER TO MOUNTING BRACKET	15	12
10-33231	SCREW, MOUNTING BRACKET TO MANIFOLD BODY (1/2")	5	44	10-38627	SCREW, ROCKER COVER TO CYLINDER HEAD (5/8")	37	3
10-33231	SCREW, PLUG - EXHAUST MANIFOLD (1/2")	25	7	10-39783	SCREW, PUSH ROD TO CYLINDER BLOCK	39	35
10-33311	SCREW, MOUNTING BRACKET TO COIL (1 1/2")	13	33	10-45488	SCREW, FUEL PUMP TO CYLINDER BLOCK (3/4")	17	5
10-33524	SCREW, CLIP ATTACHING	17	18	10-45813	SCREW, SUPPORT BRACKET TO EXHAUST ELBOW (1/2")	41	3
10-33648	SCREW, MOUNTING PLATE TO PRIMARY HOUSING	11	12	10-46717	BOLT, CRANKSHAFT BEARING CAP TO CYLINDER BLOCK (2 31/32")	33	16
10-33650	SCREW, BREAKER ASSEMBLY TO MOUNTING PLATE	11	15	10-46718	SCREW, WIRING HARNESS PLATE TO MOUNTING BRACKET (3/4")	3	6
10-33660	SCREW, DISTRIBUTOR CAP TO PRIMARY HOUSING (8-32)	11	22	10-47194	SCREW, CLAMP TO BRACKET (9/16")	5	26
10-33663	SCREW, DISTRIBUTOR CAP TO PRIMARY HOUSING (10-32)	11	23	10-47277	SCREW, COVER PLATE TO FLYWHEEL HOUSING (3/4")	29	4
10-33722	SCREW, WEIGHT HOLD DOWN PLATE TO WEIGHT PLATE	11	10	10-47277	SCREW, PULLEY TO WATER PUMP (3/4")	35	12
10-34277	SCREW, COVER TO CYLINDER BLOCK (7/16")	39	48	10-47618	SCREW, CIRCUIT BREAKER TO BRACKET (1")	3	18
10-34277	SCREW, COVER TO CYLINDER BLOCK (7/16")	39	48	10-47618	SCREW, CONNECTOR TO FLYWHEEL HOUSING (1")	29	18
10-34471	SCREW, WATER PUMP TO CYLINDER BLOCK (1 1/2")	35	9	10-48021	SCREW, CONDENSER BRACKET ATTACHING	11	--
10-34500	SCREW, OIL PAN TO CYLINDER BLOCK (5/16")	39	52	10-49950	SCREW, OIL PAN TO CYLINDER BLOCK (1/4")	39	51
10-34505	SCREW, WATER PUMP TO CYLINDER BLOCK (7/8")	35	10	10-49956	SCREW, DRAIN - OIL PAN	39	53
10-34510	BOLT, CYLINDER HEAD TO CYLINDER BLOCK	37	26	10-52143	SCREW, EXHAUST MANIFOLD TO CYLINDER HEAD (4 3/4")	25	8
10-34544	BOLT, STARTER MOTOR MOUNTING (1 15/16")	7	3	10-52269	BOLT, CONNECTING ROD BEARING CAP	35	17
10-34545	BOLT, STARTER MOTOR MOUNTING (4 21/32")	7	2	10-52447	SCREW, BRACKET TO THERMOSTAT COVER (2 1/4")	17	14
10-34613	SCREW, FLYWHEEL HOUSING TO CYLINDER BLOCK (1 3/4")	29	8	10-52447	SCREW, THERMOSTAT COVER ATTACHING (2 1/4")	27	42
10-35169	SCREW, DISTRIBUTOR TO CYLINDER BLOCK	13	39	10-54528	SCREW, LIFTING EYE TO CYLINDER BLOCK	29	24
10-35339	SCREW, OIL PUMP TO CYLINDER BLOCK (3/4")	39	41	10-60374	SCREW, THERMOSTAT COVER ATTACHING (1 3/4")	27	40
10-35366	SCREW, OIL PUMP SCREEN SUPPORT CLAMPING	39	--				

PARTS INDEX

Part Number	Description	Pg.	Ref. No.	Part Number	Description	Pg.	Ref. No.
10-60992	SCREW, EXHAUST ELBOW ATTACHING (1 1/4")	41	8	11-33122	NUT, THROTTLE STOP SCREW	15	1B
10-62568	SCREW, BAFFLE TO ROCKER COVER (3/8")	37	8	11-34516	NUT, ROCKER VALVE ARM STUD	37	20
10-62568	SCREW, WIRING HARNESS CLIP ATTACHED	39	38	11-34933	NUT, FLYWHEEL STUD	35	28
10-64969	SCREW, THROTTLE STOP	15	1A	11-37493	NUT, CONNECTING ROD CAP BOLT	35	18
10-66652	SCREW, MOUNTING BRACKET TO COIL	13	33	11-45812	NUT, SUPPORT BRACKET SCREW	41	4
11-20110	NUT, LINK ROD TO CARBURETOR SWIVEL	15	25	11-46438	NUT, CIRCUIT BREAKER ATTACHING SCREW	3	22
11-20110	NUT, THROTTLE LEVER STUD	15	11	11-46438	NUT, CLAMP ATTACHING SCREW	5	27
11-20220	NUT, FRONT MOUNTING BRACKET ADJUSTING STUD (TOP)	31	44	11-46793	NUT, CLIP ATTACHING SCREW	17	19
11-20586	NUT, FLAME ARRESTOR MOUNTING STUD (TOP)	19	31	11-46793	NUT, COVER PLATE SCREW	29	5
11-20586	NUT, THROTTLE CABLE ANCHOR STUD	15	4	11-47525	NUT, JAM - FRONT MOUNTING BRACKET ADJUSTING STUD (BOTTOM)	31	50
11-20645	NUT, HARNESS TO CIRCUIT BREAKER STUD	3	--	11-49838	NUT, EXHAUST ELBOW TO EXHAUST MANIFOLD STUD	27	28
11-20645	NUT, IGNITION COIL TERMINAL	13	35	11-49838	NUT, EXHAUST MANIFOLD STUD	25	11
11-20645	NUT, STARTE SOLENOID TERMINAL (10-32)	5	40	11-56374	NUT, FUEL LINE TO CRANKCASE COVER SCREW	19	22
11-20645	NUT, STARTER MOTOR TERMINAL (10-32)	7	10	11-64809	NUT, BRACE STUD	7	6
11-20645	NUT, WATER SENDER/OIL PRESSURE SENDER TERMINAL (10-32)	5	30	11-68292	NUT, STARTER SOLENOID TERMINAL (5/16")	5	38
11-20664	NUT, STARTER SOLENIOD SCREW	5	48	11-68531	NUT, ALTERNATOR TERMINAL	7	27
11-20890	NUT, FUEL LINE CLIP SCREW	17	11	12-20533	WASHER, FLAME ARRESTOR SCREW	19	27
11-2161	NUT, MOUNTING BRACKET STUD	7	25	12-20553	WASHER, ALTERNATOR BRACE STUD	7	14
11-21825	NUT, SOLENOID ATTACHING SCREW	9	32	12-20553	WASHER, EXHAUST MANIFOLD SCREW	25	9
11-23161	NUT, ALTERNATOR BRACE STUD	7	15	12-20553	WASHER, IGNITION COIL SCREW	13	37
11-23161	NUT, ALTERNATOR SCREW	7	21	12-20553	WASHER, MOUNTING BRACKERT STUD	7	24
11-25168	NUT, JAM - THROTTLE LINK ROD	15	20	12-20553	WASHER, THROTTLE LEVER STEP SCREW (3/8"O.D.)	15	14
11-26419	NUT, SOLENOID SWITCH TERMINAL (8-32)	7	8	12-20583	WASHER, HARNESS CLIP SCREW	39	39
11-26419	NUT, STARTE MOTOR TERMINAL (8-32)	7	10	12-20583	WASHER, ROCKER COVER SCREW	37	9
11-27164	NUT, TERMINAL BLOCK SCREW	31	53	12-20583	WASTHER, HARNESS TO ROCKER COVER SCREW	3	14
11-28517	NUT, BRACKET AND FLYWHEEL HOUSING SCREW	29	10	12-20959	WASHER, FRONT MOUNTING BRACKET ADJUSTING STUD	31	41
11-28941	NUT, FLAME ARRESTOR SCREW	19	28	12-22248	WASHER, BRACKET AND SPACER BLOCK SCREW	31	34
11-29250	NUT, CARBURETOR MOUNTING STUD	19	39	12-22937	WASHER, FLAME ARRESTOR MOUNTING STUD	19	30
11-32219	NUT, SOLENOID SWITCH TERMINAL (3/9-16)	7	7				

PARTS INDEX

Part Number	Description	Pg.	Ref. No.	Part Number	Description	Pg.	Ref. No.
12-24664	WASHER, THROTTLE CABLE ANCHOR STUD	15	3	13-26995	LOCKWASHER, STARTER MOTOR TERMINAL (#8)	7	9
12-24676	WASHER, WIRING HARNESS CLAMP SCREW	25	17	13-26995	LOCKWASHER, VENTURI CLUSTER SCREW (OUTER)	21	20
12-25970	WASHER, ALTERNATOR TO BRACKET	7	20	13-26996	LOCKWASHER, AIR HORN SCREW	21	5
12-26168	WASHER, ALTERNATOR BRACE SCREW	7	17	13-26996	LOCKWASHER, HARNESS TO CIRCUIT BREAKER STUD	3	--
12-30164	WASHER, IGNITION COIL TERMINAL	13	34	13-26996	LOCKWASHER, IGNITION COIL TERMINAL	13	34
12-30164	WASHER, LINK ROD TO CARBURETOR SWIVEL	15	24	13-26996	LOCKWASHER, STARTER MOTOR TERMINAL (#10)	7	9
12-30164	WASHER, THROTTLE LEVER STUD (3/8" O.D.)	15	10	13-26996	LOCKWASHER, STARTER SOLENOID TERMINAL (#10)	5	39
12-30164	WASHER, WIRING HARNESS LEAD SCREW	3	4	13-26996	LOCKWASHER, WIRING HARNESS CLAMP SCREW	29	13
12-32638	WASHER, FRONT MOUNTING BRACKET ADJUSTING STUD	31	40	13-26996	LOCKWASHER, WIRING HARNESS LEAD SCREW	3	3
12-34931	WASHER, FRONT MOUNTING BRACKET SCREW	31	37	13-26996	WASHER, WATER SENDER/OIL PRESSURE SENDER TERMINAL (#10)	5	29
12-35935	WASHER, FLYWHEEL STUD	35	27	13-32993	LOCKWASHER, BRACKET AND SPACER BLOCK SCREW	31	33
12-35950	WASHER, LINK ROD TO CARBURETOR SWIVEL	15	23	13-33065	LOCKWASHER, FRONT MOUNTING BRACKET STUD (BOTTOM)	31	49
12-35950	WASHER, THROTTLE LEVER AND STUD (7/16" O.D.)	15	9	13-35048	LOCKWASHER, EXHAUST ELBOW SCREW	41	9
12-36103	WASHER, FRONT MOUNTING BRACKET ADJUSTING STUD	31	39	13-35364	LOCKWASHER, LIFTING EYE SCREW	29	25
12-36104	WASHER, RUBBER - FRONT MOUNTING BRACKET ADJUSTING STUD	31	43	13-37459	LOCKWASHER, BRACKET AND FLYWHEEL HOUSING SCREW	29	9
12-36275	WASHER, ROTOR	11	19	13-37459	LOCKWASHER, CIRCUIT BREAKER BRACKET SCREW	5	24
12-36533	WASHER, THERMOSTAT COVER SCREW	27	41	13-37459	LOCKWASHER, EXHAUST ELBOW TO EXHAUST MANIFOLD STUD	27	27
12-47960	WASHER, CIRCUIT BREAKER ATTACHING SCREW	3	19	13-37459	LOCKWASHER, FRONT MOUNTING SCREW	31	36
12-57792	WASHER, THROTTLE LEVER STEP SCREW (21/64" I.D.)	15	13	13-37459	LOCKWASHER, LIFTING EYE SCREW	29	22
12-58220	WASHER, CAM AND SHAFT	11	-	13-39107	LOCKWASHER, WIRING HARNESS CLAMP SCREW	3	11
12-62425	WASHER, BREAKER PLATE SUPPORT SCREW	11	12A	13-39107	LOCKWASHER, MOUNTING BRACKET BOLT	15	7
13-21547	LOCKWASHER, THROTTLE BODY SCREW	23	44	13-39107	LOCKWASHER, PULLEY SCREW	35	13
13-26991	LOCKWASHER, ALTERNATOR TERMINAL	7	26	16-32808	STUD, FLYWHEEL TO ENGINE COUPLING (2 1/16")	35	25
13-26992	LOCKWASHER, SOLENOID ATTACHING SCREW	9	31	16-33111	STUD, CARBURETOR MOUNTING - EXHAUST MANIFOLD (1 9/16")	19	38
13-26992	LOCKWASHER, STARTER SOLENOID SCREW	5	47				
13-26993	LOCKWASHER, BRACKET TO THERMOSTAT COVER SCREW	17	15				
13-26993	LOCKWASHER, MOUNTING BRACKET SCREW	5	45				
13-26993	LOCKWASHER, STARTER SOLENOID TERMINAL (5/16")	5	37				

PARTS INDEX

Part Number	Description	Pg.	Ref. No.	Part Number	Description	Pg.	Ref. No.
16-35422	STUD, VALVE ROCKER ARM (.003 O.S.)	37	24	22-52930	FITTING, TEE - OIL PRESSURE	5	32
16-36100	STUD, ADJUSTING - FRONT MOUNTING BRACKET	31	38	22-53509	ELBOW, WATER DISTRIBUTION BLOCK	27	36
16-38525	STUD, ANCHOR - THROTTLE CABLE TO MOUNTING BRACKET	15	2	22-64294	FITTING, STEEL FUEL LINE	17	7
16-48350	STUD, OIL PUMP SCREEN SUPPORT TO BEARING CAP	33	16	22-64425	FITTING, EXTENSION - CYLINDER BLOCK	33	18
16-49545	STUD, EXHAUST MANIFOLD TO EXHAUST ELBOW (1 3/4")	25	2	22-64426	FITTING, DRAIN - CYLINDER BLOCK	33	19
16-52093	STUD, EXHAUST MANIFOLD TO CYLINDER HEAD (5 1/4")	25	10	22-64698	FITTING, NIPPLE - OIL PRESSURE	5	33
16-52387	STUD, BRACE TO MOTOR AND CYLINDER BLOCK	7	5	22-68307	PLUG, PIPE - EXHAUST ELBOW	25	24
16-54176	STUD, ALTERNATOR BRK. (1 5/8")	7	22	22-68307	PLUG, PIPE - EXHAUST MANIFOLD (1/8-27)	25	3
16-54177	STUD, ALTERNATOR BRACE TO CYLINDER BLOCK (1 3/8")	7	13	22-68307	PLUG, PIPE - WATER DISTRIBUTION BLOCK	27	33
16-56826	STUD, ALTERNATOR BRK. (1 1/2")	7	22	22-68307	PLUG, PIPE - WATER DISTRIBUTION BLOCK	27	33
17-33049	PIN, CHOKE PISTON TO CHOKE PISTON LEVER	23	58	22-68307	PLUG, PIPE - CARBURETOR	19	36
17-33649	PIN, DRIVE GEAR TO MAIN SHAFT	11	5	22-70583	NUT, CHOLE PIPE TO CARBURETOR	19	35
17-35465	PIN, DOWEL - CYLINDER BLOCK TO CYLINDER HEAD	33	6	22-70584	FITTING, STEEL FUEL LINE	17	7
19-33041	WELCH PLUG, CHOKE HOUSING	23	60	22-73817	CPNNECTOR, VENT TO CARBURETOR	17	1A
19-34270	PLUG, EXPANSION - CYLINDER BLOCK (1 5/8" DIA.)	33	2	23-33064	CONNECTOR, VENT TUBE TO FUEL PUMP	17	1B
19-34271	PLUG, EXPANSION - CYLINDER BLOCK (2" DIA.)	33	2	23-34469	SLEEVE, FRONT MOUNTING BRACKET ADJUSTING STUD	31	48
19-34272	PLUG, EXPANSION - CYLINDER HEAD (15/16" DIA.)	37	25	23-35168	BEARING, CAMSHAFT THRUST	35	3
19-34487	PLUG, PIPE - CYLINDER BLOCK (3/8")	33	4	23-35903	BEARING, DISTRIBUTOR PILOT SHAFT	33	7
19-34488	PLUG, EXPANSION - CAMSHAFT BEARING HOLE	33	3	23-36101	SPACER, FRONT MOUNTING BRACKET	31	29
19-37531	PLUG, OIL CHANNEL - CYLINDER BLOCK	33	-	23-36101	SPACER, FRONT MOUNTING BRACKET ADJUSTING STUD	31	42
22-32561	PLUG, PIPE - EXHAUST MANIFOLD (1/4-18)	25	5	23-46742	SPACER, FLYWHEEL HOUSING MOUNT	29	2
22-32803	PLUG, PIPE - WATER DISTRIBUTION BLOCK	27	32	23-52095	SPACER, FUEL LINE SUPPORT BRACKET	17	16
22-32974	ADAPTOR, OIL PRESSURE SENDER TO CYLINDER BLOCK	5	31	23-52221	BEARING(PAIR), CONN. ROD(STANDARD)	35	19
22-33198	PLUG, EXHAUST ELBOW	27	25	23-52222	BEARING(PAIR), CONN. ROD(.001 U.S.)	35	19
22-48118	PLUG, EXHAUST MANIFOLD	25	4	23-52223	BEARING(PAIR), CONN. ROD(.002 U.S.)	35	19
22-49217	FITTING, FUEL LINE	17	7	23-52224	BEARING(PAIR), CONN. ROD(.010 U.S.)	35	19
				23-52225	BEARING(PAIR), CONN. ROD(020 U.S.)	35	19
				23-52256	BEARING UNIT, CRANKSHAFT MAIN (STANDARD)	33	12
				23-52257	BEARING UNIT, CRANKSHAFT MAIN (.001 U.S.)	33	12

PARTS INDEX

Part Number	Description	Pg.	Ref. No.	Part Number	Description	Pg.	Ref. No.
23-52259	BEARING UNIT, CRANKSHAFT MAIN (.010 U.S.)	33	12	27-48043--1	GASKET, END CAP TO EXHAUST MANIFOLD	25	19
23-52260	BEARING UNIT, CRANKSHAFT MAIN (.020 U.S.)	33	12	27-48043--1	GASKET, END CAP/CONNECTOR TO EXHAUST MANIFOLD	25	13
23-52261	BEARING UNIT, CRANKSHAFT MAIN - REAR (STANDARD)	33	13	27-49953	GASKET, CRANKCASE COVER	39	47
23-52262	BEARING UNIT, CRANKSHAFT MAIN - REAR (.001 U.S.)	33	13	27-49955	GASKET, OIL PAN DRAIN SCREW	39	54
23-52263	BEARING UNIT, CRANKSHAFT MAIN - REAR (.002 U.S.)	33	13	27-52144	GASKET SET, OIL PAN	39	50
23-52264	BEARING UNIT, CRANKSHAFT MAIN - REAR (.010 U.S.)	33	13	27-52364	GASKET, CYLINDER HEAD TO CYLINDER BLOCK	37	27
23-52265	BEARING UNIT, CRANKSHAFT MAIN - REAR (.020 U.S.)	33	13	27-53354	GASKET, EXHAUST MANIFOLD TO CYLINDER HEAD	25	21
23-56777	SPACER, ALTERNATOR TO BRACKET	7	19	27-64692	GASKET, CARBURETOR TO EXHAUST MANIFOLD	19	37
23-61998	SPACER, CIRCUIT BREAKER ATTACHING SCREW	3	21	27-73814	GASKET, END CAP TO EXHAUST MANIFOLD	25	19
23-63431	SPACER, CIRCUIT BREAKER ATTACHING SCREW	3	21	27-806452	GASKET, ROCKER COVER TO CYLINDER HEAD	37	14
23-63894	SPACER, ALTERNATOR TO BRACKET	7	19	27-814680	GASKET, WATER DISTRIBUTION BLOCK	27	34
24-33050	SPRING, IDLE ADJUSTING NEEDLE	23	39	27-99777--2	GASKET, EXHAUST ELBOW TO EXHAUST MANIFOLD	27	26
24-35214	SPRING, VALVE	37	19	28-34466	KEY, CAMSHAFT GEAR LOCATING	35	2
24-48143	SPRING, FUEL FILTER	21	8	28-34466	KEY, PULLEY AND GEAR LOCATING	35	21
24-52082	SPRING, THROTTLE RETURN	15	15	28-54797	KEY, VALVE STEM (2 PER VALVE)	37	15
24-58236	SPRING, BREAKER CAM ADVANCE WEIGHT	11	8	32-30466	FUEL LINE, TANK TO FUEL PUMP	17	6
25-33666	GROMMET, MOUNTING PLATE - PRIMARY WIRE	11	16	32-37291	TUBE, OIL LEVEL GAUGE	39	33
25-52188	GROMMET, ROCKER COVER	37	4	32-46471	NOZZLE, OIL - TIMING GEAR	35	14
25-61999	GROMMET, CIRCUIT BREAKER ATTACHING SCREW	3	20	32-47640	HOSE, WATER DISTRIBUTION BLOCK TO WATER PUMP	27	45
26-34217	SEAL, VALVE SPRING CAP	37	17	32-47642	HOSE ASSEMBLY, INLET - WATER DISTRIBUTION BLOCK TO DRIVE UNI	27	29
26-58203	OIL SEAL UNIT, CRANKSHAFT REAR BEARING	33	17	32-52481	HOSE, WATER DISTRIBUTION BLOCK TO END CAP/CONNECTOR	27	43
26-58219	SEAL, HOUSING	11	-	32-53370	TUBE, HEAT - EXHAUST MANIFOLD	25	6
26-59342	OIL SEAL, CRANKCASE COVER	39	46	32-53371	PINE, CHOKE - CARBURETOR	19	33
27-32910	GASKET, CARBURETOR FLANGE	23	42	32-53824	FUEL LINE, FUEL PUMP TO CARBURETOR	17	12
27-33956	GASKET, WATER PUMP	35	8	32-58616A1	TUBE, WATER SEPERATION - EXHAUST ELBOW	25	23
27-34208	GASKET, PUSH ROD COVER	39	36	32-61997	HOSE, VENT-TO ROCKER COVER	19	32
27-34213	GASKET, FUEL PUMP	17	4	32-62060	HOES, VENT - TO ROCKER COVER	19	32A
27-34460	GASKET, OIL PUMP COVER	39	--	32-64296A1	FUEL LINE, FUEL PUMP TO CARBURETOR - STEEL	17	12
27-34486	GASKET, DISTRIBUTOR	11	24	32-65651	FUEL LINE, FUEL PUMP TO CARBURETOR - STEEL	17	12
27-47590	GASKET, THERMOSTAT COVER	27	38				

PARTS INDEX

Part Number	Description	Pg.	Ref. No.	Part Number	Description	Pg.	Ref. No.
32-69145	FUEL LINE, FUEL PUMP TO CARBURETOR - STEEL ..	17	12	54-53883	CLIP, WIRING HARNESS TO PUSH ROD COVER	39	37
32-73815	TUBE, VENT	17	1C	54-54178	CLAMP, WIRING HARNESS TO CVLINDER BLOCK ...	3	9
33-54527	SPARK PLUG (AC#CR 44N) - NON TAPERED	11	28	54-60516	CLAMP, WIRING HARNESS TO EXHAUST MANIFOLD (9/16")	25	15
33-59571	SPARK PLUG (AC#R43T) - TAPERED	11	28	54-60517	CLAMP, WIRING HARNESS TO BRACKET	5	25
35-49088	FILTER, FUEL - FUEL PUMP	17	2	54-60517	CLAMP, WIRING HARNESS TO EXHAUST MANIFOLD (3/8")	25	15
35-53336	FILTER, FUEL INLET	21	7	54-61001	CLIP, FUEL LINE TO FRONT LIFTING EYE	19	23
37-55539	DECAL, ROCKER COVER - "140 H.P."	37	11	54-61001	CLIP, WIRING HARNESS TO FLYWHEEL	29	15
37-55541	DECAL, ROCKER COVER ..	37	2	54-64646	CLIP, FUEL LINE ATTACHING	17	17
37-77247	DECAL, ROCKER COVER ..	37	2A	54-64648	CLAMP, HOSE ATTACHING	19	32B
37-77253	DECAL, WAVES	37	12	54-64648	CLAMP, VENT HOSE TO CONNECTOR	37	6
38-31042	SERIAL PLATE	29	26	54-65653	CLIP, FUEL LINE TO ROCKER COVER	17	8
39-65153	RING, PISTON - 4 SETS (STANDARD)	33	11	54-72531	EYE, LIFTING - FLYWHEEL HOUSING SCREW	29	6
39-66217	RING, PISTON - 4 SETS (.020 O.S.)	33	11	54-73668	"J" CLIP, HARNESS TO FLYWHEEL HOUSING ...	9	33
39-67125	RING, PISTON - 4 SETS (.020 O.S.)	33	11	57-32850	BELT, ALTERNATOR AND WATER PUMP	35	15
43-33664	GEAR, DRIVE - MAIN SHAFT	11	3	57-64032	BELT, ALTERNATOR AND WATER PUMP	35	15
43-46743	GEAR, TIMING - CRANKSHAFT	35	22	84-61975	WIRING HARNESS, EXTERNAL	3	1
43-58283	GEAR, TIMING - CAMSHAFT	35	4	84-63715	WIRING HARNESS, EXTERNAL	3	1
50-59799	STARTER MOTOR ASSEMBLY (DELCO REMY #1108477)	7	1	84-66962A1	WIRING HARNESS, EXTERNAL	3	1
50-69863A1	STARTER MOTOR ASSEMBLY (DELCO REMY #1108756)	7	1	84-67203	WIRE, DISTRIBUTOR TO COIL (12")	13	30
54-24871	CLAMP, WIRING HARNESS TO FLYWHEEL HOUSING	29	11	84-69713--1	LEAD ASSEMBLY, HIGH TENSION - DISTRIBUTOR (6")	11	25
54-28938	CLIP, FUEL LINE TO CYLINDER BLOCK	17	8	84-69713--2	LEAD ASSEMBLY, HIGH TENSION - DISTRIBUTOR (14")	11	26
54-32523	CLAMP, INLET HOSE TO WATER DISTRIBUTION BLOCK AND DRIVE UNIT	27	30	84-78581A3	WIRING HARNESS ASSEMBLY, ALTERNATOR	7	28
54-32739	CLAMP, BELLOWS ATTACHING	41	6	84-79139A5	JOMPER WIRE, 90 AMP FUSE	9	34
54-32780	CLAMP, HOSE TO WATER DISTRIBUTION BLOCK AND END CAP/CONNECTO	27	44	85-79695	BOOT, INSULATOR	7	30
54-32781	CLAMP, HOSE TO WATER DISTRIBUTION BLOCK AND WATER PUMP	27	46	88-65093	CIRCUIT BREAKER	3	15
54-33036	RETAINER, STAT COVER AND COIL TO CHOKE HOUSING SCREW	23	65	88-78813	CIRCUIT BREAKER	3	15
54-33683	CLAMP, BELLOWS ATTACHING	41	6	88-79023A55	FUSE ASS'Y SOLENOID - 55 AMP	7	29
54-34764	EYE, LIFTER - CYLINDER BLOCK	29	20	88-79023A90	FUSE ASS'Y SOLENOID - 90 AMP	7	29
54-38426	CLAMP, WATER PUMP COVER TO WATER PUMP	27	48	89-68258	STARTER SOLENOID	5	36A
54-39108	CLIP, IDLE STOP SCREW ..	23	41	220-2282	FLYWHEEL, CRANKSHAFT .	35	24
54-46721	CLIP, ROCKER COVER SCREW	37	10	423-3816	CRANKSHAFT	35	20
				424-3864	CAMSHAFT	35	1

PARTS INDEX

Part Number	Description	Pg.	Ref. No.	Part Number	Description	Pg.	Ref. No.
613-3817	CONNECTING ROD ASSEMBLY	35	16				
733-3818	PISTON AND PISTON PIN ASSEMBLY (.020 O.S.) . . .	33	10				
733-3819	PISTON AND PISTON PIN ASSEMBLY (STANDARD)	33	10				
839-3814	CYLINDER BLOCK ASSEMBLY	37	31				
839-3814	CYLINDER BLOCK ASSEMBLY (SEE NOTE BELOW)	33	1				
936-5544	CYLINDER HEAD ASSEMBLY	37	23				
1351-4293A1	CARBURETOR ASSEMBLY .	19	24				
1351-4293A1	CARBURETOR ASSEMBLY, COMPLETE	21	-				
1351-5203A1	CARBURETOR ASSEMBLY, COMPLETE	21	-				
1351-5203A1	CARBURETOR ASSEMBLY .	19	24				
1397-2050	PLUG, BALL - CHOKE HOUSING	23	59				
1397-2057	PLATE, BAFFLE - CHOKE HOUSING	23	61				
1397-2059	CHOKE PISTON, CHOKE HOUSING	23	57				
1397-2060	FLOAT ASSEMBLY	21	10				
1397-2071	CAM, FAST IDLE - FLOAT BOWL	23	45				
1397-2447	JET, FLOAT BOWL (STANDARD)	21	26				
1397-2630	CHOKE HOUSING ASSEMBLY	23	52				
1397-2632	CHOKE SHAFT ASSEMBLY .	23	49				
1397-2634	GASKET KIT	23	--				
1397-2637	OVERHAUL KIT	23	--				
1397-2638	IDLE STOP SCREW, THROTTLE BODY	23	40				
1397-2639	THROTTLE BODY ASSEMBLY	23	37				
1397-2648	STAT COVER AND COIL ASSEMBLY	23	63				
1397-2992	ALTITUDE KIT (5,000 FT) . .	23	--				
1397-3330	NUT, FUEL INLET	21	6				
1397-3464	POWER CARBURETOR KIT	23	--				
1397-4257	CHOKE LEVER AND COLLAR ASSEMBLY, CHOKE SHAFT	23	48				
1397-4258	FLOAT BOWL ASSEMBLY . .	21	14				
1397-4337	NUT, FUEL INLET	21	6				
1397-43583	VALVE, CHOKE - CHOKE SHAFT	23	50				